

DOSSERT®

TYPE GPEX

Copper Universal Clamp For Cable

A versatile connector which takes a range of conductor sizes in two positions. Bolt positions held to NEMA standards enabling cable or pipe to be bolted directly to flat bar. Both outside faces machined flat for contact purposes. Used in conjunction with type CF braid straps to make various types of expansion connectors. Unless otherwise specified, bolt length supplied to accommodate one 1/4 inch bar.

Material

Copper Alloy

Hardware

Everdur bolts, nuts and lockwashers

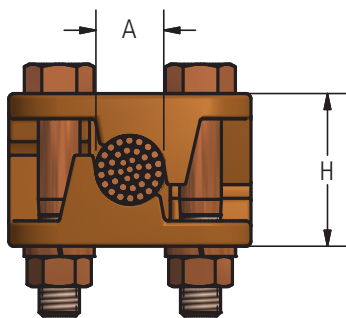
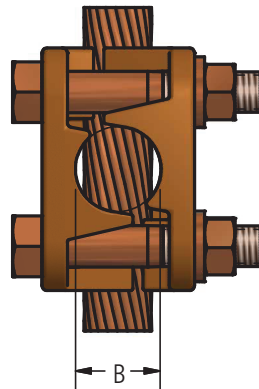
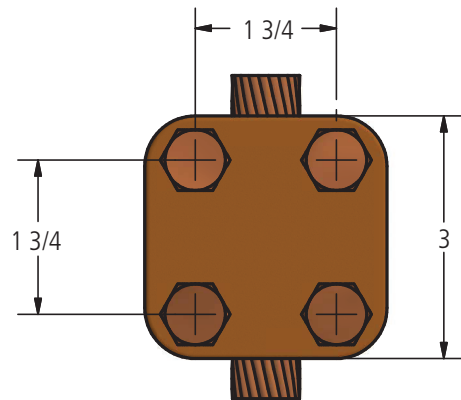
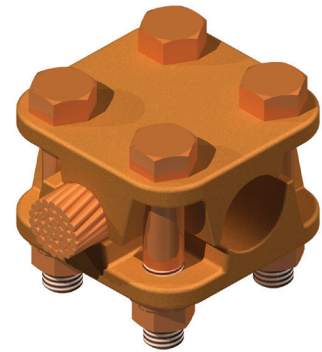

Ordering Information

CATALOG NUMBER	PIPE RANGE (A) SPS	CABLE RANGE A		DIAMETER RANGE A		PIPE RANGE (B) SPS	CABLE RANGE B		DIAMETER RANGE B		DIMENSIONS IN INCHES
		MIN	MAX	MIN	MAX		MIN	MAX	MIN	MAX	
GPEX38-25	1/4	1 Stranded	4/0 Stranded	0.332	0.528	3/8	4/0 Stranded	350 MCM	0.528	0.681	1 3/8
GPEX75-50	1/2	300 MCM	500 MCM	0.630	0.814	3/4	550 MCM	800 MCM	0.855	1.031	1 5/8
GPEX100-75	3/4	550 MCM	800 MCM	0.855	1.031	1	900 MCM	1250 MCM	1.094	1.289	2 1/8

DOSSERT®

TYPE Q2L, Q2L-E

Copper Service Tap Connector For Two Cables To Flat

Double tap lugs series are designed to fit NEMA two hole pads with two 9/16 inch holes on 1 3/4 inch center except the small sizes. Compact construction and two high strength clamp members reduce cantilever distance and increase pull out resistance of conductors.

Material

Copper Alloy

Hardware

Everdur nuts and lockwashers

Note

Type Q2L is for use with 1/4 inch bus bar. Type Q2L-E is for use with 1/2-3/4 inch bus bar.

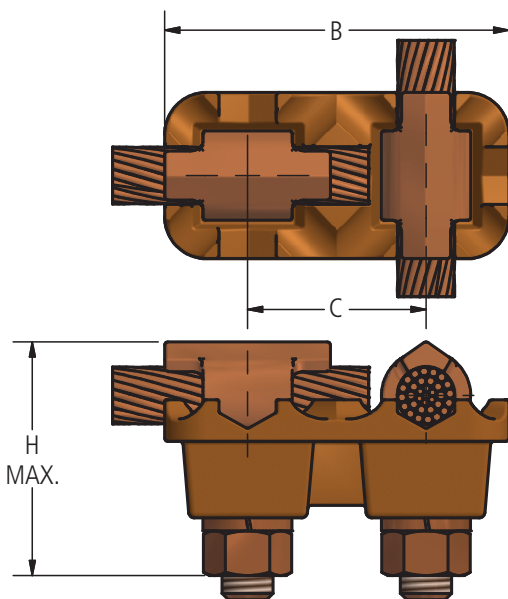
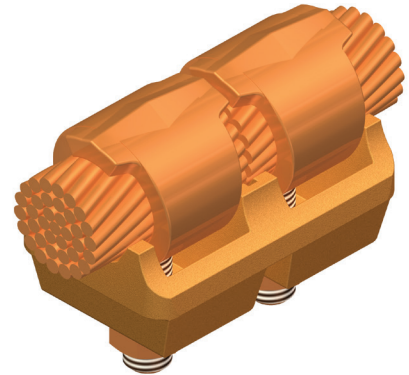

FIG. 1

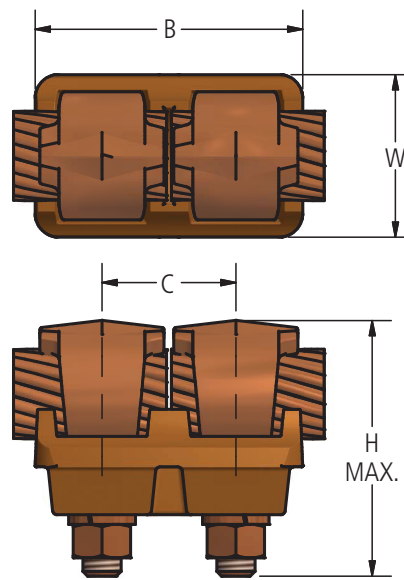

FIG. 2

Ordering Information

CATALOG NUMBER		CABLE RANGE		FIGURE NUMBER	DIMENSIONS IN INCHES				U-BOLT SIZE
		MIN	MAX		B	C	H MAXIMUM	W	
Q2L8	Q2L8E	10 Solid	#1 Stranded	1	2 1/4	1 1/4	1 15/16	1 1/8	3/8
Q2L13	Q2L13E	8 Solid	2/0 Stranded	1	2 3/8	1 1/4	2	1 1/4	3/8
Q2L13-50	Q2L13-50E	8 Solid	2/0 Stranded	1	3 1/8	1 3/4	2 1/4	1 1/2	1/2
Q2L25	Q2L25E	6 Solid	250 MCM	1	3 3/8	1 3/4	2 5/8	1 5/8	1/2
Q2L35	Q2L35E	2 Solid	350 MCM	1	3 1/2	1 3/4	2 3/4	1 3/4	1/2
Q2L50	Q2L50E	1/0 Solid	500 MCM	2	4	1 3/4	3 1/8	1 13/16	1/2
Q2L75	Q2L75E	350 MCM	750 MCM	2	4	1 3/4	3 1/4	1 7/8	1/2
Q2L100	Q2L100E	500 MCM	1000 MCM	2	4	1 3/4	3 3/8	2 1/8	1/2

DOSSERT®

TYPE QL, QL-E

Service Tap Connector For Cable To Flat Bus Bar

A versatile service tap connector which takes a wide range of cable sizes. Used for mounting on switch pads, current transformer terminals, and miscellaneous flat bus conductors. The single hole mounting enables the plane of the flat bus.

Material

Copper Alloy

Hardware

Everdur nuts and lockwashers

Notes

- QL is for use with 1/4 inch bus bar. Type QL-E is for use with 1/2-3/4 inch bus bar.
- For Stainless Steel Hardware, add "-SS" to catalog number. EX: QL25-SS

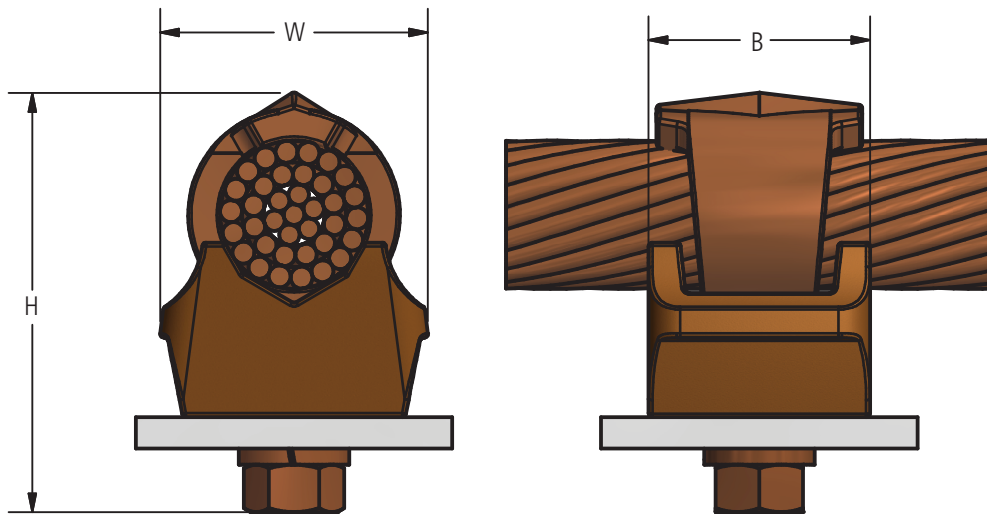
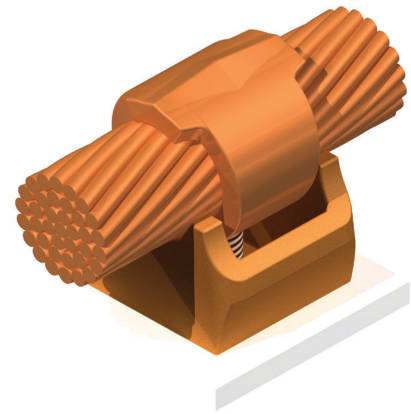

Ordering Information

CATALOG NUMBER		CABLE RANGE		DIMENSIONS IN INCHES			U-BOLT SIZE
1/4" BAR	3/4" BAR	MIN	MAX	B	H MAX	W	
QL8	QL8E	10 Solid	#1 Stranded	1 1/16	1 15/16	7/8	3/8
QL13	QL13E	8 Solid	2/0 Stranded	1 1/4	2	1 1/16	3/8
QL13-50	QL13-50E	8 Solid	2/0 Stranded	1 1/4	2 1/4	1 1/16	1/2
QL25	QL25E	6 Solid	250 MCM	1 5/8	2 5/8	1 5/16	1/2
QL35	QL35E	2 Solid	350 MCM	1 11/16	2 3/4	1 3/8	1/2
QL50	QL50E	1/0 Solid	500 MCM	2 3/16	3 1/8	1 3/4	1/2
QL75	QL75E	350 MCM	750 MCM	2 1/4	3 1/4	1 7/8	1/2
QL100	QL100E	500 MCM	1000 MCM	2 1/4	3 3/8	2 1/16	1/2

DOSSERT®

TYPE TL, TL-E, T2L, T2L-E

Copper Low Mount Tap Lug For Cable To Flat Bar

A low mount tap lug for cable to bar connections. Finds wide application on current transformers and tap connections for metering equipment. See Type T2L for double tap design. Type T2L is designed to meet NEMA pad drilling and all sizes can mount side by side without interference.

Material

Copper Alloy

Eyebolt- Aluminum Bronze

Hardware

Nut and lock washers-Everdur.

Note

- Type TL is for use with 1/4 inch bar. Type TL-E is use with 1/2 - 3/4 inch bar.
- For Double Tap lug change TL to T2L.
- For Silver palated finish add suffix (AG) to catalog number Ex: TL13-AG

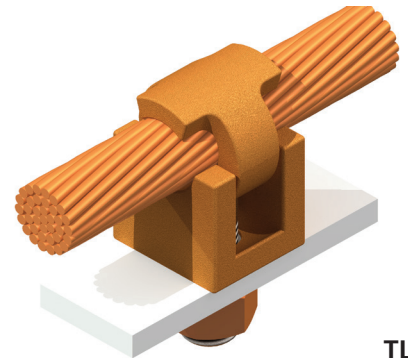

TL

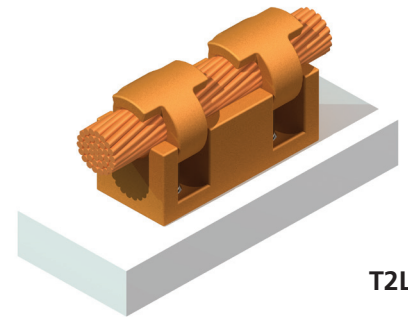

T2L

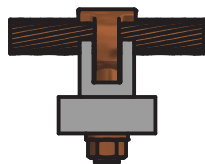

TL AND TL-E

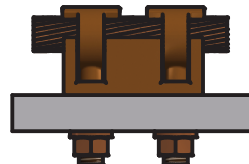

T2L AND T2L-E

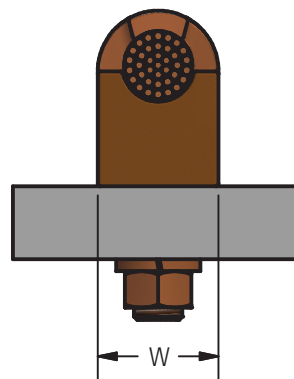
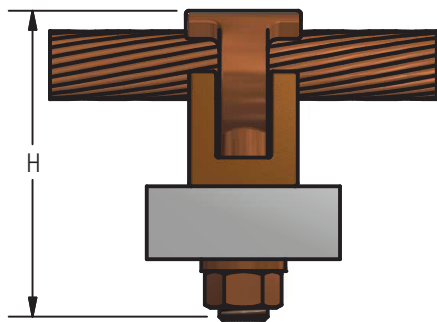

Ordering Information

FOR BAR THICKNESS				CABLE RANGE		DIMENSIONS IN INCHES COMMON TO BOTH 1/4 AND 3/4 TYPES		
1/4"		3/4"						
CATALOG NUMBER	H	CATALOG NUMBER	H	MIN	MAX	B	W	BOLT SIZE
TL6	1 3/4	TL6E	2 1/4	10 Solid	#2 Str	13/16	3/4	3/8
TL13	2 3/16	TL13E	2 11/16	8 Solid	2/0 Str	1	1	1/2
TL25	2 7/16	TL25E	2 15/16	6 Solid	250 MCM	1	1	1/2
TL35	2 11/16	TL35E	3 3/16	2 Solid	350 MCM	1 1/8	1 1/4	1/2
TL50	2 7/8	TL50E	3 3/8	#1/0 Solid	500 MCM	1 5/16	1 5/16	1/2
TL75	2 13/16	TL75E	3 5/16	350 MCM	750 MCM	1 3/8	1 1/2	1/2
TL100	3 1/4	TL100E	3 3/4	500 MCM	1000 MCM	1 1/2	1 11/16	1/2

DOSSERT®

TYPE UM

Copper U-Bolt Variable Range Terminal

A U-bolt variable terminal lug for connecting cables to flat bar buses.

Material

Copper Alloy

Hardware

Everdur U-bolts, nuts and lockwashers

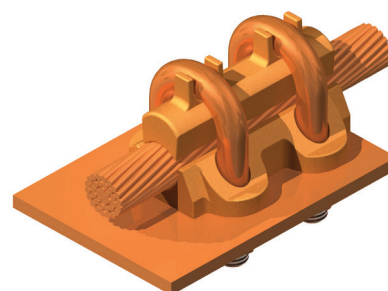

CUSTOMER BUS

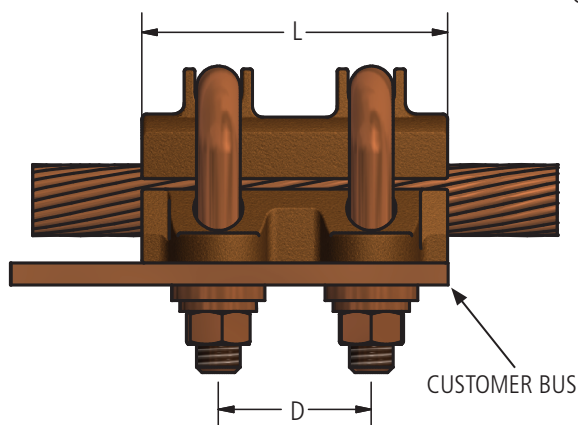
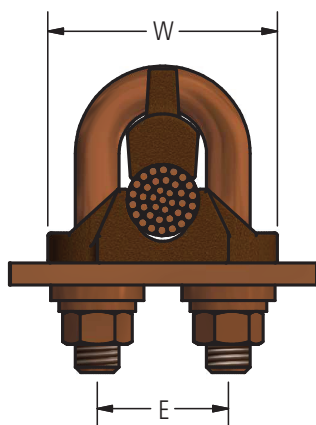

CUSTOMER BUS

Ordering Information

CATALOG NUMBER	CABLE RANGE		DIMENSIONS IN INCHES				
	MIN	MAX	D	E	L	W	U-BOLT SIZE
UM13	#6	2/0 STR	1 1/4	13/16	2 1/2	1 3/16	5/16
UM21	#1	4/0 STR	1 1/4	31/32	2 5/8	1 7/8	3/8
UM30	1/0 STR	300 MCM	1 1/2	1 1/16	2 3/4	1 15/16	3/8
UM50	300 MCM	500 MCM	2 1/8	1 3/8	4 1/4	2 1/2	1/2
UM80	500 MCM	800 MCM	1 3/4	1 19/32	3 1/4	2 13/16	1/2
UM100	750 MCM	1000 MCM	1 13/16	1 23/32	3 1/2	2 15/16	1/2
UM150	1000 MCM	1500 MCM	2	2	4	3 3/16	1/2
UM200	1500 MCM	2000 MCM	2	2 1/4	4 1/2	3 3/8	1/2