

Type 5000 Series

The 5000 Series Jumper Connector is designed for AAC conductors. The jumper connector is fabricated from AFL seamless drawn aluminum. All jumper connectors are designed for limited tension use, maintaining a minimum of 40% of the ASTM rated strength of the conductor on which it is being used.

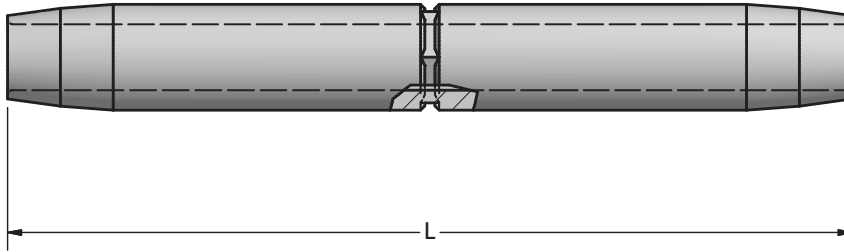

Ordering Information

Catalog Number	Conductor					Die Size Aluminum Hex Die	Dimensions in inches
	ACSR or AAC	Code Word	Size KCMil	Stranding Al/St	Diameter in inches		L
5073.391	AAC	Poppy	1/0	7	0.368	73AH	6.00
5074.438	ACSR	Raven	1/0	6/1	0.398	74AHA	7.00
5074.438	AAC	Aster	2/0	7	0.414	74AHA	7.00
5074.484	ACSR	Quail	2/0	6/1	0.447	74AH	7.00
5074.484	ACSR	Phlox	3/0	7	0.464	74AH	7.00
5075.547	ACSR	Pigeon	3/0	6/1	0.502	75AH	8.00
5075.547	AAC	Oxlip	4/0	7	0.522	75AH	8.00
5075.609	ACSR	Penguin	4/0	6/1	0.563	75AH	8.00
5075.609	AAC	Valerian	250	19	0.575	75AH	8.00
5075.609	AAC	Laurel	266.8	19	0.593	75AH	8.00
5076.650	ACSR	Waxwing	266.8	18/1	0.609	76AH	9.00
5076.650	AAC	Peony	300	19	0.629	76AH	9.00
5076.688	ACSR	Owl	266.8	6/7	0.633	76AH	9.00
5076.688	ACSR	Partridge	266.8	26/7	0.642	76AH	9.00
5076.688	AAC	Tulip	336.4	19	0.666	76AH	9.00
5076.719	ACSR	Ostrich	300	26/7	0.680	76AH	9.00
5076.719	ACSR	Merlin	336.4	18/1	0.684	76AH	9.00
5076.750	AAC	Canna	397.5	19	0.724	76AH	9.00
5076.781	ACSR	Linnet	336.4	26/7	0.720	76AH	9.00
5076.781	ACSR	Chickadee	397.5	18/1	0.743	76AH	9.00
5020.719	AAC	Daffodil	350	19	0.679	20AH	10.00
5020.781	ACSR	Linnet	336.4	26/7	0.720	20AH	10.00
5020.781	ACSR	Oriole	336.4	30/7	0.741	20AH	10.00
5020.781	ACSR	Chickadee	397.5	18/1	0.743	20AH	10.00
5020.812	ACSR	Brant	397.5	24/7	0.772	20AH	10.00
5020.812	AAC	Goldentuft	450	19	0.770	20AH	10.00
5020.812	AAC	Yarrow	450	37	0.772	20AH	10.00
5020.812	AAC	Cosmos	477	19	0.793	20AH	10.00
5020.812	AAC	Syringa	477	37	0.795	20AH	10.00

Type 5000 Series

Ordering Information

Catalog Number	Conductor					Die Size Aluminum Hex Die	Dimensions in inches
	ACSR or AAC	Code Word	Size KCMil	Stranding Al/St	Diameter in inches		L
5020.844	ACSR	Ibis	397.5	26/7	0.783	20AH	10.00
5020.844	ACSR	Lark	397.5	30/7	0.806	20AH	10.00
5024.875	ACSR	Pelican	477	18/1	0.814	24AH	11.00
5024.875	AAC	Cosmos	477	19	0.793	24AH	11.00
5024.875	AAC	Syringa	477	37	0.795	24AH	11.00
5024.875	AAC	Zinnia	500	19	0.811	24AH	11.00
5024.875	AAC	Hyacinth	500	37	0.813	24AH	11.00
5024.938	ACSR	Flicker	477	24/7	0.846	24AH	11.00
5024.938	ACSR	Hawk	477	26/7	0.858	24AH	11.00
5024.938	ACSR	Hen	477	30/7	0.883	24AH	11.00
5024.938	ACSR	Osprey	556.5	18/1	0.879	24AH	11.00
5024.938	AAC	Dahlia	556.5	19	0.856	24AH	11.00
5024.938	AAC	Mistletoe	556.5	37	0.858	24AH	11.00
5024.938	AAC	Meadowsweet	600	37	0.891	24AH	11.00
5024.969	ACSR	Parakeet	556.5	24/7	0.914	24AH	11.00
5024.969	ACSR	Dove	556.5	26/7	0.927	24AH	11.00
5024.969	AAC	Orchid	636	37	0.918	24AH	11.00
5024.969	AAC	Heuchera	650	37	0.928	24AH	11.00
5027.100	ACSR	Eagle	556.5	30/7	0.953	27AH	12.00
5027.100	ACSR	Peacock	605	24/7	0.953	24AH	12.00
5027.100	ACSR	Squab	605	26/7	0.966	24AH	12.00
5027.100	ACSR	Swift	636	36/1	0.930	24AH	12.00
5027.100	ACSR	Kingbird	636	18/1	0.940	24AH	12.00
5027.100	AAC	Flag	700	61	0.964	24AH	12.00
5027.106	ACSR	Teal	605	30/19	0.994	27AH	12.00
5027.106	ACSR	Rook	636	24/7	0.977	27AH	12.00
5027.106	ACSR	Grosbeak	636	26/7	0.990	27AH	12.00
5027.106	ACSR	Egret	636	30/19	1.019	27AH	12.00
5027.106	ACSR	Flamingo	666.6	24/7	1.000	27AH	12.00
5027.106	AAC	Violet	715.5	37	0.974	27AH	12.00
5027.106	AAC	Nasturtium	715.5	61	0.975	27AH	12.00
5027.106	AAC	Petunia	750	37	0.997	27AH	12.00
5027.106	AAC	Cattail	750	61	0.998	27AH	12.00
5030.109	ACSR	Stilt	715.5	24/7	1.036	30AH	13.00
5030.109	ACSR	Starling	715.5	26/7	1.051	30AH	13.00
5030.109	ACSR	Coot	795	36/1	1.040	30AH	13.00
5030.109	AAC	Arbutus	795	37	1.026	30AH	13.00
5030.109	AAC	Lilac	795	61	1.028	30AH	13.00
5030.109	AAC	—	800	37	1.031	30AH	13.00
5030.109	AAC	Heliotrope	800	61	1.031	30AH	13.00
5030.116	ACSR	Redwing	715.5	30/19	1.081	30AH	13.00
5030.116	ACSR	Tern	795	45/7	1.063	30AH	13.00
5030.116	ACSR	Condor	795	54/7	1.093	30AH	13.00
5030.116	ACSR	Drake	795	26/7	1.108	30AH	13.00
5030.116	ACSR	Cuckoo	795	24/7	1.092	30AH	13.00
5030.116	AAC	Snapdragon	900	61	1.094	30AH	13.00
5030.122	ACSR	Mallard	795	30/19	1.140	30AH	13.00
5030.122	ACSR	Ruddy	900	45/7	1.131	30AH	13.00
5030.122	ACSR	Canary	900	54/7	1.162	30AH	13.00
5030.122	ACSR	Catbird	954	36/1	1.140	30AH	13.00
5030.122	ACSR	Rail	954	45/7	1.165	30AH	13.00
5030.122	AAC	Magnolia	954	37	1.124	30AH	13.00

Type 5000 Series

Ordering Information

Catalog Number	Conductor					Die Size Aluminum Hex Die	Dimensions in inches
	ACSR or AAC	Code Word	Size KCMil	Stranding Al/St	Diameter in inches		L
5030.122	AAC	Goldenrod	954	61	1.126	30AH	13.00
5030.122	AAC	Camellia	1000	61	1.152	30AH	13.00
5030.122	AAC	Bluebell	1033.5	37	1.170	30AH	13.00
5030.122	AAC	Larkspur	1033.5	61	1.172	30AH	13.00
5030.125	ACSR	Cardinal	954	54/7	1.196	30AH	13.00
5030.125	ACSR	Tanager	1033.5	36/1	1.186	30AH	13.00
5034.128	ACSR	Ortolan	1033.5	45/7	1.212	34AH	14.00
5034.128	AAC	Marigold	1113	61	1.216	34AH	14.00
5034.134	ACSR	Curlew	1033.5	54/7	1.244	34AH	14.00
5034.134	ACSR	Bluejay	1113	45/7	1.259	34AH	14.00
5034.134	AAC	Hawthorn	1192.5	61	1.258	34AH	14.00
5034.134	AAC	Narcissus	1272	61	1.300	34AH	14.00
5034.138	ACSR	Bunting	1192.5	45/7	1.302	34AH	14.00
5034.138	ACSR	Finch	1113	54/19	1.293	34AH	14.00
5036.144	ACSR	Bittern	1272	45/7	1.345	36AH	15.00
5036.144	ACSR	Grackle	1192.5	54/19	1.333	36AH	15.00
5036.144	AAC	Columbine	1351	61	1.340	36AH	15.00
5036.144	AAC	Carnation	1431	61	1.379	36AH	15.00
5036.147	ACSR	Pheasant	1272	54/19	1.382	36AH	15.00
5036.147	ACSR	Dipper	1351.5	45/7	1.386	36AH	15.00
5036.147	ACSR	—	1500	91	1.412	36AH	15.00
5036.147	AAC	Gladiolus	1510.5	61	1.187	36AH	15.00
5038.150	ACSR	Martin	1351.5	54/19	1.424	38AH	16.00
5038.150	ACSR	Bobolink	1431	45/7	1.427	38AH	16.00
5038.156	ACSR	Plover	1431	54/19	1.465	38AH	16.00
5038.156	ACSR	Nuthatch	1510.5	45/7	1.466	38AH	16.00
5038.156	AAC	Coreopsis	1590	61	1.250	38AH	16.00
5038.156	AAC	Dogwood	1590	91	1.454	38AH	16.00
5040.162	ACSR	Parrot	1510.5	54/19	1.506	40AH	17.00
5040.162	ACSR	Lapwing	1590	45/7	1.504	40AH	17.00
5040.162	ACSR	Falcon	1590	54/19	1.545	40AH	17.00
5040.162	AAC	Jessamine	1750	61	1.525	40AH	17.00
5042.178	ACSR	Chukar	1780	84/19	1.602	42AH	17.00
5042.178	ACSR	—	2034	72/7	1.681	42AH	17.00
5042.178	AAC	Cowslip	2000	91	1.630	42AH	17.00
5044.181	ACSR	Kiwi	2167	72/7	1.737	44AH	17.00
5044.181	AAC	Sagebrush	2250	91	1.729	44AH	17.00
5044.181	AAC	—	2300	61	1.750	44AH	17.00
5044.181	AAC	—	2300	91	1.750	44AH	17.00
5044.184	ACSR	Bluebird	2156	84/19	1.762	44AH	17.00
5044.188	ACSR	Thrasher	2312	76/19	1.802	44AH	17.00
5044.188	AAC	Lupine	2500	91	1.823	44AH	17.00
5048.197	ACSR	Joree	2515	76/19	1.880	48AH	19.00
5048.197	AAC	Bitterroot	2750	91	1.912	48AH	19.00