

DOSSERT® TYPE B6998 Series

Bolted Support, Slip or Fixed Fit
Recommended for Voltages Up to 765 kV

Support is designed to be corona free for 765 kV operation. Support can be supplied for fixed fit or slip fit applications. For slip fit application, stainless steel chatter springs are supplied. Aluminum mounting hardware is supplied as standard; galvanized steel can be furnished on request.

Material

Aluminum Alloy

Hardware

Yellow anodized aluminum bolts, nuts, and lockwashers.
Galvanized steel mounting hardware included.

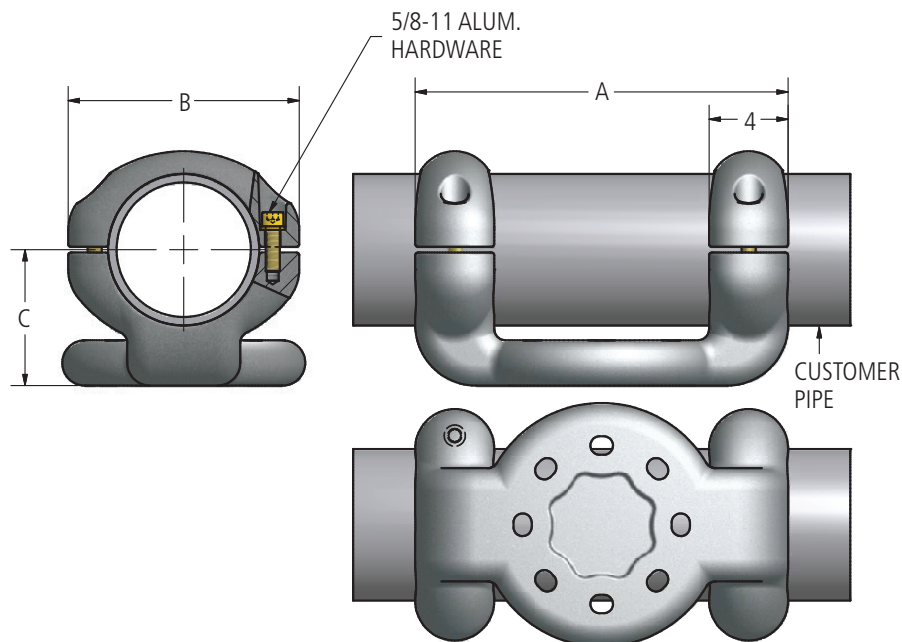

Ordering Information

CATALOG NUMBERS	CONDUCTOR SIZE TUBULAR BUS SPS & EHPS	SLIP OR FIXED	BOLT CIRCLE	DIMENSIONS IN INCHES			NOMINAL WEIGHT LBS
				A	B	C	
B6998-A	6"	Fixed	7"	16.28	10.55	5.50	27.0
B6998-B	6"	Slip	7"	16.28	10.55	5.50	27.6
B6998-C	5"	Fixed	7"	16.50	9.62	5.00	25.0
B6998-D	5"	Slip	7"	16.50	9.62	5.00	25.6
B6998-E	8" O.D.	Fixed	7"	16.50	12.06	5.75	30.0
B6998-F	8" O.D.	Slip	7"	16.50	12.06	5.75	30.6
B6998-G	6"	Fixed	5"	14.50	10.55	5.50	26.5
B6998-H	6"	Slip	5"	14.50	10.55	5.50	27.7
B6998-K	6"	Fixed	3"	12.25	10.55	5.50	24.3

DOSSERT[®] TYPE B7107 Series

Welded Support, Expansion Type Recommended for Voltages Up to 765 kV

Expansion support is designed to be corona free for 765 KV operation. Expansion support is designed for maximum bus run of 150 feet (46 m) operating between a minimum temperature of -20°F (-28.9°C) and a maximum temperature of 200°F (93.3°C). Assembly consists of support, expansion straps, corona rings and hardware. Stainless steel chatter springs are supplied with corona ring and support assembly. Aluminum mounting hardware is supplied as standard, galvanized steel can be furnished on request. Weldment end plugs can be furnished if required.

Material

Aluminum Alloy

Hardware

Yellow anodized aluminum bolts, nuts, and lockwashers.
Galvanized steel mounting hardware included.

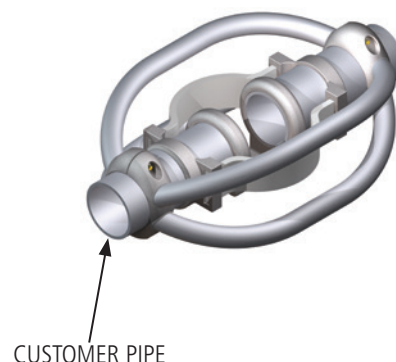

CUSTOMER PIPE

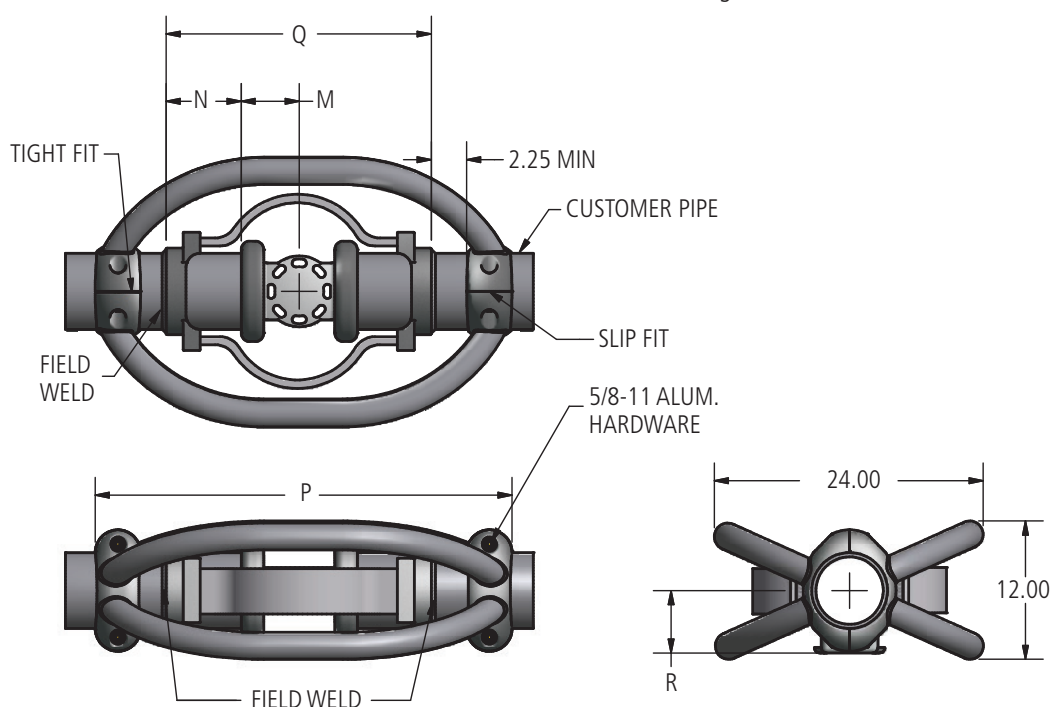

Ordering Information

CATALOG NUMBERS	CONDUCTOR SIZE TUBULAR BUS SPS & EHPS	BOLT CIRCLE	DIMENSIONS IN INCHES					NOMINAL WEIGHT LBS
			M	N	P	Q	R	
B7107-A	6"	7"	5.25	4.81	36.75	23.38	5.50	66.6
B7107-B	6"	5"	4.12	5.94	36.75	23.38	5.50	64.3
B7107-C	5"	7"	6.38	4.00	37.34	20.75	5.00	45.4

DOSSERT® TYPE B7582-A Series

Tee Connector, Bolted, Welded Expansion Type Recommended for Voltages Up to 765 kV

Expansion tee is designed to be corona free for 765 kV operation. Expansion tee is designed for maximum bus run of 150 feet (46M) operating between a minimum temperature of -20°F (-28.9°C) and maximum temperature of 200°F (93.3°C). Assembly consists of weld tee, guide insert, expansion straps, corona rings and hardware. Stainless steel chatter springs are supplied with corona ring assembly.

Material

Aluminum Alloy

Hardware

Yellow anodized aluminum bolts, nuts, washers, lockwashers.

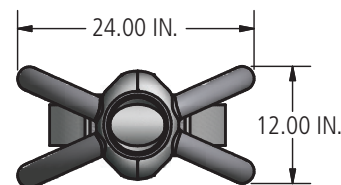
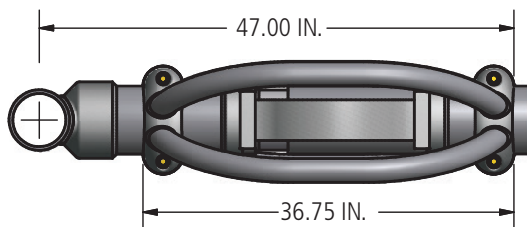
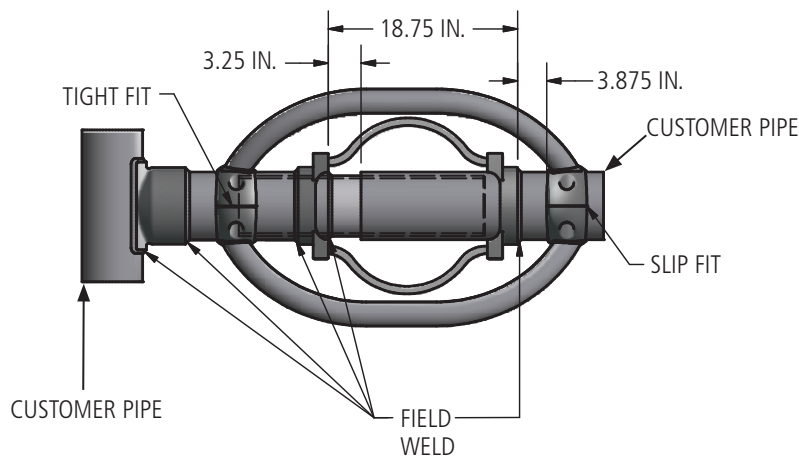
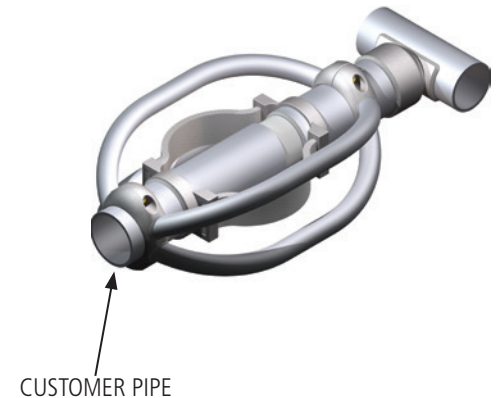

Ordering Information

CATALOG NUMBERS	CONDUCTOR SIZE TUBULAR BUS		NOMINAL WEIGHT LBS
	RUN	TAP	
B7582-A	5"	6"	74.9
	6"	6"	74.9

DOSSERT® TYPE C7009 Series

Bi-Spacer Support for Strained Conductor Recommended for Voltages Up to 765 kV

Support is designed to be corona free for 765 KV operation. Aluminum insulator mounting hardware is supplied as standard; galvanized steel hardware can be furnished on request.

Material

Aluminum Alloy

Hardware

Yellow anodized aluminum bolts, nuts, and lockwashers.
Galvanized steel mounting hardware included.

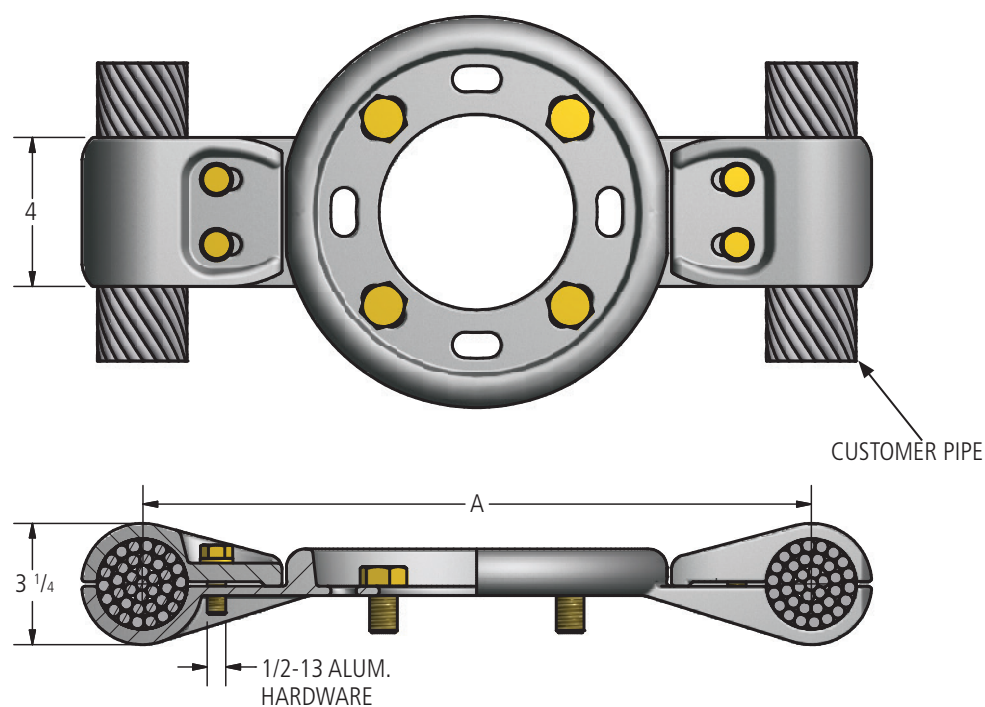

Ordering Information

CATALOG NUMBERS	DIMENSIONS IN INCHES			NOMINAL WEIGHT LBS
	CONDUCTOR SIZE	BOLT CIRCLE	A	
	O.D.			
C7009-A	2.4	7"	18.00	11.4
C7009-B	2.311	7"	17.75	11.4
C7009-C	2.4	5"	18.00	11.4