

# DOSSERT®

## Type LLA-2P1 Limiter Terminal Insulating Sleeve for Use with Types LLA-2R123, LLA-2P123, and LLA-2PL123

A MYPAR molded insulating sleeve for use with limiter terminal assemblies. Designed to provide a close fit over shell type LLA-2P2 and specified cable insulation. Its use simplifies taping and improves the accessibility to and easy replacement of a blown limiter.

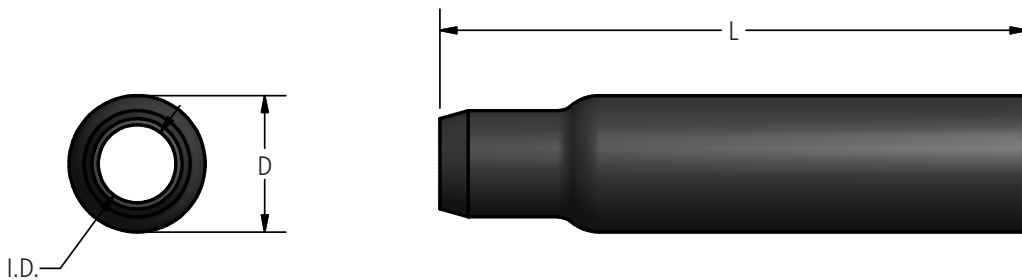

### Ordering Information

CATALOG NUMBER	CABLE RANGE	DIMENSIONS IN INCHES		
		D	L	I.D.
LLA25-2P1	4/0 STR - 250 MCM	2	9	*
LLA75-2P1	300 MCM - 500 MCM	2 7/16	10 1/2	*

\* Diameter over cable insulation to be specified on order.