

OPGW Single Suspension Steel Pole/Drilled Configuration Assembly

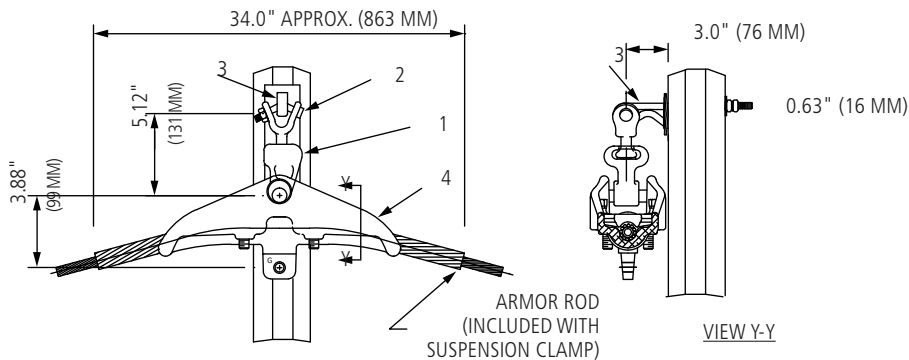

AFL NO.

OSPSP1

Assembly Code

XXX/XXX

SUME Range Code

Bill of Material

| Item | Description | Material | AFL or Dwg. No. | Req'd | Remarks |
|------|--------------------------------------|------------------|-----------------|-------|---------------------------------|
| 1 | Socket Eye | Galvanized Steel | SE-SC | 1 | |
| 2 | Y-Clevis Ball | Galvanized Steel | YCBS | 1 | Pin Dia. = 0.75" (19 mm) |
| 3 | Shield Wire Support Bracket | Galvanized Steel | SFOSB-WP-14 | 1 | 14" Bolt, 0.63" (16 mm) Dia. |
| 4 | Suspension Clamp Assembly (Included) | Aluminum | SUME XXX/XXX | 1 | |

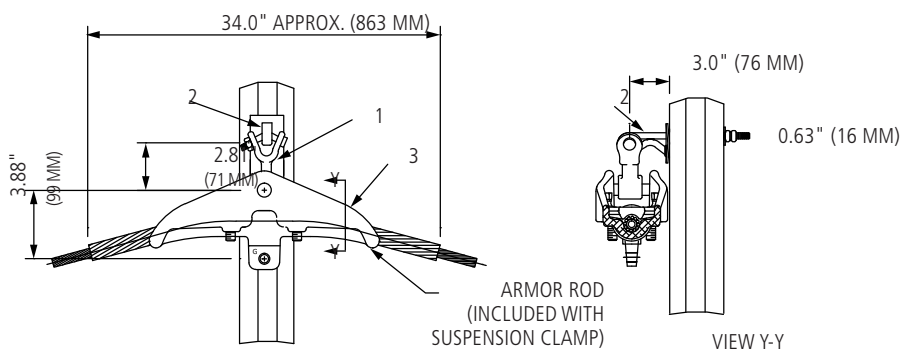

AFL NO.

OSPSP2

Assembly Code

XXX/XXX

SUME Range Code

Bill of Material

| Item | Description | Material | AFL or Dwg. No. | Req'd | Remarks |
|------|--------------------------------------|------------------|-----------------|-------|---------------------------------|
| 1 | Y-Clevis Eye 90° | Galvanized Steel | YC90E-750-1750 | 1 | Pin Dia. = 0.75" (19 mm) |
| 2 | Shield Wire Support Bracket | Galvanized Steel | SFOSB-WP-14 | 1 | 14" Bolt, 0.63" (16 mm) Dia. |
| 3 | Suspension Clamp Assembly (Included) | Aluminum | SUME XXX/XXX | 1 | |

continued
→

OPGW Single Suspension Steel Pole/Vang Configuration Assemblies

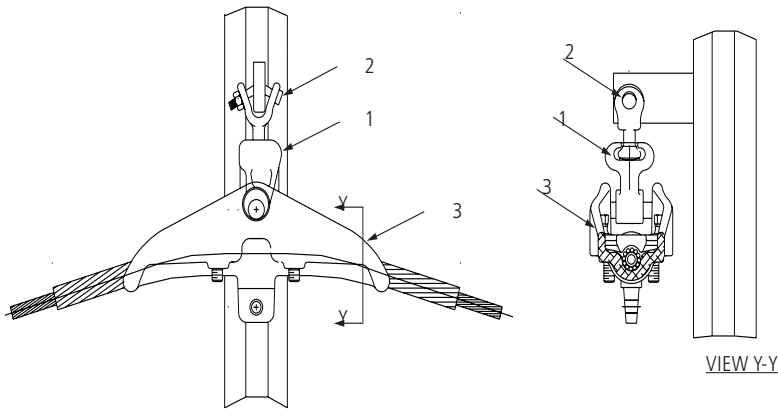

AFL NO.

OSPSP3

Assembly Code

XXX/XXX

SUME Range Code

Bill of Material

| Item | Description | Material | AFL or Dwg. No. | Req'd | Remarks |
|------|--------------------------------------|------------------|-----------------|-------|--------------------------|
| 1 | Socket Eye | Galvanized Steel | SE-SC | 1 | |
| 2 | Y-Clevis Ball | Galvanized Steel | YCBS | 1 | Pin Dia. = 0.75" (19 mm) |
| 3 | Suspension Clamp Assembly (Included) | Aluminum | SUME XXX/XXX | 1 | |

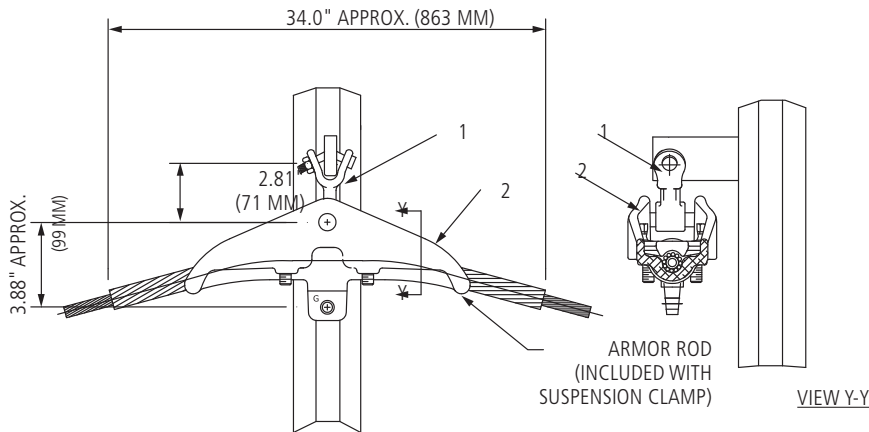

AFL NO.

OSPSP4

Assembly Code

XXX/XXX

SUME Range Code

Bill of Material

| Item | Description | Material | AFL or Dwg. No. | Req'd | Remarks |
|------|--------------------------------------|------------------|-----------------|-------|--------------------------|
| 1 | Y-Clevis Eye 90° | Galvanized Steel | YC90E-750-1750 | 1 | Pin Dia. = 0.75" (19 mm) |
| 2 | Suspension Clamp Assembly (Included) | Aluminum | SUME XXX/XXX | 1 | |

continued

OPGW Single Suspension Steel Pole/Vang Configuration Assemblies (cont.)

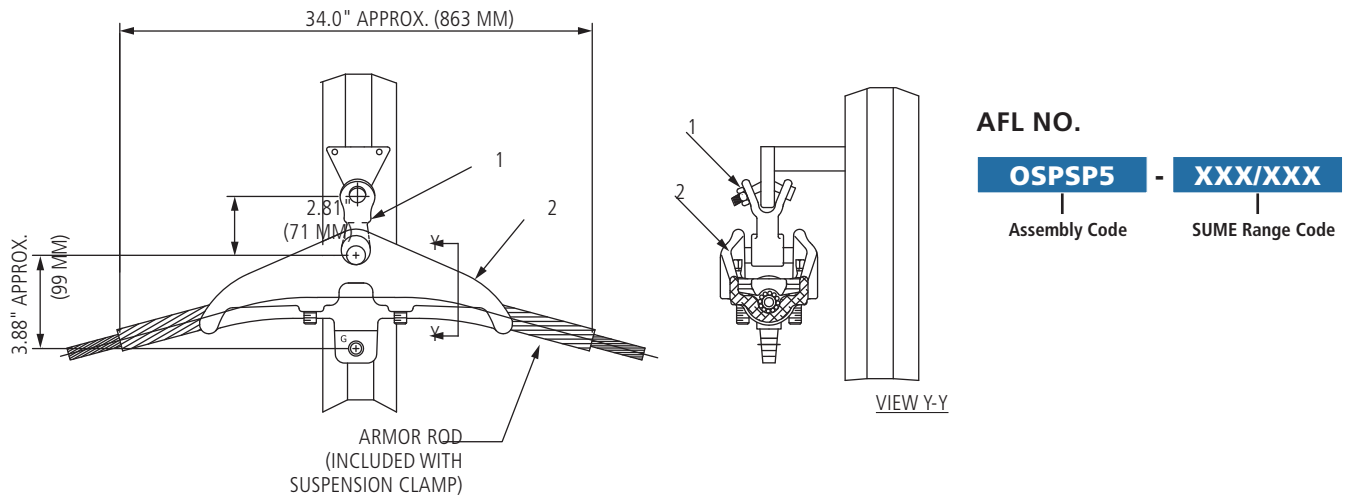

Bill of Material

| Item | Description | Material | AFL or Dwg. No. | Req'd | Remarks |
|------|--------------------------------------|------------------|-----------------|-------|--------------------------|
| 1 | Y-Clevis Eye | Galvanized Steel | YCE-690-1125 | 1 | Pin Dia. = 0.75" (19 mm) |
| 2 | Suspension Clamp Assembly (Included) | Aluminum | SUME XXX/XXX | 1 | |

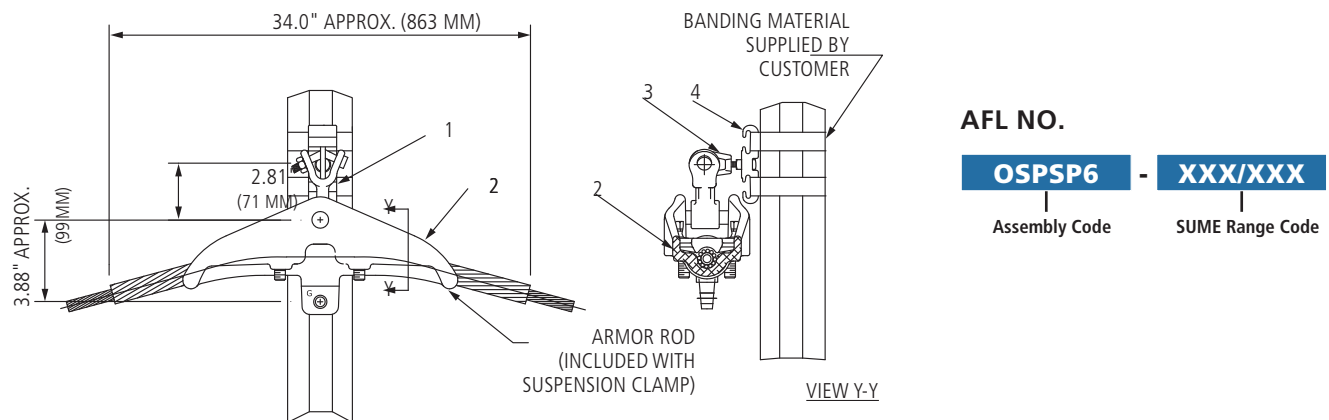

Bill of Material

| Item | Description | Material | AFL or Dwg. No. | Req'd | Remarks |
|------|--------------------------------------|------------------|-----------------|-------|-------------------------|
| 1 | Y-Clevis Eye 90° | Galvanized Steel | YC90E-750-1750 | 1 | Pin Dia. = 0.75" (19mm) |
| 2 | Suspension Clamp Assembly (Included) | Aluminum | SUME XXX/XXX | 1 | |
| 3 | Eye Bolt | Galvanized Steel | | | |
| 4 | Banding Adaptor | Aluminum | | | |