



LightLink Optical Entrance Enclosures

The Optical Entrance Enclosures (OEE) are designed to provide a convenient splicing and interconnection location for outside plant cabling entering a Central Office (CO), Controlled Environmental Vault (CEV) or customer location. Each unit is designed to allow the entrance and management of up to 60 cables for splicing and interconnecting. Cables from termination locations and the outside plant are easily installed and managed. Access to individual fiber splices and fiber bundles are made easy by splice tray and fiber management designs.

Features

- Manages multiple cable enter and exit facilities
- Each fiber splice tray (sold separately) handles up to 48 single fusion or 144 mass fusion splices
- Enclosures for indoor or outdoor applications
- Internal ground bar and pass through ground lugs



OEE-288/576 Optical Entrance Enclosures

Specifications

PARAMETER	VALUE
Material	Aluminum or steel
Coatings	Electrostatically applied, powder coat
Color	Granite
Dimensions	See Detail Drawings on following page



Accessories – Shingle Kits

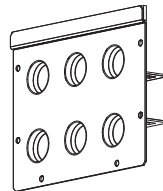

Standard Footprint 6 Ports

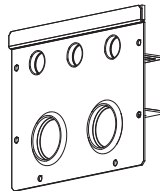

Standard Footprint 5 Ports

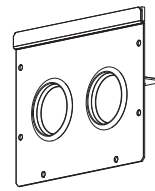

Standard Footprint 2 Ports - XL

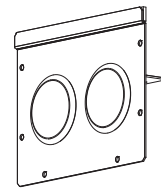

Standard Footprint 2 Ports - XXL



OEE-720/1440 Optical Entrance Enclosures

continued
→

LightLink Optical Entrance Enclosures

Dimensions

OEE 288/576

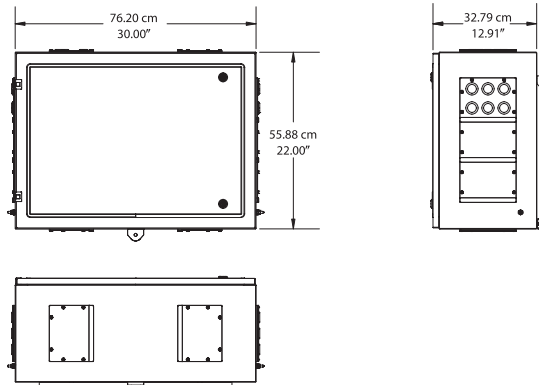

OEE 720/1440

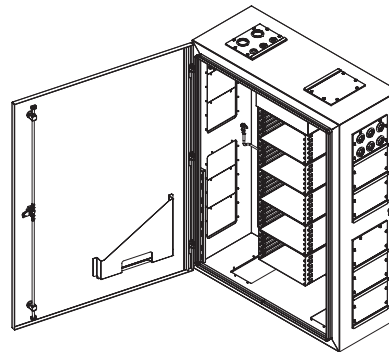
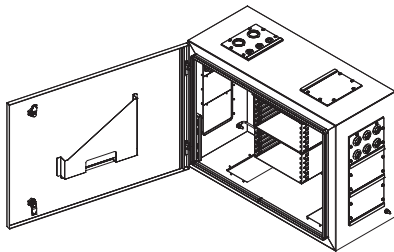
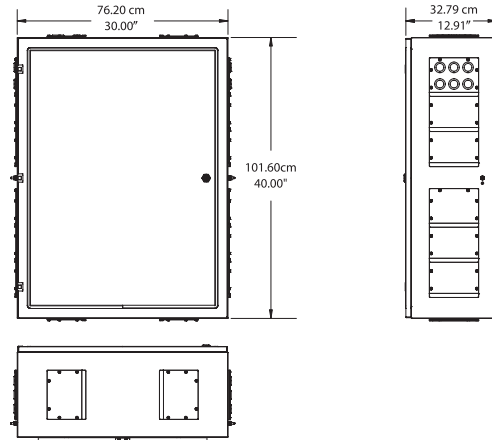

Qualifications

GOVERNING BODY	STANDARD CODE
NEMA	Type 3

continued
→

LightLink Optical Entrance Enclosures

Ordering Information

DESCRIPTION	MODEL NO.	AFL NO.
<p>OPTICAL ENTRANCE ENCLOSURE</p> <p>576 Single Fusion or 1728 Mass Fused Splice Capacity, up to 60 Cable Entry Ports</p> <p>Includes:</p> <ul style="list-style-type: none"> (2) 6-Port Standard Shingles (each port accepts a 0.472-0.7089" Cable) (1) 5-Port Shingles (2 Ports accept a 0.708-0.988" cable, and 3 small Ports accept a cable 0.236-0.473") (4) Medium Sealing and Retention Kits (each supporting a 0.472-0.708" cable) (1) Large Sealing and Retention Kit (each supporting a 0.708-0.988" cable) (3) Metallic Cable Bonding Kits (1) Wall-Mount Hardware (1) OEE Locking Key 	OEE-288/576	911309-00-05
<p>OPTICAL ENTRANCE ENCLOSURE</p> <p>576 Single Fusion or 1728 Mass Fused Splice Capacity, up to 60 Cable Entry Ports</p> <p>Includes:</p> <ul style="list-style-type: none"> (2) 6-Port Standard Shingles (each port accepts a 0.472-0.7089" Cable) (1) 5-Port Shingles (2 Ports accept a 0.708-0.988" cable, and 3 small Ports accept a cable 0.236-0.473") (4) Medium Sealing and Retention Kits (each supporting a 0.472-0.708" cable) (1) Large Sealing and Retention Kit (each supporting a 0.708-0.988" cable) (3) Metallic Cable Bonding Kits (1) Wall-Mount Hardware (1) OEE Locking Key (6) OEE Fiber Splice Tray 	OEE-288/576-6T	912371-00-00
<p>OPTICAL ENTRANCE ENCLOSURE</p> <p>1440 Single Fusion or 4320 Mass Fused Splice Capacity, up to 60 Cable Entry Ports</p> <p>Includes:</p> <ul style="list-style-type: none"> (2) 6-Port Standard Shingles (each port accepts a 0.472-0.7089" cable) (1) 5-Port Shingles (2 Ports accept a 0.708-0.988" cable, and 3 small Ports accept a cable 0.236-0.473") (4) Medium Sealing and Retention Kits (each supporting a 0.472-0.708" cable) (1) Large Sealing and Retention Kit (each supporting a 0.708-0.988" cable) (3) Metallic Cable Bonding Kits (1) Wall-Mount Hardware (1) OEE Locking Key 	OEE-720/1440	911275-00-05
<p>OPTICAL ENTRANCE ENCLOSURE</p> <p>1440 Single Fusion or 4320 Mass Fused Splice Capacity, up to 60 Cable Entry Ports</p> <p>Includes:</p> <ul style="list-style-type: none"> (2) 6-Port Standard Shingles (each port accepts a 0.472-0.7089" cable) (1) 5-Port Shingles (2 Ports accept a 0.708-0.988" cable, and 3 small Ports accept a cable 0.236-0.473") (4) Medium Sealing and Retention Kits (each supporting a 0.472-0.708" cable) (1) Large Sealing and Retention Kit (each supporting a 0.708-0.988" cable) (3) Metallic Cable Bonding Kits (1) Wall-Mount Hardware (1) OEE Locking Key (12) OEE Fiber Splice Tray 	OEE-7220/1440-12T	912372-00-00

continued
→

LightLink Optical Entrance Enclosures

Accessories

DESCRIPTION	MODEL NO.	AFL NO.
OEE Fiber Splice Tray	STF-48	911442-00-00
Metallic Cable Bonding Kit	MBK-1	911260-00-01
Work Shelf	OEE-WS	911262-00-00
Cable Retention and Sealing Kit – Small (Accepts 0.236-0.473" O.D. Cable)	CRSK236-473	911310-00-00
Cable Retention and Sealing Kit – Medium (Accepts 0.472-0.708" O.D. Cable, four included with OEE)	CRSK472-708	911310-01-00
Cable Retention and Sealing Kit – Large (Accepts 0.708-0.988" O.D. Cable, one included with OEE)	CRSK708-988	911310-02-00
Cable Retention and Sealing Kit – XLarge (Accepts 0.866-1.25" O.D. Cable)	CRSK866-1250	911310-03-00
Cable Retention and Sealing Kit – XXLarge (Accepts 1.25-1.49" O.D. Cable)	CRSK1250-1490	911310-04-00
Shingle Kit – Standard, 6-Ports (Accepts Six Cables From 0.472-0.708" O.D., two included with OEE)	SK-STD	911261-00-00
Shingle Kit – Standard, 5-Ports (2) Large (0.708-0.988" O.D. Cable Ports) (3) Small (0.236-0.472" O.D. Cable Ports) (One Included with OEE)	SK-LS	911261-01-00
Shingle Kit, Two X-Large, (2) Cable Ports (0.866-1.25" O.D.)	SK-XL	911261-02-00
Shingle Kit, Two XX-Large, (2) Cable Ports (1.25-1.49" O.D.)	SK-XXL	911261-03-00
Security Door Latch Key Only	—	18295-00-00
Key Locking Kit for OEE, 1 lock* *2 required for OEE-288/576 *1 required for OEE-720/1440	OEE-LK	911428-00-00
Ground Bar Kit for OEE: additional internal ground bar	OEE-GBK	911429-00-00

Cable Bonding Kit

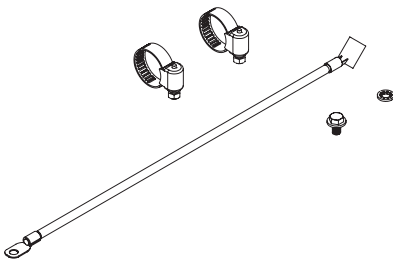

Cable Retention and Sealing Kit

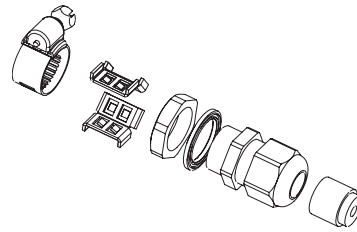

Work Shelf

