

Fujikura 100S Fusion Splicer

Built for the demands of modern fiber installation, the Fujikura 100S Fusion Splicer combines intelligent automation with user-first design to streamline daily splicing tasks. From faster fiber preparation and alignment to smart adjustments that eliminate manual guesswork, the 100S helps technicians work more efficiently and with greater confidence.

Its customizable interface adapts to the user, not the other way around, while robust engineering ensures consistent, high-quality splices in any environment. Whether you're on a tight schedule or tackling complex jobs, the 100S is designed to save time, reduce errors, and support peak performance in the field.

Intuitive Operation: Large LCD screen makes splicing as easy as using a smartphone.

Dual Fiber Preparation: The Fujikura 100S splicer supports dual fiber loading, allowing technicians to place two prepared fibers into the machine simultaneously. This can reduce splicing time by up to 30%!

Automated fiber-length adjustments: The 100S Fusion Splicer ensures optimal fiber positioning automatically for a perfect splice every time. If there's too little fiber in front of the electrodes, the splicer automatically pulls more through; if there's too much, it retracts the excess.

Splice Coach: For seasoned technicians, the built-in Splice Coach will help guide you to learn new techniques, improving your productivity and reinforcing splicing best practices.

Simple Fiber Guide: A built-in embedded fiber guide makes fiber loading faster and more accurate by allowing you to simply place the fiber into the guide while the splicer handles alignment.

Custom Splicer Setup: The 100S features a personalized splice settings menu that uses visual diagrams and detailed explanations to show how each parameter affects splicer components for confident customization.

GPS Tracking: The 100S features Location-Based Locking, which allows technicians to define a GPS-based Secure Zone where the device remains fully operational. If moved outside this designated area, the splicer automatically locks to prevent unauthorized use or theft. It also records the location of each splice for comprehensive tracking.

USB Power and Recharging: The 100S supports fast USB-C recharging (4-6 hrs.) and external battery support when the job runs longer than expected.



Features

- Automated wind protector, tube heater and splice operation
- Dual fiber loading reduces preparation time
- Embedded fiber guide for accurate, error-free fiber loading
- Built-in Splice Coach virtual mentor to improve productivity
- Custom Splicer Setup menus with new UI and visual diagrams
- GPS splice stamp for location record keeping
- Location Based Locking prevent unauthorized use or theft
- USB-C charging and data port
- Multi-function transit case with integrated workstation

Applications

- Distribution fiber repair
- Long-haul network installation
- Field termination with splice-on connectors
- Access network installation
- Fanout kits, pigtails and splice cassettes
- OSP cable installation and repair
- Optical modules – splitters, couplers, MUXs, EDFAs and attenuators



Fujikura 100S Fusion Splicer

Features

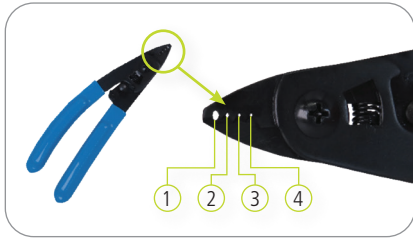

Fiber Stripper SS-05

- ① For 2.3 mm ② For 900 μm
- ③ For 250 μm ④ For 250 μm

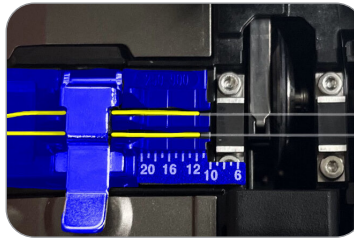

Dual Cleaving

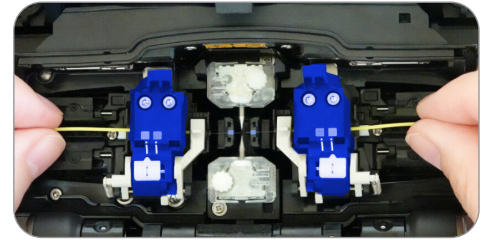

Dual Fiber Loading

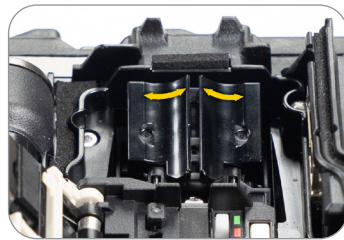

Fiber Placement Guide

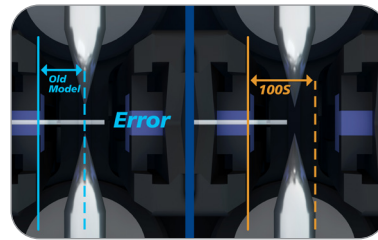

Expanded Fiber Setting

Ordering Information

Description	AFL No.
Fujikura 100S Fusion Splicer (machine only) Includes: ADC-22 AC Adapter, ACC-19 AC Cord, BTR-19 Battery, ELCT2-16C Spare Electrodes (pair), Sheath Clamps, SP-05 Fiber Holder Set Plates, USB-02 Cable, Alcohol Dispenser, Splicer Carrying Strap, Quick Reference Guide, TS-04A Tripod Screw, Work Tray J-Plate, SS05 single fiber stripper, CC-48 Transit Case with Carrying Strap and Two-Year Warranty	S018656
Fujikura 100S Standard Fusion Splicer Kit (with cleaver) Includes: CT60 Cleaver, ADC-22 AC Adapter, ACC-19 AC Cord, BTR-19 Battery, ELCT2-16C Spare Electrodes (pair), Sheath Clamps, SP-05 Fiber Holder Set Plates, USB-02 Cable, Alcohol Dispenser, Splicer Carrying Strap, Quick Reference Guide, TS-04A Tripod Screw, Work Tray J-Plate, SS05 single fiber stripper, CC-48 Transit Case with Carrying Strap and Two-Year Warranty	S018655
Fujikura 100S Fusion Splicer without Bluetooth (machine only) Includes: ADC-22 AC Adapter, BTR-19 Battery, ACC-19 AC Cord, ELCT2-16C Spare Electrodes (pair), Sheath Clamps, SP-05 Fiber Holder Set Plates, USB-02 Cable, Alcohol Dispenser, Splicer Carrying Strap, Quick Reference Guide, TS-03 Tripod Screw, Work Tray J-Plate, SS03 Single Fiber Stripper, CC39 Transit Case with Carrying Strap and Two-Year Warranty	S018693
Fujikura SpliceReady 100S Splicer Kit includes: Fujikura 100S Standard Kit (S0), FP-60 60 mm (single splice) protection sleeve (pack of 100), FCC2 fiber cleaning fluid (3 oz.), AFL WFW wipes mini tub (90 wipes), Kevlar scissors, FH-70-900 fiber holders (pair), FH-70-250 fiber holders, Mechanical Splice Fiber Holder (250 μm), Sharpie, Splicer V-groove cleaning kit, FH-FC-900 fiber holder (900 μm cable)	S018696
One-Year Extended Warranty	S012996
Two-Year Extended Warranty	S013000



Fujikura SpliceReady 100S Splicer Kit (S018696)

Fujikura 100S Fusion Splicer

Recommended Products for the 100S

Description	AFL No.
Cleavers	
CT-60 Cleaver	S018654
Fiber Holders (pair)	
FH-70-250 (250 μm coated fiber)	S017111
FH-70-900 (900 μm jacketed fiber)	S017113
FH-70-160 (160 μm coated fiber)	S017095
FH-70-200 (200 μm coated fiber)	S017711
FH-60-LT900 (Loose buffer 900 μm fiber)	S015181
FUSEConnect® Accessories	
FH-FC-20 (900 μm within 2.0 mm sheathing) (each)	S014696
FH-FC-30 (900 μm within 3.0 mm sheathing) (pair)	S014695
FH-FC-900 (900 μm cable) (each)	S014697
CLAMP-FC-2000 (pair)	S014705
CLAMP-FC-3000 (single holder)	S014704
Power Supply Options and Equipment	
ADC-22 AC Adapter	S018666
ACC-19 AC Power Cord	S018667
BTR-19 Battery	S018670
DCC-20 Power Cord	S017527
(connects AC Adapter to cigarette lighter socket)	
DCC-21 Power Cord	S017528
(connects AC Adapter to power source via alligator clips)	

Description	AFL No.
Miscellaneous	
SS05 Dual Fiber Stripper (4 hole)	S018327
ELCT2-16C Electrodes	S018669
SP-05 Fiber Holder Set Plates	S018671
Portable Tripod Worktray Kit (see product profile for more detail)	S014773
ASW-02 Splicing Workstation (see product profile for more detail)	S010532
WT-11R Transit Case - Work Tray Right (100 Series)	S018674
WT-11L Transit Case - Work Tray Left (100 Series)	S018673
JP-11 Work Tray J-Plate	S018675
JP-12 J-Plate (Cooling tray attaches to splicer)	S018681
TS-04 Tripod Screw (100 Series)	S018677
CLAMP-DC-12 (Drop cable clamp for work tray)	S017550
USB-02 Cable	S018668
CC-48 Transit Case	S018672
Splicer V-Groove Cleaning Kit	S014397
ST-03 Fusion Splicer Carrying Case Strap	S017549

Specifications

Parameter	Value	
Fiber Alignment Method	Active core alignment	
Fiber Count Can Be Spliced	Single fiber	
Applicable Fiber	Fiber Type	Single-mode optical fiber
		Multimode optical fiber
Applicable Coating	Cladding Diameter	80 to 150 μm
	Sheath Clamp	Coating dia.: Max. 3,000 μm Cleave length: 5 to 16 mm
Fiber Splice Performance	Splice Loss	ITU-T G.652: Avg. 0.02 dB
		ITU-T G.651: Avg. 0.01 dB
		ITU-T G.653: Avg. 0.04 dB
		ITU-T G.654: Avg. 0.04 dB
		ITU-T G.655: Avg. 0.04 dB
		ITU-T G.657: Avg. 0.02 dB
	Splice Time	SM FAST mode: Avg. 7 to 9 sec.; SM AUTO mode: Avg. 11 to 13 sec.; AUTO mode: Avg. 14 to 16 sec.
Applicable Protection Sleeve	Sleeve Type	Heat-shrinkable sleeve
	Sleeve Length	Max. 66 mm
	Sleeve Dia.	Max. 6.0 mm before shrinking
Sleeve Heat Performance	Heat Time	60 mm slim mode: Avg. 8 to 10 sec.
		60 mm mode: Avg. 13 to 15 sec.
Fiber Tensile Test Force	Approx. 2.0 N	
Electrode Life	Approx. 6,000 splices	
Physical Description	Dimensions W	Approx. 155 mm without projection
	Dimensions D	Approx. 176 mm without projection
	Dimensions H	Approx. 171 mm without projection
	Weight	Approx. 2.8 kg including battery

Fujikura 100S Fusion Splicer

Specifications (cont.)

Parameter		Value
Environmental Condition	Temperature	Operate: -10 to 50°C
		Storage: -40 to 80°C
	Humidity	Operate: 0 to 95% RH non-condensing Storage: 0 to 95% RH non-condensing
	Altitude	Max. 5,000 m
AC Adaptor	Input	AC100 to 240 V, 50/60 Hz, Max. 1.5 A
Battery Pack	Type	Rechargeable Lithium Ion
	Output	Approx. DC14.4V / 6,380 mAh
	Capacity	Approx. 300 splice and heat cycles
	Temperature	Operate: -10 to 50°C
		Recharge: 0 to 40°C
		Storage < 1 year: -20 to 20°C; < 1 month: -20 to 50°C
Battery Life	Approx. 500 recharge cycles	
Recharge Time	Approx. 4-6 hours from empty	
Display	LCD Monitor Magnification	TFT 5 inches with touch screen 320x
Illumination	V-Grooves	LED lamp
Interface	PC	USB2.0 Type C (USB PD compatible)
	External Led Lamp	USB2.0 A type, Approx. DC5V, 500 mA
	Ribbon Stripper	Mini DIN 6 pin, DC12V, Max. 1A
	Wireless	Bluetooth 5.2 LE
Data Storage	Splice Mode	100 splice modes
	Heat Mode	30 heat modes
	Splice Result	20,000 splices
	Splice Image	100 images
Screw Hole For Tripod		1/4-20 UNC
Other Features	Automatic Functions	Splice mode select by fiber type analysis – Function Control and Discharge power calibration
		Wind protector: open/close
		Sheath clamp: open
		Heater lid: open/close
		Heater clamp: open/close
Reference Guide	Video and PDF file stored in splicer	
Sheath Clamp	Easy sleeve positioning clamp Close with fiber set (optional) Guild for fiber loading (optional)	
Electrode	Replaceable without tool	
GPS	Document splice location into memory Security disable feature for out of region operation No tracking function	