



## FRESH AIR AT YOUR FINGERTIPS

The LuminAire® Retractable Screen Door adds ventilation to your home without changing the look on your entryway. It features the SlideAway® insect screen system that disappears when not in use and easily engages to allow fresh air in when desired.

### KEY FEATURES

- **EASILY HIDDEN**  
SlideAway® insect screen system designed to disappear when not in use
- **EASY TO USE**  
Quiet, controlled operation for smooth, reliable performance
- **EASY TO INSTALL**  
Installs in 3 easy steps and requires only basic tools and no cutting
- **EASY LIGHT AND VENTILATION**  
Brings in natural light and ventilation on demand

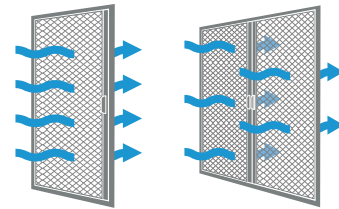

## THE LUMINAIRE SCREEN DOOR DIFFERENCE



### COLOR-MATCHED HANDLE

With a slim profile, our color-matched handle fits the clean LuminAire door design.



### REINFORCED CORNERS

Featuring reinforced corners for long-lasting\* durability.



### LOCKING LATCH

Convenient locking night latch.



### SLIDEAWAY SCREEN SYSTEM

Smooth, reliable operation that disappears when not in use.



### INTEGRATED DESIGN

Sleek profile design integrates seamlessly with entryway.

# LUMINAIRE® RETRACTABLE SCREEN DOOR

## OPTIONS

### CONFIGURATIONS



Fits single inswing hinged doors

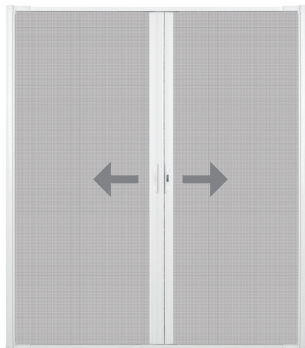

Fits double inswing hinged doors

### COLOR OPTIONS

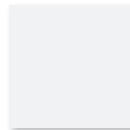

White



Sandtone



Bronze



Charcoal Gray



Black

## EASY INSTALL

Installs in three simple steps with only basic tools and no cutting required.\*

### SIMPLE 3-STEP INSTALLATION

1

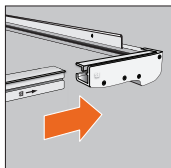

ASSEMBLE the sides and top/bottom screen tracks

2



PLACE the assembled unit into the opening

3

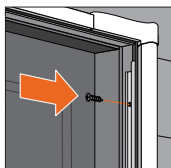

SECURE the unit into the opening

### ADJUSTS TO FIT ALMOST ANY DOOR:



FITS OPENING TYPE:  
Single-Hinged Door

ADJUSTABLE TO WIDTHS:  
32" - 36"

Fits opening widths 31 <sup>7</sup>/<sub>8</sub>" - 36 <sup>3</sup>/<sub>8</sub>"

HEIGHT:  
80"

Fits opening heights 80" - 80 <sup>7</sup>/<sub>8</sub>"

Available in 78" and 84" heights



FITS OPENING TYPE:  
Double-Hinged Door

ADJUSTABLE TO WIDTHS:  
68" - 72"

Fits opening widths 68" - 72"

HEIGHT:  
80"

Fits opening heights 80" - 80 <sup>7</sup>/<sub>8</sub>"

Available in 78" and 84" heights

\*Refer to the installation guide for complete instructions. Printing limitations prevent exact finish replication. See your Andersen supplier for exact finish samples.

Emco Enterprises LLC is a wholly owned subsidiary of Andersen Corporation that manufactures and supports the limited warranties for Andersen® and Emco storm doors.

"Andersen" and all other marks where denoted are trademarks of Andersen Corporation and its subsidiary. ©2024 Andersen Corporation. All rights reserved. 4/24



For more information,  
visit [andersenwindows.com/luminaire](https://andersenwindows.com/luminaire)