

Part No. 7712941

## Fitting Instructions

### GasSaver GS-2

The GasSaver GS-2 is approved for use with the following boiler models:-

Baxi 600 Combi range

Baxi 800 Combi range

Potterton Assure Combi range

Main Eco Compact Combi

Baxi 600 System range

Baxi 800 System range

Potterton Assure System range

Main Eco Compact System

## Contents

Section	Page
1.0 Introduction	3
2.0 Technical Data	4
3.0 Important Information & Operation	5
4.0 Installation	6
5.0 General Notes	7

© Baxi Heating UK Ltd 2019 All rights reserved. No part of this publication may be reproduced or transmitted in any form or by any means, or stored in any retrieval system of any nature (including in any database), in each case whether electronic, mechanical, recording or otherwise, without the prior written permission of the copyright owner, except for permitted fair dealing under Copyrights, Designs and Patents Act 1988.

Applications for the copyright owner's permission to reproduce or make other use of any part of this publication should be made, giving details of the proposed use, to the following address:

The Company Secretary, Baxi Heating UK Limited, Brooks House, Coventry Road, Warwick, CV34 4LL

Full acknowledgement of author and source must be given.

**WARNING:** Any person who does any unauthorised act in relation to a copyright work may be liable to criminal prosecution and civil claims for damages.



## 1.0 Introduction

### 1.1 Description

1. The GasSaver GS-2 Passive Flue Gas Heat Recovery Device as listed in the Government's Product Characteristics Database (PCDB).

2. The GasSaver uses heat from the flue gases to pre-heat incoming cold mains water; thus reducing gas consumption during the production of Domestic Hot Water.

3. The GasSaver is manufactured under a patent licence from Canetis.

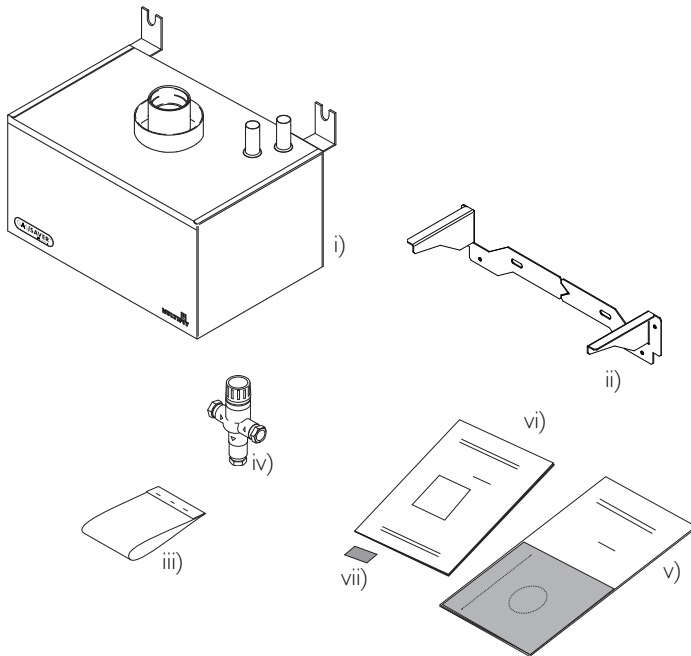

### 1.2 Contents of Pack

The pack contains:-

- i) GasSaver Unit
- ii) Support Bracket
- iii) Wall Fixing Screws Pack
- iv) Blending Valve
- v) Template
- vi) Literature
- vii) SAP Label for boiler

### 1.3 Flue Lengths

1. To ensure **full boiler output** the following equivalent flue length should not be exceeded:-

all models - **5 metres**

Consult the boiler instructions for details of the equivalent length values of any bends.

2. The 60/100 **concentric** horizontal or vertical flue system (Flue Group A) approved for the boilers listed on p. 2 **MUST** be used.

3. The GasSaver **MUST NOT** be used with the 80/125 flue system or Plume Displacement Kits. Where plumbing may cause a nuisance it is permissible to use Flue Terminal Deflector part no. 5111068 (Black), 720644201 (White) or 720644301 (Brown).

### 1.4 Accessory

To prevent backflow into the water supply the following items are available as an accessory:-

#### For Combi models

Expansion Vessel & Check Valve Kit 720066401

#### For System models

Expansion Vessel & Check Valve Kit 7736697  
(inc. 1 x swept tee)

## 2.0 Technical Data

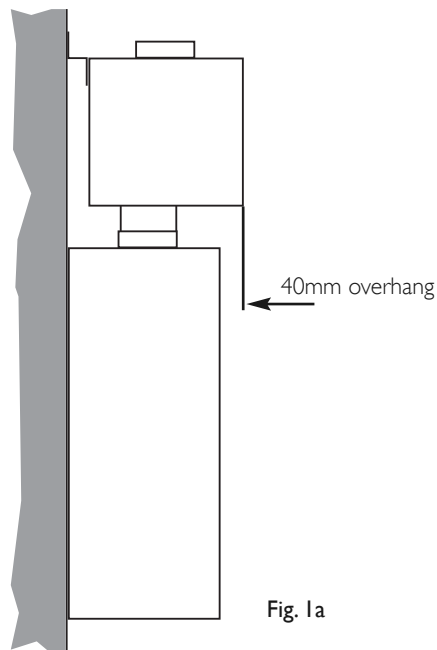
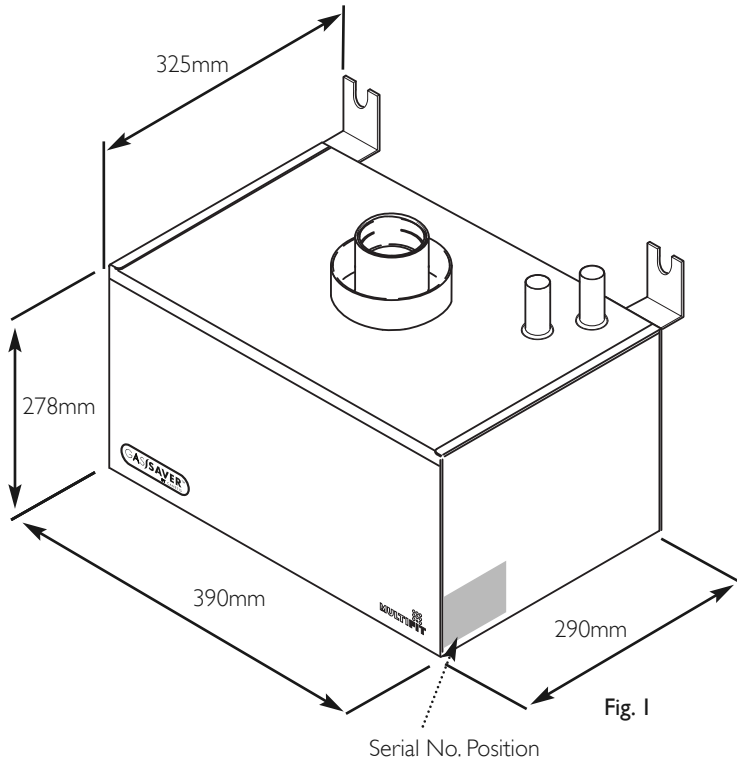

<b>DHW Circuit Pressures</b>	bar
Max Inlet	- 5*
Min Operating	- 0.2

\*if required fit a pressure reducing device to achieve this

<b>DHW Circuit Flow Rates</b>	l/min
Max Flow Rate	- up to 15*
	(*depending on boiler model)
Min Flow Rate	- 2.5

<b>Connections</b>	stainless steel
Cold Water Mains Inlet	- 15mm
Pre-heated Mains Outlet	- 15mm

<b>Dimensions (Fig. 1)</b>	mm
Casing Height	- 278mm
Casing Width	- 390mm
Casing Depth	- 290mm
Overall Depth (inc. brackets)	- 325mm

<b>Weights</b>	kg
Packaged Weight	- 18.4
Installation Lift Weight	- 15.6
Weight - Full	- 24

<b>Clearances</b>	mm
Above Casing	- 175 mm
Below Casing	- 80 mm
Front	- 450 mm Min (For Inspection)
Front	- 5 mm Min (In Operation)
L.H. Side	- 5 mm
R.H. Side	- 5 mm

**Note** - the GasSaver GS2 overhangs the boiler by 40mm at the front (Fig. 1a). This must be taken into account as the boiler depth plus minimum clearance dimension is no longer valid.

<b>Blending Valve</b>	
Connections	- 15mm
Setting Temperature	- 30° C

<b>General</b>	
DHW H/Exch.	- Stainless Steel
Store & Flue Connection	- Stainless Steel
Casing	- White Paint - Steel
Condensate Store Capacity	- 5.5 litres
H/Exch Coil Capacity	- 2.7 litres

### 3.1 Important Information

1. The GasSaver must only be fitted with one of the range of boilers specified (see p.2). It must be installed in accordance with these instructions, and by a competent person.
2. The current Gas Safety (Installation & Use) Regulations must be observed, along with all relevant Building Regulations/Standards, Water Regulations/Standards and the B.S. Codes of Practice listed in the boiler instructions.
3. A dedicated wall fixing bracket (Section 1.2, item ii) is supplied to mount the GasSaver on - this **MUST** be used and fitted in accordance with these instructions and as shown on the template supplied.
4. The GasSaver must be fitted on a flat vertical surface.
5. The GasSaver is in effect part of the flue system and should be considered as such.

**IMPORTANT:** These instructions must be read in conjunction with those supplied with the boiler.

### 3.2 Operation (Fig. 2)

1. There are no moving parts in the GasSaver and it does not need any electrical supply. It is fitted to the boiler flue adaptor.
2. The diagram opposite shows how the heat is transferred from the flue gases into the mains cold water.
3. A gas-to-water heat exchanger extracts heat from the discharged products of combustion (hot flue gases). This heat is used to pre-heat the incoming cold mains before it is heated for domestic hot water purposes.
4. During the transfer of heat from the flue gases further condensation occurs, allowing latent heat to be captured. This condensate is utilised to form a thermal store within the GasSaver providing more recovered heat that is used in the pre-heat process.
5. Additionally, as the flue gases leaving the GasSaver contain considerably less moisture, the amount of plumbing is reduced.

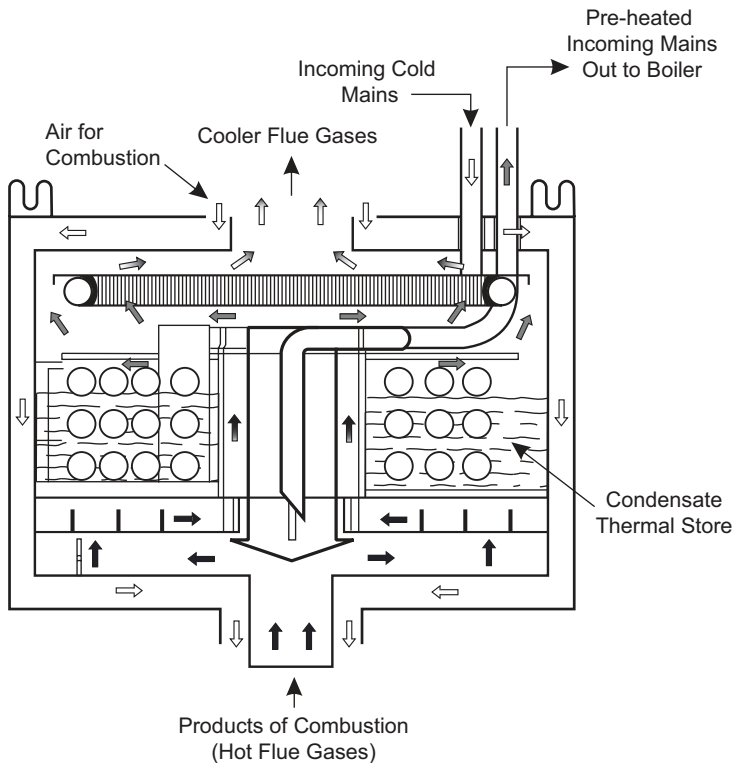

Fig. 2

## 4.0 Installation

### 4.1 Installation

**IMPORTANT:** Follow the Installation & Servicing Instructions supplied with the boiler to the point at which the wall plate is fitted, but do not mark the flue position. **The GasSaver must be fitted on a flat vertical surface.**

1. Align the GasSaver template with the wall plate (Fig. 3) and mark the positions of the flue, upper fixings and GasSaver mounting bracket.

2. Drill & plug the upper and bracket fixings. Make the hole for the flue & fit the boiler.

3. Position the GasSaver two piece mounting bracket centrally above the boiler once it is installed (Fig. 4), ensuring the "V" shape locating feature is engaged.

4. The GasSaver can now be fitted. Locate the connection on the underside of the GasSaver in the boiler flue adaptor; taking care to not displace the seals. **The GasSaver must be supported before securing.**

5. Whilst supporting the GasSaver secure it to the wall with the screws and washers provided using the upper fixing brackets (Fig. 5). **The weight of the GasSaver must be taken by the mounting bracket.**

6. To ensure correct and efficient operation the GasSaver must now be primed (Fig. 6) by pouring 6 litres of clean cold water into the central spigot. **Do not allow any water to spill into the air chamber.**

7. The flue system can now be installed (Fig. 7) and commissioning completed. The flue adaptor on top of the GasSaver is the same as that on the boiler.

**NOTE:** Where the installation has been "pre-plumbed" with pipework rising vertically the two piece mounting bracket can be inserted from both sides of the pipe runs (Fig. 8).

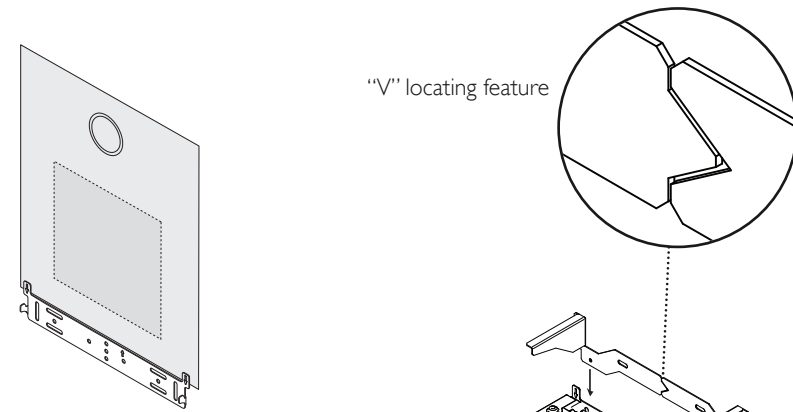
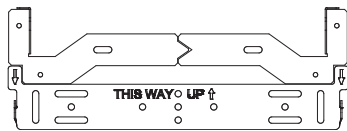

Fig. 3



GasSaver mounting bracket above boiler bracket

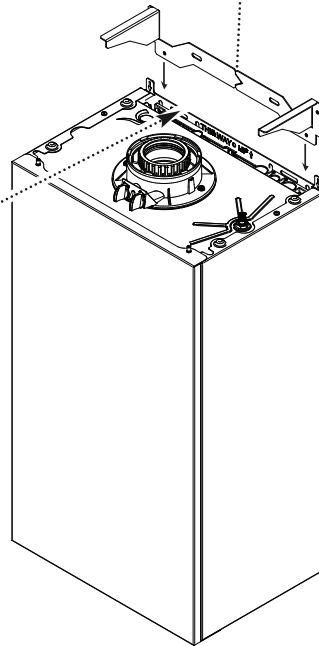

Fig. 4

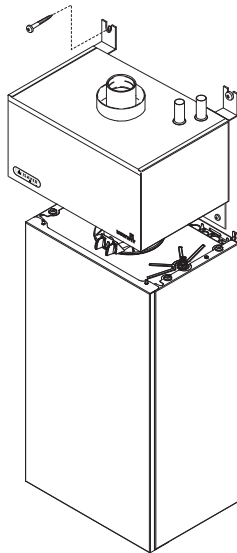

Fig. 5

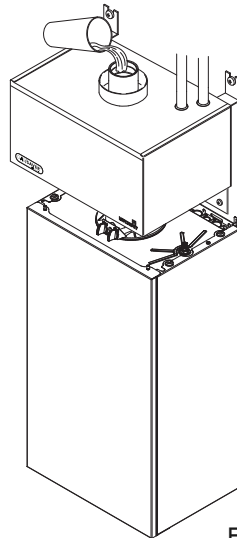

Fig. 6

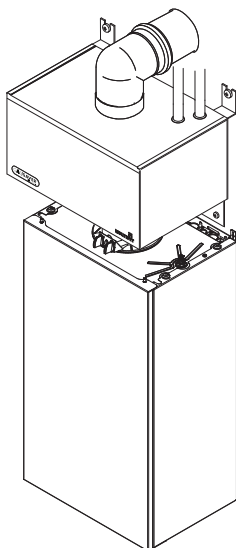

Fig. 7

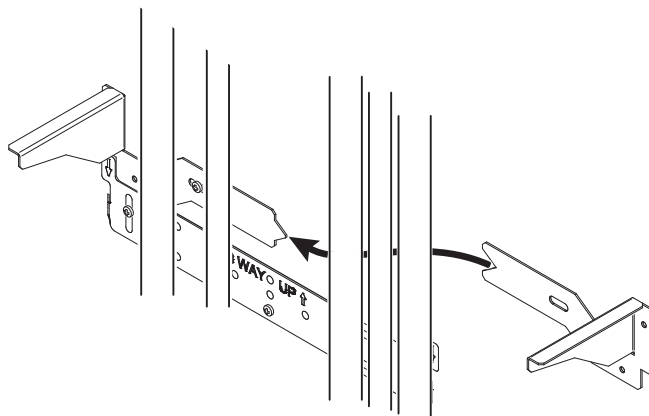

Fig. 8

## 5.0 General Notes

### 5.1 Pipework (Figs. 9 & 10)

1. Connect the DHW pipework to the GasSaver only using suitable compression fittings with copper olives. Do NOT use push fit or solder fittings.

**NOTE:** To comply with water regulations & byelaws an approved single check valve or some other no less effective backflow prevention device must be fitted at the point of connection between the supply and the device.

2. **Combi boilers** - Set the blending valve so that mains water is supplied to the boiler at approximately 30° C. Adjust the valve to position "1" and check the water temperature. Further adjustment may be required.

3. **System boilers** - Ensure that the components of the System Boiler Application kit (7736697 - includes a swept tee) are fitted in accordance with Fig. 11.

**SYSTEM BOILER APPLICATIONS.** It is recommended that the cylinder thermostat is set to 30° C and that the main heat source is enabled for at least one continuous hour per week for pasteurisation.

4. Certain circumstances require the installation of an expansion vessel on the mains inlet - see the relevant section of the boiler Installation & Servicing Instructions.

5. Apply the SAP label to the boiler (Fig. 12) and continue with the installation and commissioning procedure.

6. The GasSaver will operate at full effectiveness after approximately 24 hours operation.

### 5.2 Inspection

1. There are no specific maintenance requirements applicable to the GasSaver.

2. It is recommended that every time the boiler is serviced the GasSaver is subjected to a visual inspection of its overall condition and that of the flue & pipework connections.

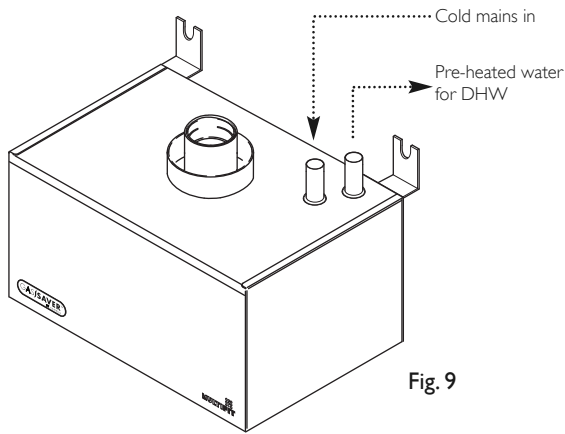

Fig. 9

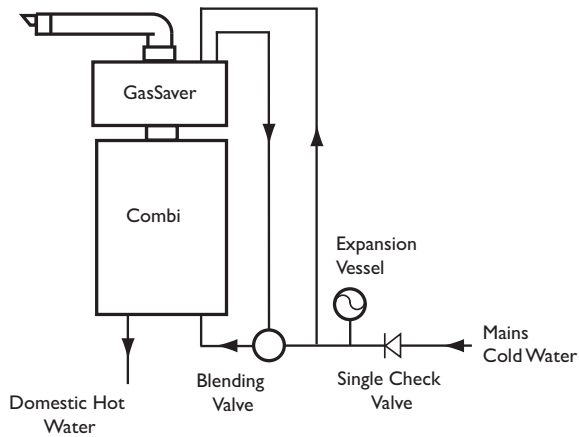

Fig. 10

Combi Boiler Application

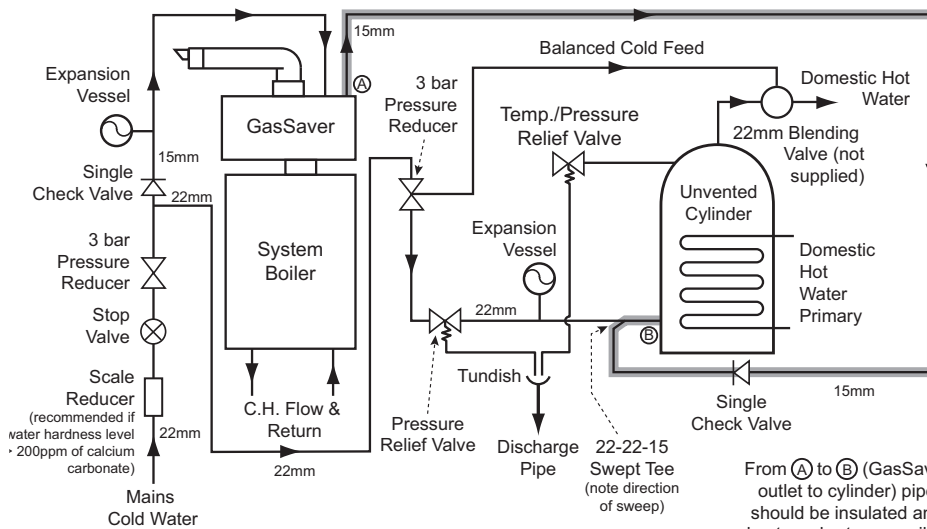

Fig. 11

System Boiler Application

From A to B (GasSaver outlet to cylinder) pipe should be insulated and kept as short as possible

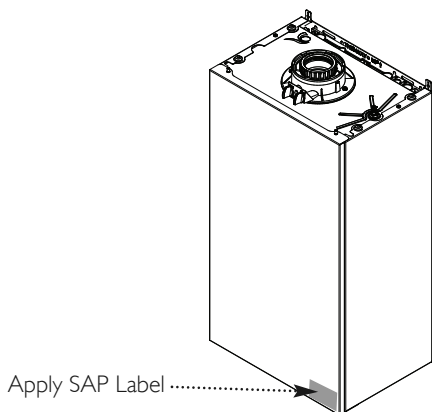

Fig. 12

## Baxi Customer Support



**0344 871 1545**

### Opening hours

Monday - Friday, 8.00am-6.00pm

Weekends and Bank Holidays, 8.30am-2.00pm

Please note calls may be recorded for training and monitoring purposes



**baxi.co.uk**

**potterton.co.uk**



Baxi

Brooks House,  
Coventry Road,  
Warwick, CV34 4LL

e&oe

All descriptions and illustrations provided in this document have been carefully prepared but we reserve the right to make changes and improvements in our products which may affect the accuracy of the information contained in this leaflet. All goods are sold subject to our standard Conditions of Sale which are available on request.

part of **BAXI**