



**EPL 21347 POLLUTION  
MONITORING REPORT,  
NOVEMBER 2020**  
**PARRAMATTA LIGHT RAIL**

**Parramatta**  
Connect

# Contents

<b>1. Introduction</b>	<b>1</b>
1.1. Background	1
1.2. Scope of this report	5
<b>2. Reporting Requirements</b>	<b>6</b>
<b>3. Monitoring</b>	<b>8</b>
3.1. Meteorological Data	8
3.2. Noise	10
3.3. Discharge to water	11
<b>4. Correction log</b>	<b>12</b>
<b>Appendices</b>	<b>13</b>
A-1 Weather Observations	13
A-2 Noise Monitoring Results	15
A-3 Discharge to water	17



**Project number**    **N81080**

**Document number:** PLR1INF-CPBD-ALL-PE-RPT-000045

**Revision date:**    25/11/2020

**Revision:**            0

<b>Rev.</b>	<b>Date</b>	<b>Prepared By</b>	<b>Reviewed By</b>	<b>Approved By</b>	<b>Remarks</b>
0	25/11/2020	O Cooper	D. Corish	D. Corish	Nil



# 1. Introduction

## 1.1. Background

Parramatta Light Rail is one of the NSW Government's major infrastructure projects being delivered to serve a growing Sydney.

Parramatta Light Rail Stage 1 ('Stage 1') will connect Westmead to Carlingford via Parramatta Central Business District (CBD) and Camellia. Stage 1 is expected to be operational in 2023.

Stage 1 will create new communities, connect great places and help both local residents and visitors move around and explore what the region has to offer. The route will link Parramatta's CBD and train station to a number of key locations, including the Westmead Precinct, the Parramatta North Growth Centre, the new Western Sydney Stadium, the Camellia Town Centre, the new Powerhouse Museum and Riverside Theatre arts and cultural precinct, the private and social housing redevelopment at Telopea, the Rosehill Gardens Racecourse and the three Western Sydney University campuses.

In summary, the key features of Stage 1 include:

- A new dual track light rail network of approximately twelve (12) kilometres in length, including approximately seven (7) kilometres within the existing road corridor and approximately five (5) kilometres within the existing Carlingford Line and Sandown Line, replacing current heavy rail services
- Sixteen (16) stops that are fully accessible and integrated into the urban environment including a terminus stop at each end of Westmead and Carlingford
- High frequency 'turn-up-and-go' services operating seven days a week from 5am to 1am. Weekday services will operate approximately every 7.5 minutes in the peak period between 7am and 7pm
- Modern and comfortable air-conditioned light rail vehicles, nominally 45 metres long and driver-operated, each carrying up to 300 passengers.
- Intermodal interchanges with existing public transport services at Westmead terminus, Parramatta CBD and the Carlingford terminus
- Creation of two light rail and pedestrian zones (no general vehicle access) within the Parramatta CBD along Church Street (generally between Market Street and Macquarie Street) and along Macquarie Street (generally between Horwood Place and Smith Street)
- A Stabling and Maintenance (SaM) Facility located in Camellia for light rail vehicles to be stabled, cleaned and maintained
- New bridge structures along the alignment including over James Ruse Drive and Clay Cliff Creek, Parramatta River (near the Cumberland Hospital), Kissing Point Road and Vineyard Creek, Rydalmere
- Alterations to the existing road network including line marking, additional traffic lanes and turning lanes, new traffic signals, and changes to traffic flows
- Relocation and protection of existing utilities
- Public domain and urban design works along the corridor and at Stop precincts

- Closure of the heavy rail line between Carlingford and Clyde
- Active transport corridors and additional urban design features along sections of the alignment and within Stop precincts
- Integration with the Opal Electronic Ticketing System (ETS)
- Real time information in light rail vehicles and at Stops via visual displays and audio.

An overview of Parramatta Light Rail Stage 1 route is shown in Figure 1-1.

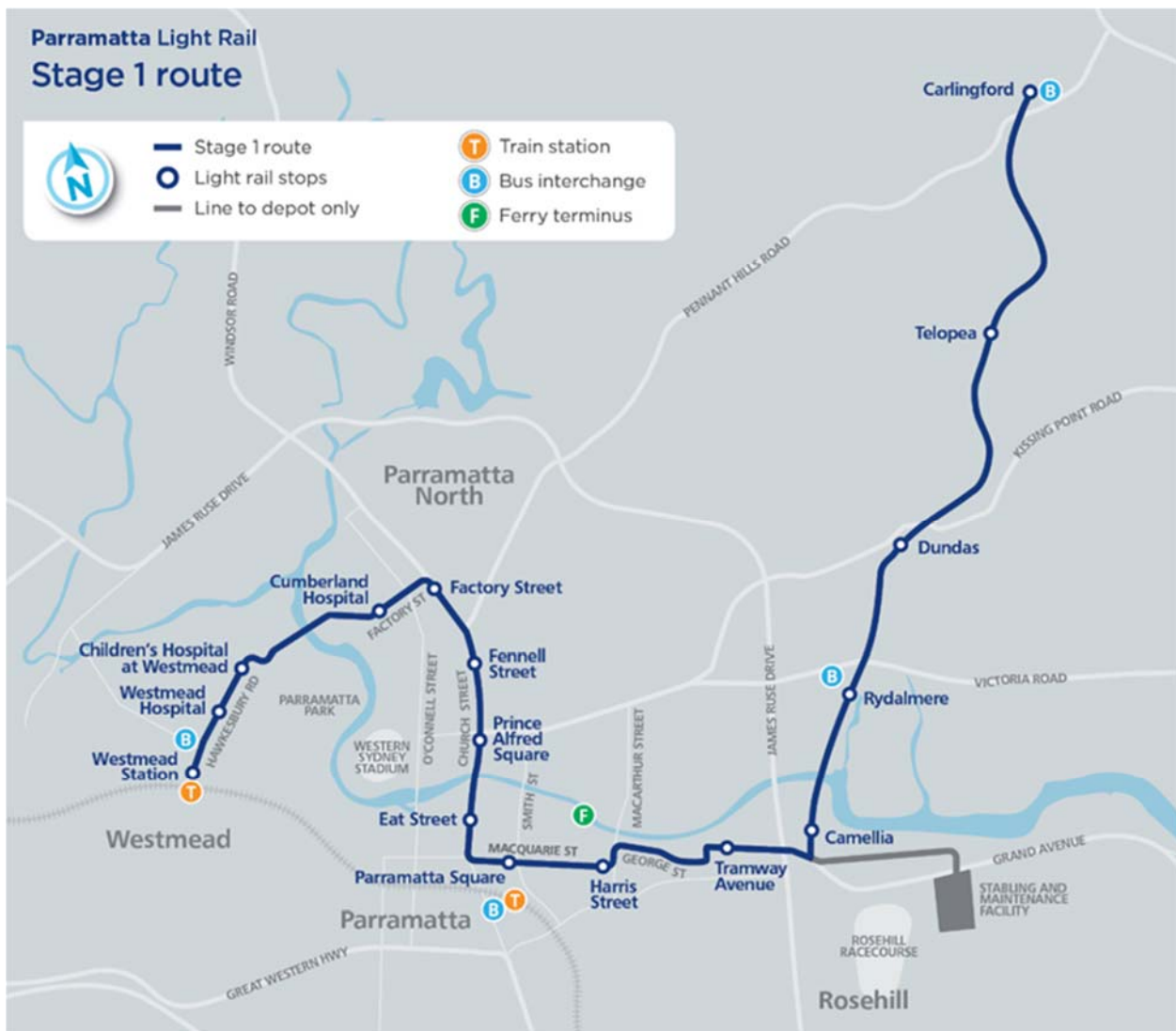

**Figure 1-1 Parramatta Light Rail Stage 1 Route**

The Parramatta Light Rail is subject to environmental impact assessment under the Environmental Planning and Assessment Act 1979 (EP&A Act). It is classified as Critical State Significant Infrastructure (CSSI). The EIS assessed impacts for Parramatta Light Rail Stage 1 (Westmead to Carlingford). This covered the light rail and associated works including road enabling work.



Stage 1 received Infrastructure Approval from the Minister for Planning under Section 5.19 of the EP&A Act on 29 May 2018 (Critical State Significant Infrastructure Application SSI-8285), subject to the conditions provided in the Instrument of Approval, specifically Schedule B – Ministerial Conditions of Approval.

The Infrastructure Approval was subsequently modified under Section 5.25 of the EP&A Act on 21 December 2018 and 25 January 2019.

The planning approval, modifications and related environmental assessment documents are located at: [http://majorprojects.planning.nsw.gov.au/index.pl?action=view\\_job&job\\_id=8285](http://majorprojects.planning.nsw.gov.au/index.pl?action=view_job&job_id=8285).

### 1.2.3 Stage 1 Delivery Strategy

Delivery of Stage 1 is achieved through the following five packages of work:

- **Enabling Works** (Package 1) – Local road network improvements including O’Connell Street and George Street (off-alignment)
- **Westmead Precinct Works** (Package 2) – Hawkesbury Road widening and demolition at Cumberland Hospital (east and west Campus)
- **Early Works** (Package 3) – Remediation of the Stabling and Maintenance (SaM) Facility
- **Infrastructure Works (Package 4) (the subject of this Report)** – Design and construction of civil works, public domain and light rail infrastructure up to road level/top of rail and to the top of the concrete slab at stops, including provision of utility services (excluding high-voltage power supply and cabling for rail systems), and decommissioning of the T6 Carlingford Line)
- **Supply, Operate and Maintain Works** (Package 5) – Design and construction of the light rail systems, high-voltage power supply and stops above slab level, the supply of light rail vehicles, and the design and construction of the SaM Facility, including all light rail operations, customer service and asset management.

Each package of work is to be delivered under separate contracts on behalf of the proponent Transport for NSW (TfNSW). While the packages will commence at different times under separate construction approvals, there will be periods during which the package works will overlap. The interactions between the packages are shown in **Figure 1-2**.

Parramatta Connect (the CPB Contractors and Downer EDI Works Joint Venture) has been engaged to deliver the Infrastructure Works. For construction, the Infrastructure Works are divided into portions and sub-portions, each of which is described in Table 1-1 together with significant environmental issues. The portions, light rail stops and precincts are depicted in **Figure 1-3**.

- Stage 1 route of Parramatta Light Rail
- ▬ Enabling Works
- ▬ Westmead Precinct Works
- ▬ Early Works
- ▬ Infrastructure Works
- ▬ Supply, Operate and Maintain Works

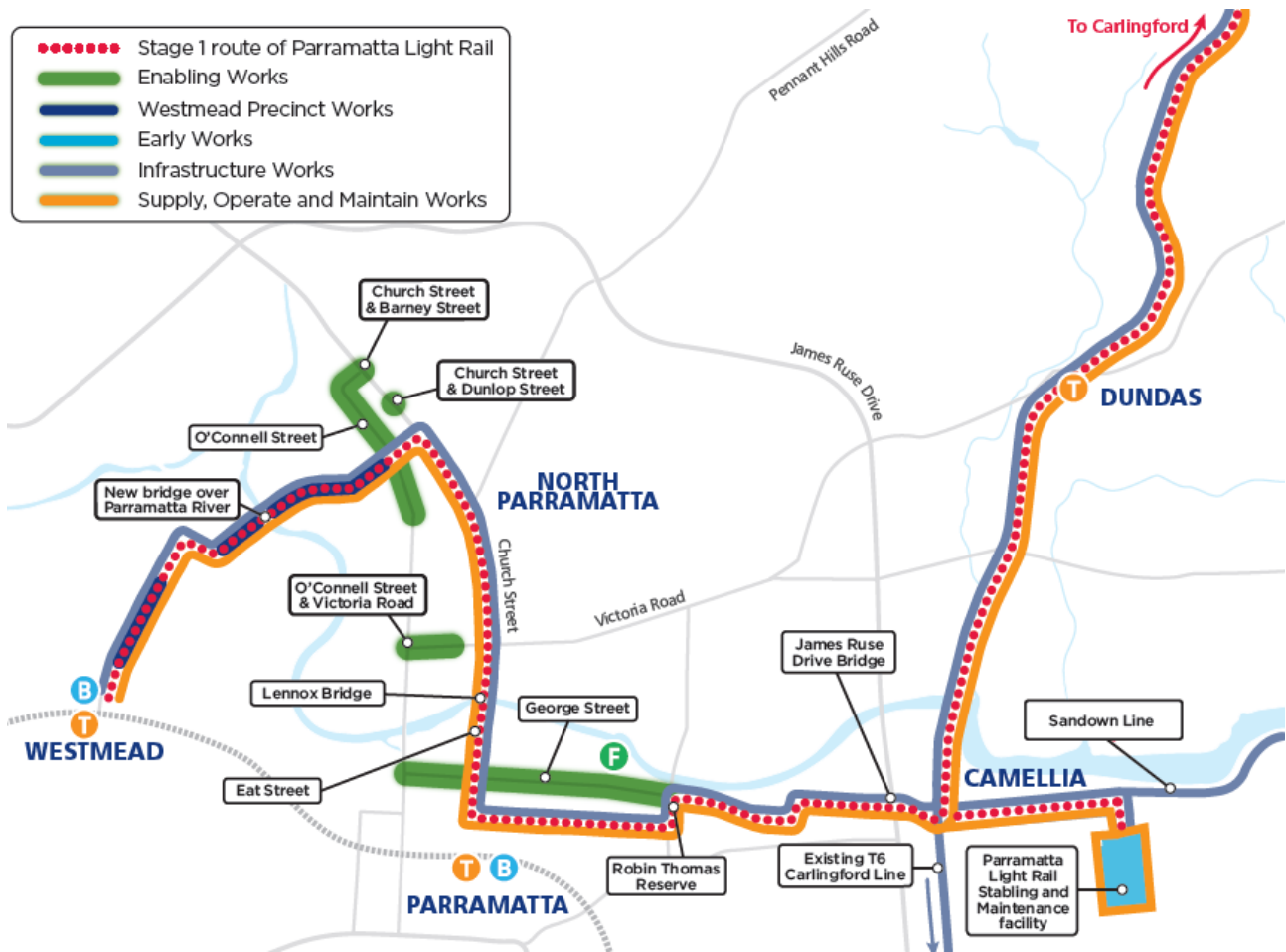

Figure 1-2 Parramatta Light Rail Stage 1 Delivery Strategy

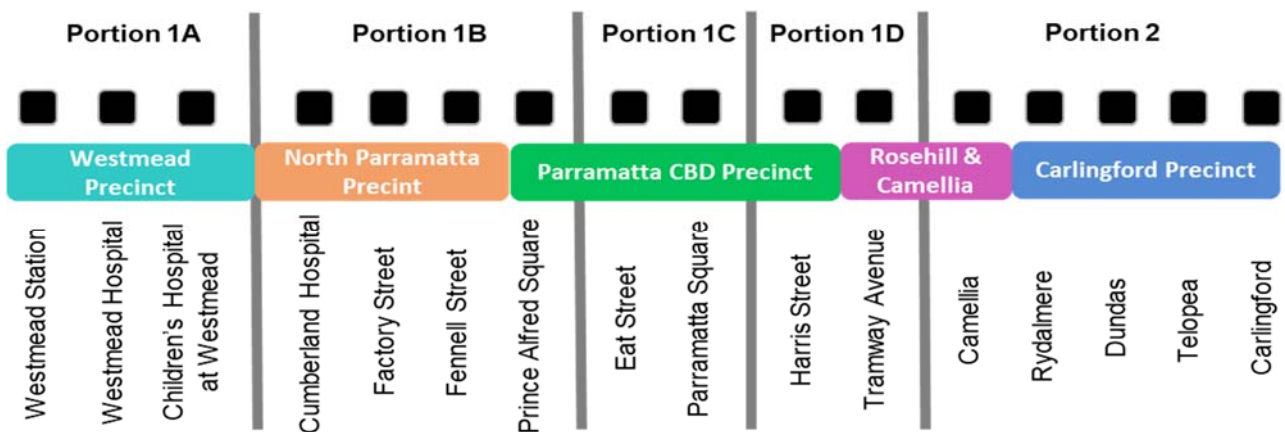

Figure 1-3 Infrastructure Works Portions, Precincts and Stations



## 1.2. Scope of this report

CPB Contractors Pty Limited have been issued an Environmental Protection Licence (EPL No. 21347) from the NSW Environment Protection Authority (EPA) for the Parramatta Light Rail Package 4 - Infrastructure Works on behalf of Parramatta Connect.

The EPL applies to the works approved under the Infrastructure Approval SSI-8285 associated with the delivery of Parramatta Light Rail Stage 1 Infrastructure Works (Package 4) under the operational control of Parramatta Connect. The EPL does not apply to other Parramatta Light Rail Stage 1 works packages.

This EPL Pollution Monitoring Report provides the results of all pollution monitoring required to be measured or monitored by the licensee of EPL 21347 as required by Section 66 of the *Protection of the Environment Operations Act 1997 (POEO Act)* and with reference to EPA Publication *Requirements for publishing pollution monitoring data* (Environment Protection Authority, 2013).

Table 1-1 provides a summary of the EPL 21347 details.

**Table 1-1 Licence details**

Licence Details	
Number:	21347
Copy of License	<a href="https://apps.epa.nsw.gov.au/prpoeoapp/ViewPOEOLicence.aspx?DOCID=177484&amp;SYSUID=1&amp;LICID=21347">https://apps.epa.nsw.gov.au/prpoeoapp/ViewPOEOLicence.aspx?DOCID=177484&amp;SYSUID=1&amp;LICID=21347</a>
Anniversary Date	03-January
Licensee	CPB Contractors Pty Limited
Premises	Parramatta Light Rail Stage 1 – Westmead to Carlingford, Package 4 Parramatta NSW 2123
Scheduled Activity	Railway activities - railway infrastructure construction





## 2. Reporting Requirements

Under the *POEO Act*, holders of environment protection licences (licensees) must publish or make pollution monitoring data available to members of the public.

The *POEO Act* Section 66 requires

“66 Conditions requiring monitoring, certification or provision of information, and related offences

(1) **Monitoring** The conditions of a licence may require—

- (a) monitoring by the holder of the licence of the activity or work authorised, required or controlled by the licence, including with respect to—
  - (i) the operation or maintenance of premises or plant, and
  - (ii) discharges from premises, and
  - (iii) relevant ambient conditions prevailing on or outside premises,and
  - (iv) anything required by the conditions of the licence, and
- (b) the provision and maintenance of appropriate measuring and recording devices for the purposes of that monitoring, and
- (c) the analysis, reporting and retention of monitoring data.

(2) **False or misleading information** A holder of a licence who supplies information, or on whose behalf information is supplied, to the appropriate regulatory authority under the conditions of the licence is guilty of an offence if the information is false or misleading in a material respect.”

The primary objective of the pollution monitoring reporting requirements is that members of the public have access to the results of all pollution monitoring (which a licence specifies must be carried out) in a way that is meaningful to them. Data for the Parramatta Light Rail Infrastructure Works is presented on a monthly sampling period.

The monitoring data that must be published and/or made available on request is any data that is obtained as a result of a monitoring condition on a licence that relates to air, water (surface or groundwater), noise and/or land pollution. The data to be published or provided is limited to data that relates to pollutants generated, discharged or emitted from the licensed premises.

The data is provided in tabular format that is easy for the general public to understand. Tables definitively display raw data values, while graphs and charts are useful for overviews and visualisation of long-term trends. Raw data will be provided upon request.

An upfront note will be included on the licensee’s website or in this report to explain why any data may appear to be missing because there is no discharge or the level of pollutant being below the detection level of the measurement instrument.

It is possible from time to time that incorrect data may be published in good faith. As soon as practicable after the licensee becomes aware that the published pollution monitoring data is incorrect or misleading, licensees must then publish a correction log to correct this data that is incorrect or misleading (refer to **Section 4**).



Table 2-1 provides a summary of the pollution monitoring requirements of EPL 21347.

**Table 2-1 EPL 21347 Pollution Monitoring Requirements**

<b>EPL Condition</b>	<b>Requirement</b>	<b>Report Reference</b>
M1.1	Monitor and record hourly temperature, humidity, wind velocity and rainfall	Section 3.1 Appendix A-1
L4.8	Monitoring to validate the noise predictions for works undertaken outside of the standard construction hours as per the construction noise impact assessment	Section 3.2 Appendix A-2
M4.2	Noise monitoring of noise and vibration complaints	Section 3.2 Appendix A-2
M3.3	Noise and vibration monitoring as directed by an authorised officer of the EPA	Section 3.2 Appendix A-2
P1	Discharge of pollutants to water from nominated discharge points	Section 3.3 Appendix A-3
L2.4	Discharge from sediment basins solely as a result of rainfall measured as a result of rainfall exceeding the rainfall depth value	Section 3.3 Appendix A-3

# 3. Monitoring

Section 3 present a summary of the monitoring programs completed in the reporting period from 26 October 2020 to 25 November 2020.

Detailed monitoring results for each program are presented in the Appendices.

## 3.1. Meteorological Data

4. The total rainfall during the reporting period was 100.8mm with twelve days with over 1mm of rain. One rain event exceeded the 80<sup>th</sup> percentile (25.8mm) and the 85<sup>th</sup> percentile (33.1mm).

5. During the reporting period, there were 30 days where the maximum wind gust recorded was greater than 25km/hr and two days where the maximum wind gust recorded was greater than 50km/hr. There was a total of 21 days where wind speeds greater than 25km/hr were forecast and on each of those days, notifications were issued to the construction team to alert them of the strong winds forecast.

6. A summary of the weather observations and weather events during the reporting period of relevance to the Soil and Water Management Sub-plan and Air Quality Management Sub-Plan Trigger Action Response Plans (TARPs) are summarised in **Table 7-2**. A comparison between long term monthly means and recorded values can be found in

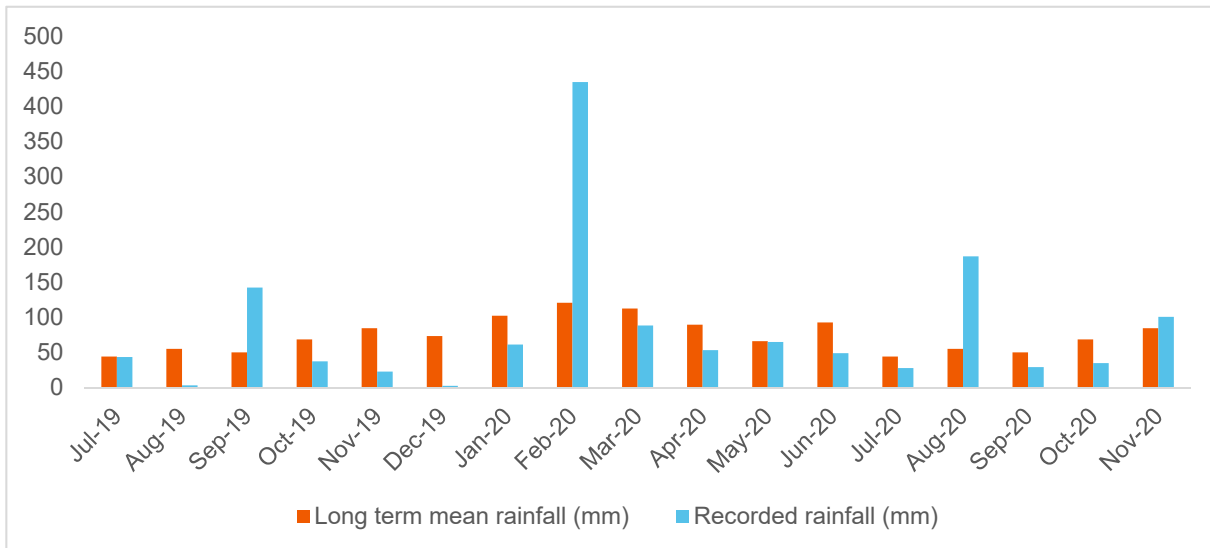

**Figure 3-2.**

Detailed weather observation records for November 2020 are presented in **Appendix A-1**.

**Table 3-1 Weather Summary and Trigger Weather Events for November<sup>1</sup> 2020**

Weather Event	Forecast	Observation
Minimum temperature	10°C	9°C
Maximum temperature	39°C	38.3°C
Total rainfall	114.2mm	100.8mm
Number of days with rain (>1mm)	10 days	12 days



Weather Event	Forecast	Observation
>80 <sup>th</sup> percentile (25.8mm) rain events	1 day	1 day
Flood warning / events	No events	No events
>25km/hr wind <sup>2</sup>	21 days	27 days
>50km/hr wind	1 day	2 day

7. <sup>1</sup>Weather summary based on data from the 26 October to 25 November (31 days).

8. <sup>2</sup>Wind data from Sydney Olympic Park AWS (Archery Centre) {station 066212}. Weather data from Parramatta North (Masons Drive) {station 066124}.

9. Note: Red text indicates observation greater than forecast.

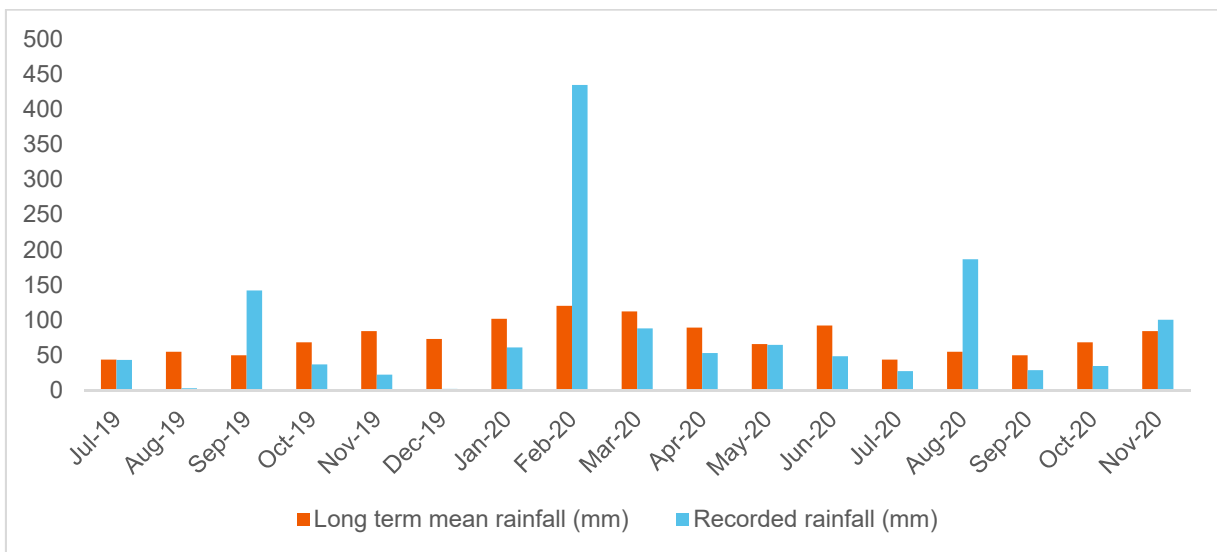

Figure 3-1 Monthly rainfall comparison

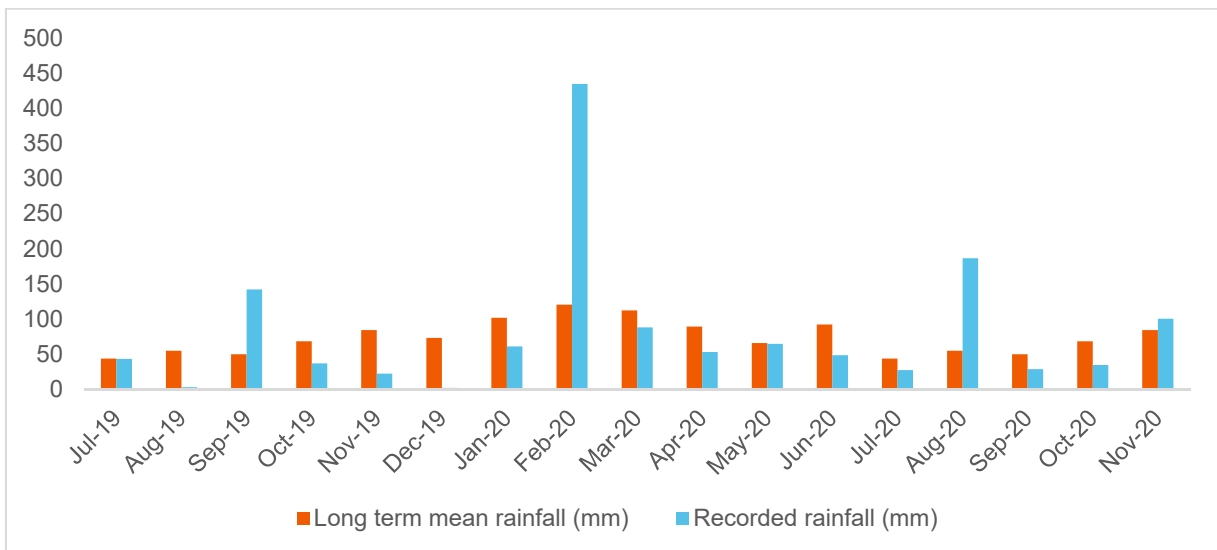

Figure 3-2 Monthly rain days comparison



## 9.1. Noise

Noise monitoring is a requirement of the following conditions of EPL 21347:

- L4.8 Monitoring to validate the noise predictions for works undertaken outside of the standard construction hours as per the construction noise impact assessment
- M4.2 Noise monitoring following noise and vibration complaints
- M3.3 Noise and vibration monitoring as directed by an authorised officer of the EPA.

**Table 3-3** provides a summary of noise monitoring events completed during the reporting period. Detailed noise monitoring results and comments are presented in **Appendix A-2**.

Continuous noise monitoring was ongoing throughout the reporting period at medical facilities in Westmead that have been identified as sensitive receivers. In consultation with the Health Administration Corporation, monitoring will be ongoing for twelve months. Locations of the noise and vibration monitors are provided in **Table 3-4**.

**Table 3-2 Summary of Noise Monitoring November 2020**

Date	Monitoring Location	Attended/Continuous	Description
02/11/2020	15B Albert St	Attended	Construction noise audible at most times
02/11/2020	459 Church St	Attended	Construction noise audible at most times
11/11/2020	89 Marshall Rd	Attended	Construction noise audible at most times
11/11/2020	Carlingford Station	Attended	Construction noise audible at most times
11/11/2020	22 Adderton Road	Attended	Construction noise clearly audible
11/11/2020	14 Dudley St	Attended	Construction noise sometimes audible
11/11/2020	Dundas Station	Attended	Construction noise sometimes audible
11/11/2020	Teloopa Station	Attended	Construction noise is dominant noise source
20/11/2020	Top of the Merion wall	Attended	Construction noise audible at most times
21/11/2020	101c James Ruse Drive	Attended	Construction noise audible at most times
21/11/2020	20 Victoria Road	Attended	Construction noise is dominant noise source
26/06/2020 -ongoing	Westmead Institute for Medical Research (Sleep Lab)	Continuous	General construction
26/06/2020 -ongoing	Westmead Institute for Medical Research (Brain Dynamics Centre)	Continuous	General construction



Date	Monitoring Location	Attended/Continuous	Description
26/06/2020 -ongoing	Children's Medical Research Institute (Microscopy Labs)	Continuous	General construction
26/06/2020 -ongoing	Cumberland Hospital (Clinical psychology rooms)	Continuous	General construction

**Table 3-4 HAC Noise Monitor Locations**

Organisation	Monitor Type	Location
Westmead Institute for Medical Research	Noise Monitor	Sleep Lab
		Brain Dynamics Centre
Children's Medical Research Institute	Noise Monitor	Labs (Level 1)
Cumberland Hospital	Noise Monitor	Clinical psychology rooms

## 9.2. Discharge to water

The EPL discharge criteria apply to the sediment basins and settling containers identified and located in the document titled "Parramatta Light Rail Package 4 Discharge Point Register" and maintained on electronic file EF19/29672. The active basins and discharge points during the reporting period are summarised in **Table A-3-1**.

**Table A-3-2** provides a summary of the discharges by Parramatta Connect at the current active monitoring/discharge point or utilisation area that complied with condition L2.1. There were four discharges during the reporting period.

**Table A-3-3** provides a summary of discharge events that occurred solely as a result of rainfall measured at the premises, exceeding the design rainfall depth value for the corresponding discharge point. There were no discharge events as a result of rainfall exceeding the designed water depth value during the reporting period.



## 10. Correction log

It is possible from time to time that incorrect data be get published in good faith.

As soon as practicable after the licensee becomes aware that the published pollution monitoring data is incorrect or misleading, licensees must then publish a correction log to correct this data that is incorrect or misleading.

There are no matters included in the correction log for this reporting period.



# Appendices

## A-1 Weather Observations

Table A-1-1 Weather Observations: Parramatta North (Masons Drive) {station 066124}.

Date	Temperatures		Rain	Temp	RH	9:00 AM		
	Min	Max				Cld	Dir	Spd
	°C	°C	mm	°C	%	8th	km/h	
26/10/2020	12	14.9	26	15	84	8	SSW	30
27/10/2020	11.5	20.3	13.4	14	97	8	S	9
28/10/2020	12.3	20.8	0.2	16.3	79	8	SW	2
29/10/2020	13.6	22.4	12	15	98	8	SW	4
30/10/2020	9.4	22.7	0.8	19	72	6	ESE	2
31/10/2020	12.7	25.2	2.8	18.2	93	8	ENE	2
1/11/2020	12.2	19.7	11.2	17.8	79	8	SW	6
2/11/2020	12.8	21.8	4	18	75	6	SW	6
3/11/2020	10.2	23.4	0	18.8	65	5	SE	4
4/11/2020	10.2	28.8	0	18.4	71	4	NNW	2
5/11/2020	14.3	16.2	3.6	15	94	8	SE	9
6/11/2020	12.3	20.5	17.6	16.2	65	7	SW	11
7/11/2020	9.5	20.6	0	18.8	65	4	SW	6
8/11/2020	13	21.3	0	18	51	5	ENE	6
9/11/2020	12.6	21.8	0	16.8	77	7	E	4
10/11/2020	9	23.7	0	18	66	4	NW	6
11/11/2020	11.2	27.7	0	20.8	71	2	NNE	2
12/11/2020	14.6	31.3	0	23.3	67	5	NW	6
13/11/2020	17.8	28	1.4	24.5	68	8	NW	6
14/11/2020	13.3	27.2	0.4	21.2	65	0	WSW	6
15/11/2020	13	31.5	0	22.5	66	0	W	4
16/11/2020	16	38.3	0	25.8	66	6	SW	4
17/11/2020	16.6	23.6	0	21.5	66	6	SSE	7
18/11/2020	15.8	24.2	0.4	19.8	74	7	E	4
19/11/2020	12	26.8	0	21.7	70	5	NW	4
20/11/2020	15.8	37	0	24.8	72	2	NNW	4
21/11/2020	16.8	25.3	0.6	21	72	7	SSE	6
22/11/2020	16	29.7	1.4	22.5	66	4	NNW	4
23/11/2020	20.3	25.3	3.4	22.3	93	7	W	2
24/11/2020	14.5	23.8	1.6	20.7	73	7	SSE	7
25/11/2020	16.3	24.9	1	19.5	85	8	NW	2





**Table A-1-2 Wind Observations: Sydney Olympic Park AWS (Archery Centre) {station 066212}.**

Date	Maximum Wind Gusts			9:00 AM		3:00 PM	
	Direction	Speed	Time	Direction	Speed	Direction	Speed
		km/h	local		km/h		km/h
26/10/2020	SSE	54	4:54	S	20	SSE	20
27/10/2020	SE	35	11:34	SSW	9	SSE	17
28/10/2020	ESE	30	15:30	W	9	SE	15
29/10/2020	ESE	30	10:19	NW	7	SE	15
30/10/2020	E	33	15:39	WNW	2	E	17
31/10/2020	SSE	37	13:30	ESE	9	SSW	11
1/11/2020	S	50	13:57	WSW	9	S	28
2/11/2020	SSE	33	9:29	SSW	15	SE	15
3/11/2020	E	26	13:05	W	4	E	17
4/11/2020	E	26	15:01	NNW	7	E	11
5/11/2020	SSE	35	10:19	SE	20	SSW	17
6/11/2020	S	33	9:19	SW	11	ESE	17
7/11/2020	SE	46	14:38	NW	7	SSE	22
8/11/2020	ESE	28	12:13	SSE	9	ESE	19
9/11/2020	ESE	28	14:28	E	7	E	15
10/11/2020	ESE	31	13:31	WNW	6	E	19
11/11/2020	E	31	15:39	NNE	7	E	17
12/11/2020	WNW	41	22:38	NNW	7	NNW	19
13/11/2020	W	48	14:32	NNE	9	NNW	9
14/11/2020	ESE	28	16:02	W	7	E	15
15/11/2020	E	31	15:18	WNW	7	ESE	19
16/11/2020	WNW	46	13:54	*	Calm	WNW	20
17/11/2020	SSE	39	23:41	SE	11	E	20
18/11/2020	ESE	30	12:57	ENE	11	E	15
19/11/2020	NE	31	16:24	NNE	4	NE	13
20/11/2020	SSE	35	19:25	SE	6	E	15
21/11/2020	ESE	31	11:47	SSE	15	SE	15
22/11/2020	E	17	11:52	NNW	6	SE	11
23/11/2020	W	31	2:53	WNW	6	NNW	11
24/11/2020	SSE	35	8:09	S	11	SE	20
25/11/2020	NE	28	18:22	NNW	4	ENE	9

Notes: Blue text indicates a rain event greater than 1mm of rain.

The orange text indicates a rain event greater than the 80th percentile of 25.8mm, and a wind speed of greater than 25km/hr

Red text indicates a rain event greater than the 85<sup>th</sup> percentile of 33.1mm, and a wind speed greater than 50km/hr.

\* No data.

## A-2 Noise Monitoring Results

Table A-2-1 Noise Monitoring Results

Date	Time	Works Period	Construction Activity	Activity Location	Monitoring Location	NML (dBA)	Predicted (dBA)	Additional Mitigation Measures	L <sub>Amax</sub>	Recorded L <sub>eq, 15min</sub> (dBA)	Exceedance of Predicted (dBA)	Exceedance of Predicted	Comments
02/11/2020	22:00	OOHW Period 1	Electrical Trenching	15B Albert St	15B Albert St	64	98	PN, V	65.2	56	-42	N/A	Construction noise audible at most times
02/11/2020	22:00	OOHW Period 1	Electrical Trenching	100m from monitoring location	459 Church St	64	98	PN, V	80	61	-37	N/A	Construction noise audible at most times
11/11/2020	12:19	Standard Hours	Victoria Rd deflection wall	Victoria Road intersection	14 Dudley Street	53	-	-	77	60	-	N/A	Construction noise sometimes audible
11/11/2020	11:33	Standard Hours	Excavation for drainage	Adderton Road	22 Adderton Road	61	-	-	77.1	65.6	-	N/A	Construction noise clearly audible
11/11/2020	-	Standard Hours	Combined service route	Marshall and Brand Road	89 Marshall Road	55	-	-	68.2	48.6	-	N/A	Construction noise audible at most times
11/11/2020	10:07	Standard Hours	Excavation for drainage	Boundary Road	Carlingford Station	56	-	-	73.9	59.4	-	N/A	Construction noise audible at most times
11/11/2020	11:56	Standard Hours	Retaining wall form retain pour	Dundas wall	Dundas Station	61	-	-	72.2	58.3	-	N/A	Construction noise sometimes audible
11/11/2020	11:07	Standard Hours	Piling for retaining pour	Teloepa	Teloepa Station	61	-	-	86.3	68.6	-	N/A	Construction noise is dominant noise source
20/11/2020	15:00	Standard Hours	Excavation and backfill	Parramatta River foreshore	Top of the Merion wall	68	81	PV, N	94.8	69.0	-12	No	Construction noise audible at most times
21/11/2020	13:38	Standard Hours	Lifting girders	Grand Ave North	101c James Ruse Drive	45	64	V	89.7	50.3	-13.7	No	Construction noise audible at most times
21/11/2020	14:00	Standard Hours	Lean mix placement excavation, saw	Victoria Road intersection	20 Victoria Road	64	103	PN, V, RP, SN, DR, RO	73.2	67.4	-35.6	No	Construction noise is dominant noise source
26/06/2020 - ongoing	Continuous monitoring	Construction works	Hawkesbury Road works	Westmead Institute for Medical Research (Sleep Lab)		40	*	*	*	*	*	No	Activities are reviewed in response to exceedance alerts. Where the exceedance is attributed to construction, a review is undertaken of works and plant/equipment or methodology is modified where necessary.
26/06/2020 - ongoing	Continuous monitoring	Construction works	Hawkesbury Road works	Westmead Institute for Medical Research (Brain Dynamics Centre)		60	*	*	*	*	*	No	
26/06/2020 - ongoing	Continuous monitoring	Construction works	Hawkesbury Road works	Children's Medical Research Institute (Microscopy Labs)		60	*	*	*	*	*	No	
26/06/2020 - ongoing	Continuous monitoring	Construction works	Cumberland Hospital	Cumberland Hospital (Clinical psychology rooms)		60	*	*	*	*	*	No	

Notes:

**Standard hours:**

- All areas excluding Eat Street and Camellia – Monday to Friday 7:00 am to 7:00 pm. Saturday 8:00 am to 6:00 pm
- Eat Street (Church Street between Palmer Street and George Street) – Monday to Friday 7:00 am to 6:00 pm. Saturday 8:00 am to 12:00 pm)
- Camellia, Rosehill and Rydalmere (east of James Ruse Drive to Victoria Road) – 24 hours a day and seven days a week provided that sensitive receivers are not affected by noise levels of greater than 5 dBA above the rating background level at any residence

**OOHW Period 1** is defined as:

- a) 6:00pm to 10:00pm (evenings) Monday to Saturday
- a) 7:00am to 8:00am and 1:00pm to 10:00pm (day & evening) Saturday and
- b) 8:00am to 6:00pm Sunday and public holidays (days).

**OOHW Period 2** is defined as:

- b) 10:00pm to 7:00am (nights) Monday to Saturday and
- c) 6:00pm to 8:00am (nights) Sundays and public holidays.

**Additional Mitigation Measures**

PN = Project Notification

V = Verification Monitoring

RP = Respite Period

AA = Alternate Accommodation

SN = Specific Notification / individual briefing or phone call

DR = Duration Reduction

RO = Project Specific Respite Offer



## A-3 Discharge to water

Table A-3-1 Parramatta Light Rail Package 4 Discharge Point Register (electronic file EF19/29672) (Rev 11, submitted 15<sup>th</sup> of October 2020)

ID	Construction Status	Easting	Northing	AMG Zone	Reference System	Description of location of discharge point	Catchment name	Name of nearest waters	Direct discharge to waters	Total catchment area of basin (ha)	Basin size (operational) m <sup>3</sup>	Blue Book Criteria	Location description	Date added	Revision Added
A2.01	Active	315250	6256918	56	MGA	Existing stormwater pit on Church St, 40m north of the Phillip St intersection	Parramatta River	Parramatta River	No	N/A	N/A	N/A	N/A	24/02/2020	Rev 1
A2.02	Active	315231	6256879	56	MGA	Existing stormwater pit on the northwest corner of the intersection of Phillip St and Church St	Parramatta River	Parramatta River	No	N/A	N/A	N/A	N/A	24/02/2020	Rev 1
A2.03	Active	315229	6256871	56	MGA	Existing stormwater pit on the southwest corner of the intersection of Phillip St & Church St	Parramatta River	Parramatta River	No	N/A	N/A	N/A	N/A	16/03/2020	Rev 2
A2.04	Active	315204	6256552	56	MGA	Existing stormwater pit on Macquarie Street, near United Lane	Parramatta River	Parramatta River	No	N/A	N/A	N/A	N/A	27/04/2020	Rev 04
A2.05	Active	315211	6256550	56	MGA	Existing stormwater pit on Macquarie Street, near United Lane	Parramatta River	Parramatta River	No	N/A	N/A	N/A	N/A	27/04/2020	Rev 04
A2.06	Active	315266	6256546	56	MGA	Existing stormwater pit on Horwood Place (West), near Macquarie Street	Parramatta River	Parramatta River	No	N/A	N/A	N/A	N/A	27/04/2020	Rev 04
A2.07	Active	315277	6256543	56	MGA	Existing stormwater pit on Horwood Place (East), near Macquarie Street	Parramatta River	Parramatta River	No	N/A	N/A	N/A	N/A	27/04/2020	Rev 04
A2.08	Active	315315	6256514	56	MGA	Existing stormwater pit on Macquarie Street, near Leigh Memorial Church and Civic Place	Parramatta River	Parramatta River	No	N/A	N/A	N/A	N/A	27/04/2020	Rev 04
A2.09	Active	315404	6256506	56	MGA	Existing stormwater pit on Macquarie Street, East of Smith Street intersection	Parramatta River	Parramatta River	No	N/A	N/A	N/A	N/A	27/04/2020	Rev 04
A2.10	Active	315433	6256477	56	MGA	Existing stormwater pit at the intersection of Macquarie Street and Smith Street (South West corner)	Parramatta River	Parramatta River	No	N/A	N/A	N/A	N/A	27/04/2020	Rev 04
A2.11	Active	315516	6256504	56	MGA	Existing stormwater pit at the north end of Barrack Lane	Parramatta River	Parramatta River	No	N/A	N/A	N/A	N/A	27/04/2020	Rev 04
A2.12	Active	315692	6256429	56	MGA	Existing Stormwater pit on Macquarie Street at Charles Street intersection (North-West corner)	Parramatta River	Parramatta River	No	N/A	N/A	N/A	N/A	27/04/2020	Rev 04
A2.13	Active	315685	6256422	56	MGA	Existing Stormwater pit on Macquarie Street at Charles Street intersection (South-West corner)	Parramatta River	Parramatta River	No	N/A	N/A	N/A	N/A	27/04/2020	Rev 04
A2.14	Active	316007	6256445	56	MGA	Existing stormwater pit on eastern side of Harris Street. Opposite Albion Hotel.	Parramatta River	Parramatta River	No	N/A	N/A	N/A	N/A	28/05/2020	Rev 05
A2.15	Active	316004	6256435	56	MGA	Existing stormwater pit on eastern side of Harris Street. Opposite Albion Hotel exit driveway.	Parramatta River	Parramatta River	No	N/A	N/A	N/A	N/A	28/05/2020	Rev 05
A2.15	Active	316000	6256418	56	MGA	Existing stormwater pit on eastern side of Harris Street. Opposite Albion Hotel carpark.	Parramatta River	Parramatta River	No	N/A	N/A	N/A	N/A	28/05/2020	Rev 05
A2.15	Active	315980	6256389	56	MGA	Existing stormwater pit on western side of Harris Street. South of Albion Hotel entry driveway.	Parramatta River	Parramatta River	No	N/A	N/A	N/A	N/A	28/05/2020	Rev 05
A2.15	Active	315989	6256383	56	MGA	Existing stormwater pit on eastern side of Harris Street. Opposite empty corner lot.	Parramatta River	Parramatta River	No	N/A	N/A	N/A	N/A	28/05/2020	Rev 05
A2.15	Active	315975	6256365	56	MGA	Existing stormwater pit on western side of Harris St. Just north of intersection with Macquarie Street.	Parramatta River	Parramatta River	No	N/A	N/A	N/A	N/A	28/05/2020	Rev 05
A2.15	Active	315984	6256361	56	MGA	Existing stormwater pit on eastern side of Harris Street. Opposite Northern footpath of Macquarie Street.	Parramatta River	Parramatta River	No	N/A	N/A	N/A	N/A	28/05/2020	Rev 05
A2.15	Active	315984	6256344	56	MGA	Existing stormwater pit on eastern side of Harris Street. In pedestrian crossing of Harris Street.	Parramatta River	Parramatta River	No	N/A	N/A	N/A	N/A	28/05/2020	Rev 05
A2.15	Active	315970	6256347	56	MGA	Existing stormwater pit on eastern side of Harris Street. In pedestrian crossing of Harris Street.	Parramatta River	Parramatta River	No	N/A	N/A	N/A	N/A	28/05/2020	Rev 05
A2.15	Active	315969	6256344	56	MGA	Existing stormwater pit on eastern side of Harris Street. Just south of pedestrian crossing of Harris Street.	Parramatta River	Parramatta River	No	N/A	N/A	N/A	N/A	28/05/2020	Rev 05
A2.15	Active	315948	6256282	56	MGA	Existing stormwater pit at intersection of Hassall Street and Harris Street. On northern side of Hassall Street.	Parramatta River	Parramatta River	No	N/A	N/A	N/A	N/A	28/05/2020	Rev 05
A2.15	Active	315848	6256392	56	MGA	Existing stormwater pit on northern side of Macquarie Street. Just east of Argus Lane.	Parramatta River	Parramatta River	No	N/A	N/A	N/A	N/A	28/05/2020	Rev 05
A2.15	Active	315841	6256383	56	MGA	Existing stormwater pit on southern side of Macquarie Street. Opposite Argus Lane.	Parramatta River	Parramatta River	No	N/A	N/A	N/A	N/A	28/05/2020	Rev 05
A2.15	Active	315826	6256386	56	MGA	Existing stormwater pit on southern side of Macquarie Street. Opposite Endeavour Energy building.	Parramatta River	Parramatta River	No	N/A	N/A	N/A	N/A	28/05/2020	Rev 05
A2.15	Active	315820	6256388	56	MGA	Existing stormwater pit on southern side of Macquarie Street. Opposite Endeavour Energy building.	Parramatta River	Parramatta River	No	N/A	N/A	N/A	N/A	28/05/2020	Rev 05

ID	Construction Status	Easting	Northing	AMG Zone	Reference System	Description of location of discharge point	Catchment name	Name of nearest waters	Direct discharge to waters	Total catchment area of basin (ha)	Basin size (operational) m3	Blue Book Criteria	Location description	Date added	Revision Added
A2.15	Active	315828	6256396	56	MGA	Existing stormwater pit on northern side of Macquarie Street. In front of Endeavour Energy building.	Parramatta River	Parramatta River	No	N/A	N/A	N/A	N/A	28/05/2020	Rev 05
A2.15	Active	315796	6256393	56	MGA	Existing stormwater pit on southern side of Macquarie Street. In front of 187 Macquarie Street.	Parramatta River	Parramatta River	No	N/A	N/A	N/A	N/A	28/05/2020	Rev 05
A2.15	Active	315773	6256398	56	MGA	Existing stormwater pit on southern side of Macquarie Street. In front of 183 Macquarie Street.	Parramatta River	Parramatta River	No	N/A	N/A	N/A	N/A	28/05/2020	Rev 05
A2.15	Active	315776	6256408	56	MGA	Existing stormwater pit on southern side of Macquarie Street. In front of driveway for 128-138 Macquarie Street.	Parramatta River	Parramatta River	No	N/A	N/A	N/A	N/A	28/05/2020	Rev 05
A3.18	Active	317220	6256123	56	MGA	Discharges into existing stormwater line at Sandown Lane flowing towards Parramatta River.	Parramatta River	Parramatta River	Yes	N/A	N/A	N/A	Connection of new drainage to existing stormwater	24/02/2020	Rev 2
A3.19	Active	317845	6256065	56	MGA	Discharges into existing stormwater line at Sandown Lane flowing towards Parramatta River.	Parramatta River	Parramatta River	Yes	N/A	N/A	N/A	Connection of new drainage to existing stormwater	24/02/2020	Rev 2
A3.21	Active	317837	6255954	56	MGA	Discharge into local stormwater system at Grand Avenue	Parramatta River	Parramatta River	Yes	N/A	N/A	N/A	Discharge into existing drainage	18/06/2020	Rev 6
A3.3	Active	317527	6257074	56	MGA	On eastern side of rail corridor adjacent to WSU. Discharges into Vineyard Creek.	Parramatta River	Vineyard Creek	Yes	N/A	N/A	N/A	Outlet headwall for new drainage	24/02/2020	Rev 2
A3.4	Active	317518	6257093	56	MGA	On western side of rail corridor adjacent to WSU. Discharges into Vineyard Creek.	Parramatta River	Vineyard Creek	Yes	N/A	N/A	N/A	Outlet headwall for new drainage	24/02/2020	Rev 2
A3.20	Active	316821	625304	56	MGA	Discharge into Clay Cliff Creek at Camellia / Parramatta, which flows towards Parramatta River	Parramatta River	Clay Cliff Creek	Yes	N/A	N/A	N/A	Discharge into existing creek	8/04/2020	Rev 3
A3.21	Active	317837	6255954	56	MGA	Discharge into local stormwater system at Grand Avenue	Parramatta River	Parramatta River	Yes	N/A	N/A	N/A	Discharge into existing drainage	18/06/2020	Rev06
A3.22	Active	318547	6258704	56	MGA	Discharge into local stormwater system at Adderton Road, Telopea	Parramatta River	Vineyard Creek	Yes	N/A	N/A	Yes	Discharge into stormwater	29/07/2020	Rev07
A3.23	Active	317610	6257192	56	MGA	Discharge into local stormwater system at Brodie Street, Rydalmere	Parramatta River	Vineyard Creek	Yes	N/A	744	Yes	Discharge into stormwater	12/08/2020	Rev08
A3.24	Active	318526	6258711	56	MGA	Discharge into local stormwater system at Adderton Road, Telopea	Parramatta River	Subiaco Creek	Yes	N/A	N/A	Yes	Discharge into stormwater	12/08/2020	Rev08
A3.25	Active	319050	6260064	56	MGA	Discharge into local stormwater system at Kenny Place, Carlingford	Parramatta River	The Ponds Creek	Yes	N/A	N/A	Yes	Discharge into stormwater	12/08/2020	Rev08
A1.1	Active	313690.7 262	6257310.8 58	56	MGA	Discharge into local stormwater system at Hawkesbury Rd, Westmead	Parramatta River	Parramatta River	Yes	N/A	N/A	Yes	Discharge into stormwater	18/09/2020	Rev09
A1.2	Active	313696.9 333	6257311.0 7	56	MGA	Discharge into local stormwater system at Hawkesbury Rd, Westmead	Parramatta River	Parramatta River	Yes	N/A	N/A	Yes	Discharge into stormwater	18/09/2020	Rev09
A1.3	Active	313682.1 272	6257330.9 14	56	MGA	Discharge into local stormwater system at Hawkesbury Rd, Westmead	Parramatta River	Parramatta River	Yes	N/A	N/A	Yes	Discharge into stormwater	18/09/2020	Rev09
A1.4	Active	313716.1 421	6257363.3 57	56	MGA	Discharge into local stormwater system at Hawkesbury Rd, Westmead	Parramatta River	Parramatta River	Yes	N/A	N/A	Yes	Discharge into stormwater	18/09/2020	Rev09
A1.5	Active	313698.5 05	6257374.3 79	56	MGA	Discharge into local stormwater system at Hawkesbury Rd, Westmead	Parramatta River	Parramatta River	Yes	N/A	N/A	Yes	Discharge into stormwater	18/09/2020	Rev09
A1.6	Active	313741.9 761	6257404.6 16	56	MGA	Discharge into local stormwater system at Hawkesbury Rd, Westmead	Parramatta River	Parramatta River	Yes	N/A	N/A	Yes	Discharge into stormwater	18/09/2020	Rev09
A1.7	Active	313730.6 36	6257423.8 3	56	MGA	Discharge into local stormwater system at Hawkesbury Rd, Westmead	Parramatta River	Parramatta River	Yes	N/A	N/A	Yes	Discharge into stormwater	18/09/2020	Rev09
A1.8	Active	313752.6 865	6257450.2 89	56	MGA	Discharge into local stormwater system at Hawkesbury Rd, Westmead	Parramatta River	Parramatta River	Yes	N/A	N/A	Yes	Discharge into stormwater	18/09/2020	Rev09
A1.9	Active	313763.4 021	6257465.7 24	56	MGA	Discharge into local stormwater system at Hawkesbury Rd, Westmead	Parramatta River	Parramatta River	Yes	N/A	N/A	Yes	Discharge into stormwater	18/09/2020	Rev09
A1.10	Active	313824.5 051	6257536.5 96	56	MGA	Discharge into local stormwater system at Hawkesbury Rd, Westmead	Parramatta River	Parramatta River	Yes	N/A	N/A	Yes	Discharge into stormwater	18/09/2020	Rev09
A2.33	Active	316277	6256349	56	MGA2020	Existing stormwater pit on Western side of Purchase Street @ 15m South of junction with George Street.	Parramatta River	Parramatta River	No	N/A	N/A	N/A	N/A	8/10/2020	Rev 10
A2.34	Active	316286	256350	56	MGA2020	Existing stormwater pit on Eastern side of Purchase Street @ 12m South of junction with George Street.	Parramatta River	Parramatta River	No	N/A	N/A	N/A	N/A	8/10/2020	Rev 10
A2.35	Active	316304	6256353	56	MGA2020	Existing stormwater pit on southern side of George Street opposite 1A Noller Parade.	Parramatta River	Parramatta River	No	N/A	N/A	N/A	N/A	8/10/2020	Rev 10

ID	Construction Status	Easting	Northing	AMG Zone	Reference System	Description of location of discharge point	Catchment name	Name of nearest waters	Direct discharge to waters	Total catchment area of basin (ha)	Basin size (operational) m3	Blue Book Criteria	Location description	Date added	Revision Added
A2.36	Active	316289	6256332	56	MGA2020	Existing stormwater pit on George Street Southern Slip lane, on Southern side of the carriageway, @ 8m East of junction with Purchase Street	Parramatta River	Parramatta River	No	N/A	N/A	N/A	N/A	8/10/2020	Rev 10
A2.37	Active	316452	6256193	56	MGA2020	Existing stormwater pit on northern side of Hassall Street at North Western corner of junction with Alfred Street	Parramatta River	Parramatta River	No	N/A	N/A	N/A	N/A	8/10/2020	Rev 10
A2.38	Active	316437	6256192	56	MGA2020	Existing stormwater pit on northern side of Hassall Street @ 15m West of junction with Alfred Street	Parramatta River	Parramatta River	No	N/A	N/A	N/A	N/A	8/10/2020	Rev 10
A2.39	Active	316486	6256188	56	MGA2020	Existing stormwater pit on northern side of Hassall Street at North Eastern corner of junction with Alfred Street	Parramatta River	Parramatta River	No	N/A	N/A	N/A	N/A	8/10/2020	Rev 10
A2.40	Active	316502	6256186	56	MGA2020	Existing stormwater pit on northern side of Hassall Street @ 15m East of junction with Alfred Street	Parramatta River	Parramatta River	No	N/A	N/A	N/A	N/A	8/10/2020	Rev 10
A2.41	Active	316605	6256342	56	MGA2020	Existing stormwater pit on Southern side of Tramway Avenue	Parramatta River	Clay Cliff Creek	No	N/A	N/A	N/A	N/A	8/10/2020	Rev 10
A2.42	Active	316620	6256350	56	MGA2020	Existing stormwater pit on Northern side of Tramway Avenue	Parramatta River	Clay Cliff Creek	No	N/A	N/A	N/A	N/A	8/10/2020	Rev 10
A2.43	Active	316640	6256345	56	MGA2020	Existing stormwater pit on Northern side of Tramway Avenue	Parramatta River	Clay Cliff Creek	No	N/A	N/A	N/A	N/A	8/10/2020	Rev 10
A2.44	Active	316659	6256340	56	MGA2020	Existing stormwater pit on Northern side of Tramway Avenue	Parramatta River	Clay Cliff Creek	No	N/A	N/A	N/A	N/A	8/10/2020	Rev 10
A2.45	Active	316677	6256335	56	MGA2020	Existing stormwater pit on Northern side of Tramway Avenue	Parramatta River	Clay Cliff Creek	No	N/A	N/A	N/A	N/A	8/10/2020	Rev 10
A2.46	Active	316714	6256325	56	MGA2020	Existing stormwater pit on Northern side of Tramway Avenue	Parramatta River	Clay Cliff Creek	No	N/A	N/A	N/A	N/A	8/10/2020	Rev 10
A2.47	Active	316721	6256330	56	MGA2020	Existing stormwater pit on Western Side of Arthur Street	Parramatta River	Clay Cliff Creek	No	N/A	N/A	N/A	N/A	8/10/2020	Rev 10
A2.48	Active	316710	6256313	56	MGA2020	Existing stormwater pit on Southern side of Tramway Avenue	Parramatta River	Clay Cliff Creek	No	N/A	N/A	N/A	N/A	8/10/2020	Rev 10
A2.49	Active	316715	6256306	56	MGA2020	Existing stormwater pit on Western Side of Arthur Street	Parramatta River	Clay Cliff Creek	No	N/A	N/A	N/A	N/A	8/10/2020	Rev 10
A1.11	Active	315019	6258079	56	MGA2020	Existing Stormwater Pit on Factory St	Parramatta River	Parramatta River	No	N/A	N/A	N/A	N/A	15/10/2020	Rev 11
A1.12	Active	315037	6258090	56	MGA2020	Existing Stormwater Pit on Factory St	Parramatta River	Parramatta River	No	N/A	N/A	N/A	N/A	15/10/2020	Rev 11
A1.13	Active	315027	6258097	56	MGA2020	Existing Stormwater Pit on Factory St	Parramatta River	Parramatta River	No	N/A	N/A	N/A	N/A	15/10/2020	Rev 11
A1.14	Active	315042	6258104	56	MGA2020	Existing Stormwater Pit on Factory St	Parramatta River	Parramatta River	No	N/A	N/A	N/A	N/A	15/10/2020	Rev 11
A1.15	Active	315034	6258108	56	MGA2020	Existing Stormwater Pit on Factory St	Parramatta River	Parramatta River	No	N/A	N/A	N/A	N/A	15/10/2020	Rev 11
A1.16	Active	315072	6258108	56	MGA2020	Existing Stormwater Pit on Factory St	Parramatta River	Parramatta River	No	N/A	N/A	N/A	N/A	15/10/2020	Rev 11
A1.17	Active	315083	6258114	56	MGA2020	Existing Stormwater Pit on Factory St	Parramatta River	Parramatta River	No	N/A	N/A	N/A	N/A	15/10/2020	Rev 11
A1.18	Active	315104	6258124	56	MGA2020	Existing Stormwater Pit on Factory St	Parramatta River	Parramatta River	No	N/A	N/A	N/A	N/A	15/10/2020	Rev 11
A1.19	Active	315132	6258153	56	MGA2020	Existing Stormwater Pit on Factory St	Parramatta River	Parramatta River	No	N/A	N/A	N/A	N/A	15/10/2020	Rev 11
A1.20	Active	315138	6258153	56	MGA2020	Existing Stormwater Pit on Factory St	Parramatta River	Parramatta River	No	N/A	N/A	N/A	N/A	15/10/2020	Rev 11
A1.21	Active	315168	6258170	56	MGA2020	Existing Stormwater Pit on Factory St	Parramatta River	Parramatta River	No	N/A	N/A	N/A	N/A	15/10/2020	Rev 11
A1.22	Active	315197	6258171	56	MGA2020	Existing Stormwater Pit on Factory St	Parramatta River	Parramatta River	No	N/A	N/A	N/A	N/A	15/10/2020	Rev 11
A1.23	Active	315215	6258175	56	MGA2020	Existing Stormwater Pit on Factory St	Parramatta River	Parramatta River	No	N/A	N/A	N/A	N/A	15/10/2020	Rev 11
A1.24	Active	315221	6258184	56	MGA2020	Existing Stormwater Pit on Factory St	Parramatta River	Parramatta River	No	N/A	N/A	N/A	N/A	15/10/2020	Rev 11
A1.25	Active	315228	6258200	56	MGA2020	Existing Stormwater Pit on Factory St	Parramatta River	Parramatta River	No	N/A	N/A	N/A	N/A	15/10/2020	Rev 11
A1.26	Active	315263	6258202	56	MGA2020	Existing Stormwater Pit on Church St	Parramatta River	Parramatta River	No	N/A	N/A	N/A	N/A	15/10/2020	Rev 11
A1.27	Active	315264	6258193	56	MGA2020	Existing Stormwater Pit on Church St	Parramatta River	Parramatta River	No	N/A	N/A	N/A	N/A	15/10/2020	Rev 11
A1.28	Active	315277	6258168	56	MGA2020	Existing Stormwater Pit on Church St	Parramatta River	Parramatta River	No	N/A	N/A	N/A	N/A	15/10/2020	Rev 11
A1.29	Active	315321	6258077	56	MGA2020	Existing Stormwater Pit on Church St	Parramatta River	Parramatta River	No	N/A	N/A	N/A	N/A	15/10/2020	Rev 11
A1.30	Active	315327	6258053	56	MGA2020	Existing Stormwater Pit on Church St	Parramatta River	Parramatta River	No	N/A	N/A	N/A	N/A	15/10/2020	Rev 11
A1.31	Active	315335	6258035	56	MGA2020	Existing Stormwater Pit on Church St	Parramatta River	Parramatta River	No	N/A	N/A	N/A	N/A	15/10/2020	Rev 11
A1.32	Active	315342	6258016	56	MGA2020	Existing Stormwater Pit on Church St	Parramatta River	Parramatta River	No	N/A	N/A	N/A	N/A	15/10/2020	Rev 11
A1.33	Active	315350	6257997	56	MGA2020	Existing Stormwater Pit on Church St	Parramatta River	Parramatta River	No	N/A	N/A	N/A	N/A	15/10/2020	Rev 11
A1.34	Active	315357	6257979	56	MGA2020	Existing Stormwater Pit on Church St	Parramatta River	Parramatta River	No	N/A	N/A	N/A	N/A	15/10/2020	Rev 11
A1.35	Active	315364	6257960	56	MGA2020	Existing Stormwater Pit on Church St	Parramatta River	Parramatta River	No	N/A	N/A	N/A	N/A	15/10/2020	Rev 11
A1.36	Active	315372	6257942	56	MGA2020	Existing Stormwater Pit on Church St	Parramatta River	Parramatta River	No	N/A	N/A	N/A	N/A	15/10/2020	Rev 11
A1.37	Active	315379	6257923	56	MGA2020	Existing Stormwater Pit on Church St	Parramatta River	Parramatta River	No	N/A	N/A	N/A	N/A	15/10/2020	Rev 11
A1.38	Active	315386	6257905	56	MGA2020	Existing Stormwater Pit on Church St	Parramatta River	Parramatta River	No	N/A	N/A	N/A	N/A	15/10/2020	Rev 11
A1.39	Active	315397	6257888	56	MGA2020	Existing Stormwater Pit on Church St	Parramatta River	Parramatta River	No	N/A	N/A	N/A	N/A	15/10/2020	Rev 11
A1.40	Active	315410	6257884	56	MGA2020	Existing Stormwater Pit on Albert St	Parramatta River	Parramatta River	No	N/A	N/A	N/A	N/A	15/10/2020	Rev 11
A1.41	Active	315406	6257870	56	MGA2020	Existing Stormwater Pit on Albert St	Parramatta River	Parramatta River	No	N/A	N/A	N/A	N/A	15/10/2020	Rev 11
A1.42	Active	315413	6257843	56	MGA2020	Existing Stormwater Pit on Albert St	Parramatta River	Parramatta River	No	N/A	N/A	N/A	N/A	15/10/2020	Rev 11
A1.43	Active	315395	6257512	56	MGA2020	Existing Stormwater Pit on Grose St	Parramatta River	Parramatta River	No	N/A	N/A	N/A	N/A	15/10/2020	Rev 11
A1.44	Active	315384	6257505	56	MGA2020	Existing Stormwater Pit on Grose St	Parramatta River	Parramatta River	No	N/A	N/A	N/A	N/A	15/10/2020	Rev 11
A1.45	Active	315403	6257390	56	MGA2020	Existing Stormwater Pit on Ross St	Parramatta River	Parramatta River	No	N/A	N/A	N/A	N/A	15/10/2020	Rev 11
A1.46	Active	315330	6257144	56	MGA2020	Existing Stormwater Pit on Market St	Parramatta River	Parramatta River	No	N/A	N/A	N/A	N/A	15/10/2020	Rev 11
A1.11	Active	315019	6258079	56	MGA2020	Existing Stormwater Pit on Factory St	Parramatta River	Parramatta River	No	N/A	N/A	N/A	N/A	15/10/2020	Rev 11

ID	Construction Status	Easting	Northing	AMG Zone	Reference System	Description of location of discharge point	Catchment name	Name of nearest waters	Direct discharge to waters	Total catchment area of basin (ha)	Basin size (operational) m3	Blue Book Criteria	Location description	Date added	Revision Added
A1.12	Active	315037	6258090	56	MGA2020	Existing Stormwater Pit on Factory St	Parramatta River	Parramatta River	No	N/A	N/A	N/A	N/A	15/10/2020	Rev 11
A1.13	Active	315027	6258097	56	MGA2020	Existing Stormwater Pit on Factory St	Parramatta River	Parramatta River	No	N/A	N/A	N/A	N/A	15/10/2020	Rev 11
A1.14	Active	315042	6258104	56	MGA2020	Existing Stormwater Pit on Factory St	Parramatta River	Parramatta River	No	N/A	N/A	N/A	N/A	15/10/2020	Rev 11
A1.15	Active	315034	6258108	56	MGA2020	Existing Stormwater Pit on Factory St	Parramatta River	Parramatta River	No	N/A	N/A	N/A	N/A	15/10/2020	Rev 11
A1.16	Active	315072	6258108	56	MGA2020	Existing Stormwater Pit on Factory St	Parramatta River	Parramatta River	No	N/A	N/A	N/A	N/A	15/10/2020	Rev 11
A1.17	Active	315083	6258114	56	MGA2020	Existing Stormwater Pit on Factory St	Parramatta River	Parramatta River	No	N/A	N/A	N/A	N/A	15/10/2020	Rev 11
A1.18	Active	315104	6258124	56	MGA2020	Existing Stormwater Pit on Factory St	Parramatta River	Parramatta River	No	N/A	N/A	N/A	N/A	15/10/2020	Rev 11
A1.19	Active	315132	6258153	56	MGA2020	Existing Stormwater Pit on Factory St	Parramatta River	Parramatta River	No	N/A	N/A	N/A	N/A	15/10/2020	Rev 11
A1.20	Active	315138	6258153	56	MGA2020	Existing Stormwater Pit on Factory St	Parramatta River	Parramatta River	No	N/A	N/A	N/A	N/A	15/10/2020	Rev 11
A1.21	Active	315168	6258170	56	MGA2020	Existing Stormwater Pit on Factory St	Parramatta River	Parramatta River	No	N/A	N/A	N/A	N/A	15/10/2020	Rev 11
A1.22	Active	315197	6258171	56	MGA2020	Existing Stormwater Pit on Factory St	Parramatta River	Parramatta River	No	N/A	N/A	N/A	N/A	15/10/2020	Rev 11
A1.23	Active	315215	6258175	56	MGA2020	Existing Stormwater Pit on Factory St	Parramatta River	Parramatta River	No	N/A	N/A	N/A	N/A	15/10/2020	Rev 11
A1.24	Active	315221	6258184	56	MGA2020	Existing Stormwater Pit on Factory St	Parramatta River	Parramatta River	No	N/A	N/A	N/A	N/A	15/10/2020	Rev 11
A1.25	Active	315228	6258200	56	MGA2020	Existing Stormwater Pit on Factory St	Parramatta River	Parramatta River	No	N/A	N/A	N/A	N/A	15/10/2020	Rev 11
A1.26	Active	315263	6258202	56	MGA2020	Existing Stormwater Pit on Church St	Parramatta River	Parramatta River	No	N/A	N/A	N/A	N/A	15/10/2020	Rev 11
A1.27	Active	315264	6258193	56	MGA2020	Existing Stormwater Pit on Church St	Parramatta River	Parramatta River	No	N/A	N/A	N/A	N/A	15/10/2020	Rev 11
A1.28	Active	315277	6258168	56	MGA2020	Existing Stormwater Pit on Church St	Parramatta River	Parramatta River	No	N/A	N/A	N/A	N/A	15/10/2020	Rev 11
A1.29	Active	315321	6258077	56	MGA2020	Existing Stormwater Pit on Church St	Parramatta River	Parramatta River	No	N/A	N/A	N/A	N/A	15/10/2020	Rev 11
A1.30	Active	315327	6258053	56	MGA2020	Existing Stormwater Pit on Church St	Parramatta River	Parramatta River	No	N/A	N/A	N/A	N/A	15/10/2020	Rev 11
A1.31	Active	315335	6258035	56	MGA2020	Existing Stormwater Pit on Church St	Parramatta River	Parramatta River	No	N/A	N/A	N/A	N/A	15/10/2020	Rev 11
A1.32	Active	315342	6258016	56	MGA2020	Existing Stormwater Pit on Church St	Parramatta River	Parramatta River	No	N/A	N/A	N/A	N/A	15/10/2020	Rev 11
A1.33	Active	315350	6257997	56	MGA2020	Existing Stormwater Pit on Church St	Parramatta River	Parramatta River	No	N/A	N/A	N/A	N/A	15/10/2020	Rev 11
A1.34	Active	315357	6257979	56	MGA2020	Existing Stormwater Pit on Church St	Parramatta River	Parramatta River	No	N/A	N/A	N/A	N/A	15/10/2020	Rev 11
A1.35	Active	315364	6257960	56	MGA2020	Existing Stormwater Pit on Church St	Parramatta River	Parramatta River	No	N/A	N/A	N/A	N/A	15/10/2020	Rev 11
A1.36	Active	315372	6257942	56	MGA2020	Existing Stormwater Pit on Church St	Parramatta River	Parramatta River	No	N/A	N/A	N/A	N/A	15/10/2020	Rev 11
A1.37	Active	315379	6257923	56	MGA2020	Existing Stormwater Pit on Church St	Parramatta River	Parramatta River	No	N/A	N/A	N/A	N/A	15/10/2020	Rev 11
A1.38	Active	315386	6257905	56	MGA2020	Existing Stormwater Pit on Church St	Parramatta River	Parramatta River	No	N/A	N/A	N/A	N/A	15/10/2020	Rev 11
A1.39	Active	315397	6257888	56	MGA2020	Existing Stormwater Pit on Church St	Parramatta River	Parramatta River	No	N/A	N/A	N/A	N/A	15/10/2020	Rev 11
A1.40	Active	315410	6257884	56	MGA2020	Existing Stormwater Pit on Albert St	Parramatta River	Parramatta River	No	N/A	N/A	N/A	N/A	15/10/2020	Rev 11
A1.41	Active	315406	6257870	56	MGA2020	Existing Stormwater Pit on Albert St	Parramatta River	Parramatta River	No	N/A	N/A	N/A	N/A	15/10/2020	Rev 11
A1.42	Active	315413	6257843	56	MGA2020	Existing Stormwater Pit on Albert St	Parramatta River	Parramatta River	No	N/A	N/A	N/A	N/A	15/10/2020	Rev 11
A1.43	Active	315395	6257512	56	MGA2020	Existing Stormwater Pit on Grose St	Parramatta River	Parramatta River	No	N/A	N/A	N/A	N/A	15/10/2020	Rev 11
A1.44	Active	315384	6257505	56	MGA2020	Existing Stormwater Pit on Grose St	Parramatta River	Parramatta River	No	N/A	N/A	N/A	N/A	15/10/2020	Rev 11
A1.45	Active	315403	6257390	56	MGA2020	Existing Stormwater Pit on Ross St	Parramatta River	Parramatta River	No	N/A	N/A	N/A	N/A	15/10/2020	Rev 11
A1.46	Active	315330	6257144	56	MGA2020	Existing Stormwater Pit on Market St	Parramatta River	Parramatta River	No	N/A	N/A	N/A	N/A	15/10/2020	Rev 11
A3.26	Active	316808	6256307	56	MGA	Discharge into Clay Cliff Creek	Parramatta River	Clay Cliff Creek	Yes	NA	NA	Yes	Discharge into Creek	4/11/2020	Rev12
A3.27	Active	317484	6256104	56	MGA	Discharge into local stormwater system at Sandown Line, Camellia	Parramatta River	Parramatta River	Yes	NA	NA	Yes	Discharge into stormwater	4/11/2020	Rev12
A3.28	Active	317845	6256067	56	MGA	Discharge into local stormwater system at Sandown Line, Camellia	Parramatta River	Parramatta River	Yes	NA	NA	Yes	Discharge into stormwater	4/11/2020	Rev12
A3.29	Active	317282	6256596	56	MGA	Discharge into Parramatta River (South), Camellia	Parramatta River	Parramatta River	Yes	NA	NA	Yes	Discharge into river	4/11/2020	Rev12
A3.30	Active	317287	6256669	56	MGA	Discharge into Parramatta River (North), Camellia	Parramatta River	Parramatta River	Yes	NA	NA	Yes	Discharge into river	4/11/2020	Rev12
A3.31	Active	317524	6257074	56	MGA	Discharge into Vineyard Creek, Rydalmere	Parramatta River	Vineyard Creek	Yes	NA	NA	Yes	Discharge into Creek	4/11/2020	Rev12
A3.32	Active	317756	6257476	56	MGA	Discharge into local stormwater system at Dudley Street, Rydalmere	Parramatta River	Subiaco Creek	Yes	NA	NA	Yes	Discharge into stormwater	4/11/2020	Rev12
A3.33	Active	318098	6257959	56	MGA	Discharge into local stormwater system at Kissing Point Road, Dundas	Parramatta River	Vineyard Creek	Yes	NA	NA	Yes	Discharge into stormwater	4/11/2020	Rev12
A3.34	Active	318364	6258071	56	MGA	Discharge into local stormwater system at Leamington Road, Dundas	Parramatta River	Vineyard Creek	Yes	NA	NA	Yes	Discharge into stormwater	4/11/2020	Rev12
A3.35	Active	318547	6258356	56	MGA	Discharge into local stormwater system at Adderton Road, Telopea	Parramatta River	Vineyard Creek	Yes	NA	NA	Yes	Discharge into stormwater	4/11/2020	Rev12
A3.36	Active	318529	6258710	56	MGA	Discharge into local stormwater system at Adderton Road, Telopea	Parramatta River	Vineyard Creek	Yes	NA	NA	Yes	Discharge into stormwater	4/11/2020	Rev12
A3.37	Active	318623	6258927	56	MGA	Discharge into local stormwater system at Robert Street, Telopea	Parramatta River	Vineyard Creek	Yes	NA	NA	Yes	Discharge into stormwater	4/11/2020	Rev12
A3.38	Active	319001	6259906	56	MGA	Discharge into local stormwater system at Brand Street, Carlingford	Parramatta River	The Ponds Creek	Yes	NA	NA	Yes	Discharge into stormwater	4/11/2020	Rev12

ID	Construction Status	Easting	Northing	AMG Zone	Reference System	Description of location of discharge point	Catchment name	Name of nearest waters	Direct discharge to waters	Total catchment area of basin (ha)	Basin size (operational) m3	Blue Book Criteria	Location description	Date added	Revision Added
A3.39	Active	319245	6260357	56	MGA	Discharge into local stormwater system at Boundary Road, Carlingford	Parramatta River	The Ponds Creek	Yes	NA	NA	Yes	Discharge into stormwater	4/11/2020	Rev12

**Table A-3-2 Discharge Water Quality**

Discharge monitoring Point ID	P1.2 Identification Number	Type of Monitoring Point	Type of Discharge Point	Date	Rainfall Event	Comments
A1.42	1	Basins and settling containers	Stormwater inlet	3/11/2020	Nil	Discharge from Sydney Water main
A1.42	1	Basins and settling containers	Stormwater inlet	11/11/2020	Nil	Discharge from Sydney Water main
A2.06 & A2.09	1	Basins and settling containers	Stormwater inlet	4/11/2020	Nil	Discharge from Sydney Water main
A2.05	1	Basins and settling containers	Stormwater inlet	12/11/2020	Nil	Discharge from Sydney Water main

**Table A-3-3 Rainfall Discharge Events**

Nil



