

Determine if the unit is a single unit entry door or double unit and if it is a wood or aluminum clad frame. For primed or clad units, determine which door screen will be mounted on the active side of the opening. The active side is the door screen which will be used for passage through the door unit while the passive side is left closed.

### NEEDED TOOLS & MATERIALS

- #2 Phillips screwdriver
- #3 Phillips long bit
- Hacksaw or file
- Pencil
- Regular slotted screwdriver
- Power drill with bits
- Level
- Tape measure
- Utility knife or scissors
- Masking tape
- Washers
- Glue stick

**Note!** Do not over tighten screws and strip out mounting screw holes.

### HEAD Z-BAR INSTALLATION

Verify the head is straight and level. If not, washers can be placed behind z-bar mounting holes as necessary. Use a glue stick to hold washers in place. Center the head z-bar between the door jambs. Drive one of the supplied #8 x 1" self-tapping Phillips flat-head screws through the pre-punched hole in one end. Continue driving screws through the rest of the holes.

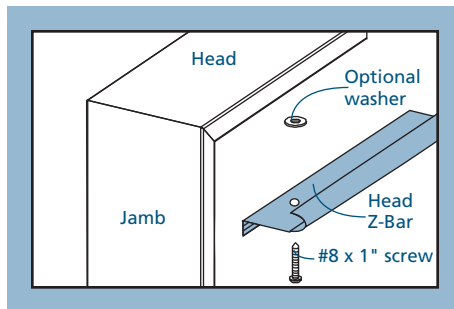

### HINGE SIDE Z-BAR INSTALLATION

1. Verify door hinge side jambs are straight and plumb. If not, washers can be placed behind z-bar mounting holes as necessary. Use a glue stick to hold washers to the z-bar.
2. Pivot z-bar 90° open from screen assembly and place into door frame. While holding z-bar against door jamb, lift screen assembly up until snug against the head z-bar.
3. Using the supplied #8 x 1" self-tapping Phillips flat-head screws, position a screw in the top of the uppermost pre-punched hole and drive until secure. Continue down, driving screws through the remaining pre-punched holes.
4. If installing double screens, repeat steps for the other screen.
5. Close the screen assembly(ies) and check for uniform gap between the door screen assembly and head z-bar. For double units check for uniform 1/2" to 9/16" gap between the two screens. If necessary, remove and add or remove washers as needed and reinstall.

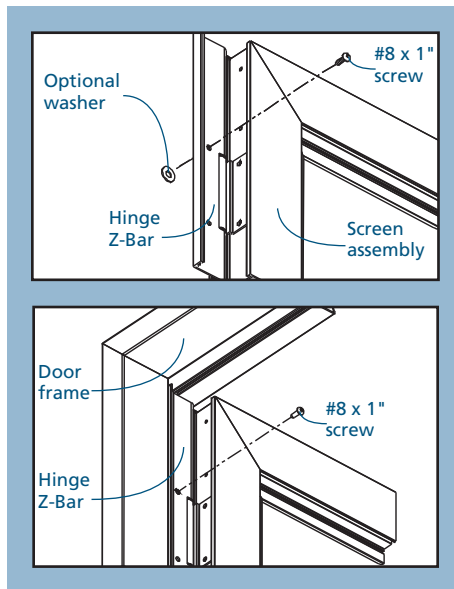

### LATCH SIDE Z-BAR INSTALLATION

**Note!** Applies to single entry units only, double screen units skip this step and will install an astragal in the next step.

1. Close the screen assembly and check for a uniform gap of 1/8" - 1/4" between the screen latch stile and the door frame. Place washers behind the z-bar mounting holes if needed. Use a glue stick to hold washers in place.
2. Re-open the screen assembly approximately 90° and place the latch side z-bar against the door frame latch side jamb and up against the underside of the head z-bar. Install in the same manner as the hinge side. Close the door screen assembly and re-check for a uniform gap between the screen perimeter and the latch side z-bar. If necessary, remove and add or remove washers as needed and reinstall.

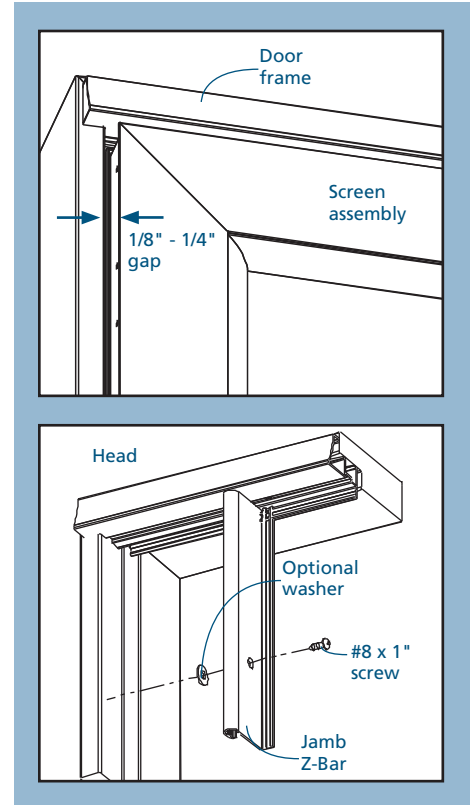

### DOUBLE UNIT ASTRAGAL INSTALLATION

1. Align the astragal on the passive screen side stile with the top of the screen frame and against the inside flange.
2. Hold in place and drive one of the supplied #8 x 1" self-tapping Phillips flat-head screws through the top hole and into the screen frame.
3. Hold the astragal against the inside flange and install the remaining screws. If the bottom end of the astragal rubs on the door sill, remove and trim as needed.

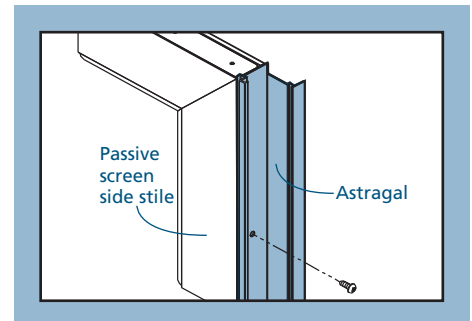

**SILL EXPANDER ADJUSTMENT**

Using a utility knife, trim the flexible flap so that it will just touch at both ends when the screen assembly is closed. The flexible flap should just touch the door sill. If adjustment is necessary, loosen the adjustment screws slightly and move up or down as necessary. Retighten screws.

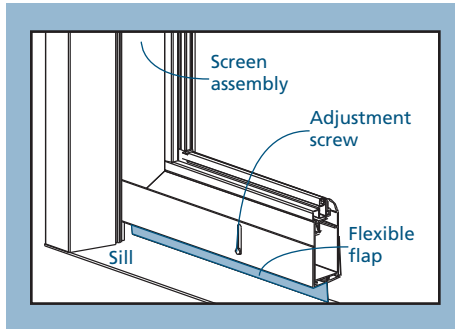

**PASSIVE SCREEN ASTRAGAL SLIDE BOLT INSTALLATION**

1. Position a slide bolt on the screen assembly top rail 3/8" from the edge of the screen stile and 1/16" below the bottom of the head z-bar. Mark screw hole locations and drill 7/64" pilot holes where marked. Secure with two screws.

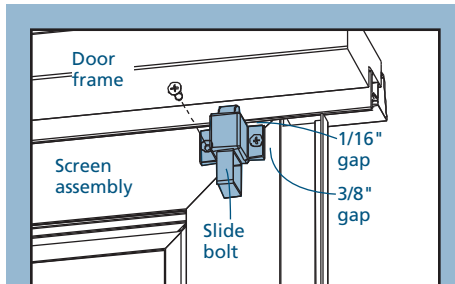

2. Place the strike plate on the door sill flush with the edge of the screen stile and against the inside face of the sill expander. Mark screw hole locations using the slot ends furthest from the sill expander and drill 7/64" pilot holes where marked. Install strike plate screws but do not tighten.

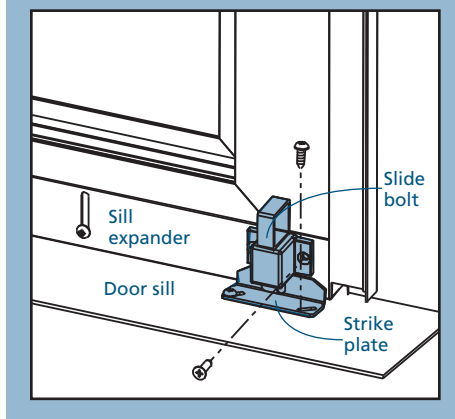

3. Position a slide bolt on the sill expander 3/8" from the edge of the screen stile and 1/16" above the top of the strike plate and mark screw locations. Drill 7/64" pilot holes where marked and attach the slide bolt. Pull the strike plate in against the slide bolt tip and tighten screws.

4. Cut foam pad 3/8" square and apply just below the slide bolt to provide a cushion between the screen and the strike plate.

**SINGLE & DOUBLE ACTIVE SCREEN HANDLE & STRIKE INSTALLATION**

1. Seat the spindle and spring into the outside handle. Reverse feed the handle through the backside of the housing and ensure the handle is properly seated.

2. From the exterior, seat the outside handle and spindle through the pre-drilled holes (spindle will seat through the middle hole). Support the handle until screws are inserted in next step.

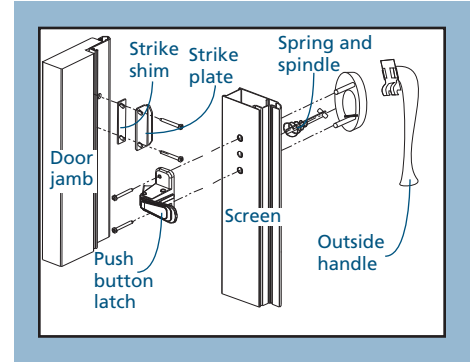

3. From the interior, align the inside handle and spindle so that the spindle seats into the hole located in the middle of the inside handle set. Ensure the inside handle will seat flush against the screen door. Insert machine screws and tighten until the outside handle and inside handle are secured.

4. For a single door, position the latch strike plate (and strike shims if required) onto the door jamb at the approximate vertical center line of the inside handle. Mark and drill two 7/64" pilot holes in the center of the screw slots and install with two screws. Close the screen assembly and check for proper operation and engagement. If necessary, adjust shims behind the strike plate.

5. For passive screen handle installation on a French screen, follow steps 1 - 3 above.

**DOOR CLOSER INSTALLATION**

1. For single entry and double active door screen only, with the screen assembly closed, place the jamb bracket on the hinge side 1/4" from the inside face of the screen and locate it vertically on the approximate center of the screen frame top rail.
2. Mark the screw hole locations and drill 1/8" pilot holes where marked. Install using #10 x 1" black screws.
3. Slide the hold-open bracket onto the closer rod over the lugs until against the closer tube. Align the closer rod hole with the jamb bracket hole and attach with the short pin. Attach the screen bracket to the closer tube FRONT hole with the long grooved connecting pin.
4. Close and latch the screen assembly. Hold the door closer level and the screen bracket against the screen assembly, mark through the center of the slots and drill two 1/8" pilot holes through only the inside surface. Attach the bracket to the screen assembly with #10 x 1/2" short black screws. Reattach the closer to the screen bracket in the REAR hole of the closer tube (if the screen includes an optional glass panel to interchange with the screen panel, install the pin in front hole for best operation).
5. Open the screen assembly and move the hold-open bracket back of the lugs on the closer rod. Closing speed may be changed by turning the adjustment screw clockwise to slow the speed and counter-clockwise to increase the speed.

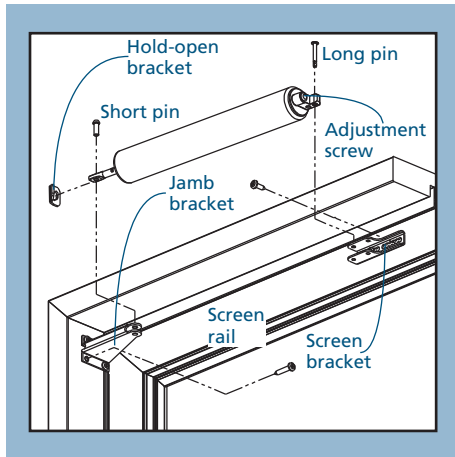

**SCREEN PANEL REMOVAL (FOR STORAGE OR INTERCHANGING PANELS)**

1. With the screen assembly closed, press outward on the top end of one side panel retainer strip and gently pull the top end out and away toward the center of the screen panel (it may be necessary to insert a slotted screwdriver or other flat tool between the screen frame and the retainer strip). Work the strip out a few inches at a time to keep from buckling it.
2. Repeat the process on the opposite side, top and bottom retainer strips.
3. Remove the screen panel.
4. Install the optional storm panel by reversing the removal instructions.
5. To reinstall the screen panel, position the panel with the screen spline facing into the house and install the top and bottom retainer strips first, then sides. Center each in the door frame rail and begin at one end and press into the rail all the way across a few inches at a time.

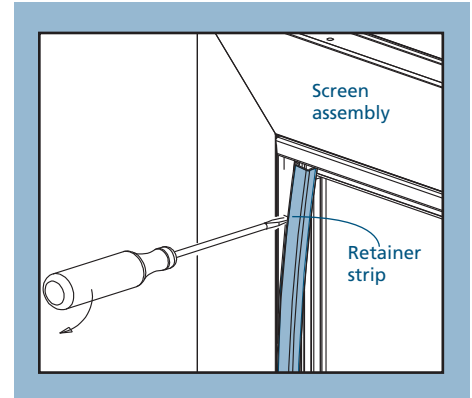

Please visit [jeld-wen.com](http://jeld-wen.com) for warranty and care and maintenance information.

Thank you for choosing

