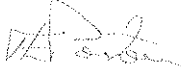

MICHIGAN STATE
UNIVERSITY

June 3, 2011

MEMORANDUM

To: Trustee Finance Committee
From: Fred L. Poston 
Subject: Rau Property Purchase - Manistee County, Michigan

RECOMMENDATION

BE IT RESOLVED that the Trustee Finance Committee recommends that the Board of Trustees authorize the purchase of approximately 5.0 acres from Dianna and Donald Rau, located in Manistee County, Michigan, for \$25,000, and upon such other terms and conditions as may be acceptable to the Vice President for Finance and Operations and Treasurer.

BACKGROUND

The property recommended for purchase is to be used for chestnut research by the Department of Plant Pathology. The property contains approximately 350 American Chestnut trees and is desirable because the trees on this property possess "hypovirulence," a naturally occurring biological control which protects the trees from chestnut blight. Dr. Dennis Fulbright and Dr. Andy Jarosz will use the site for continued research on this phenomenon. There are no buildings on the site.

The property is intended to be purchased using funds from the Land Fund.

The Administration is recommending that the Board of Trustees approve this property purchase.

cc: D. Brower, R. Flinn, M. Haas, J. Kacos, G. Klein, B. Kranz, K. Lindahl,
M. McCabe, J. Mumma, R. Nestle, D. Quinney, C. Reid, B. Groves



OFFICE OF THE
VICE PRESIDENT FOR
FINANCE AND
OPERATIONS

Fred L. Poston
Vice President and
Treasurer

Michigan State University
412 Administration Building
East Lansing, Michigan
48824-1046

Phone 517.355.5014
Fax 517.353.6772
www.vpfo.msu.edu

Rau Property

Springdale Township, Section 6

Manistee County

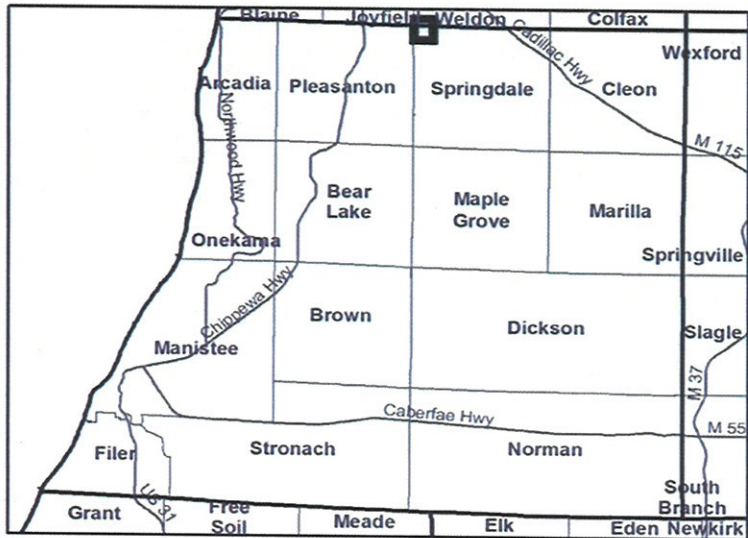

MSU Real Property

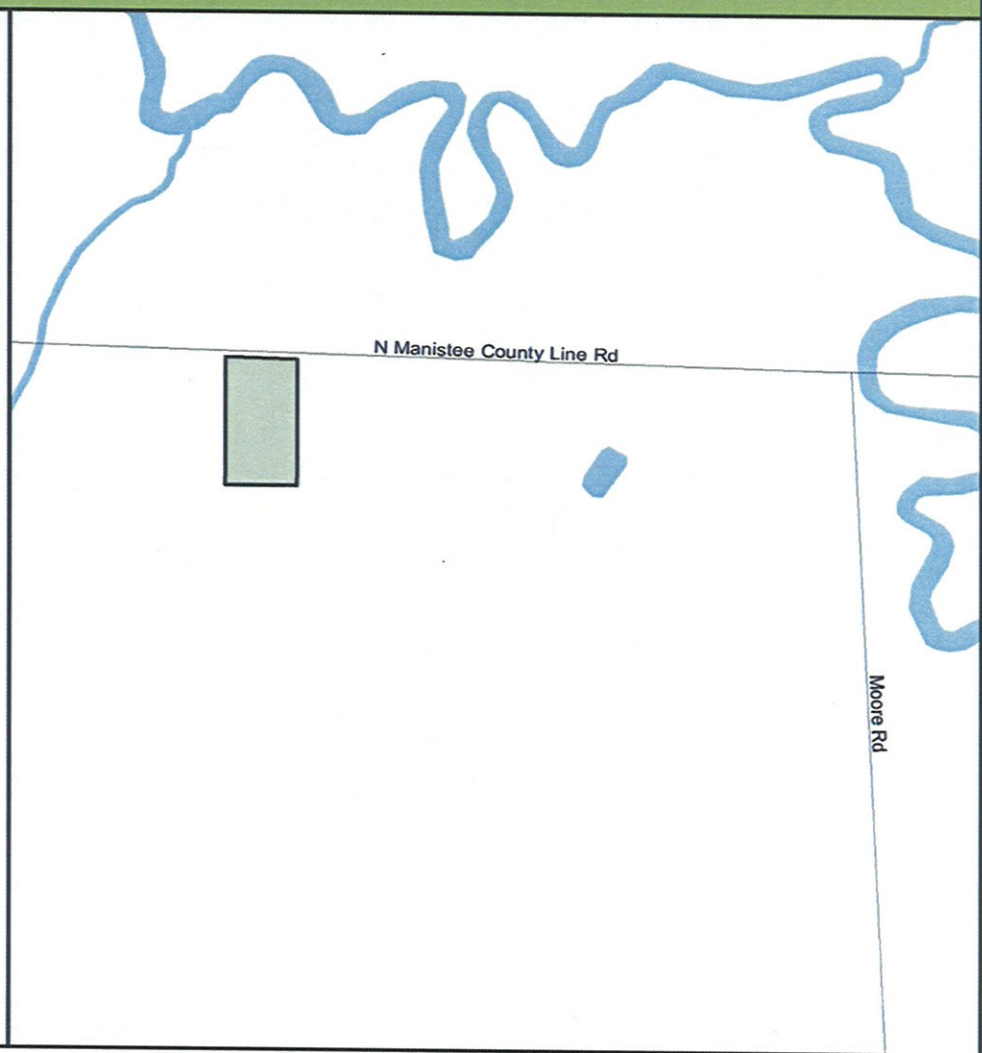

Rau Property

Manistee County, Springdale Township, Section 6

Image Year: 2009

