

MICHIGAN STATE
U N I V E R S I T Y

August 29, 2012

MEMORANDUM

To: Trustee Finance Committee

From: Fred L. Poston 

Subject: **Project Approval - Authorization to Proceed**
Plant Biology - North Wing Lab Exhaust System Replacement

RECOMMENDATION

BE IT RESOLVED that the Trustee Finance Committee recommends that the Board of Trustees authorize the Administration to proceed with the project entitled Plant Biology - North Wing Lab Exhaust System Replacement, and to approve a budget of \$1,500,000.

BACKGROUND

Program Need:

The original wing of Plant Biology was constructed in 1966, with subsequent additions in 1968 and 1985. The sections of the building from the 1960's house research that utilizes laboratory fume hoods which require exhaust systems. It has recently been determined that exhaust fumes are not being properly removed from the building and the exhaust systems must therefore be replaced. In addition, the structural steel supporting an adjacent cooling tower is deteriorating and needs to be replaced.

Description of the Project:

The Plant Biology building is located on Wilson Road, west of Bogue Street in the central academic district. This project involves a comprehensive replacement and consolidation of the central exhaust systems serving the north and east teaching wings of the Plant Biology building. The work scope includes demolition of existing fans in the north penthouse, roofing modifications and reinforcements to accommodate new equipment, new high-plume lab exhaust fans, structural modifications to support new equipment, ductwork modifications within the penthouse, HVAC controls for new equipment, electrical support as needed, and replacement of deteriorating structural steel.

The Architect/Engineer is DiClemente Siegel.



OFFICE OF THE
VICE PRESIDENT FOR
FINANCE AND
OPERATIONS

Fred L. Poston
Vice President and
Treasurer

Michigan State University
Hannah Administration Building
426 Auditorium Road, Room 412
East Lansing, Michigan
48824

Phone 517.355.5014
Fax 517.353.6772
www.vpfo.msu.edu

Based on an assessment of the factors stated in the Project Planning and Approval process concerning Project Labor Agreements (PLA), the Vice President for Finance and Operations and Treasurer has determined that a PLA would not be required for this project.

Communication Feedback:

The campus community was given opportunities to provide feedback during the planning phase and any concerns have been addressed in the project design.

The Office of Campus Planning and Administration has reviewed this project and found it to be consistent with the Campus Master Plan and Planning Principles. The Campus Infrastructure Planning Work Group also supports the recommendation to proceed with the project.

As construction proceeds, the schedule will be reviewed with the campus community.

Project Cost and Timetable:

The budget for this Design-Bid-Build project is \$1,500,000, which is being funded by the general fund and Just-In-Time.

Construction is planned to begin in February 2013, with substantial completion in May 2013, and final completion December 2013.

cc: R. Flinn, M. Haas, J. Kacos, G. Klein, B. Kranz, B. Latta, K. Lindahl,
M. McCabe, J. Mumma, R. Nestle, D. Quinney, K. Neils

Project Approval – Authorization to Proceed
Plant Biology – North Wing Lab Exhaust System Replacement

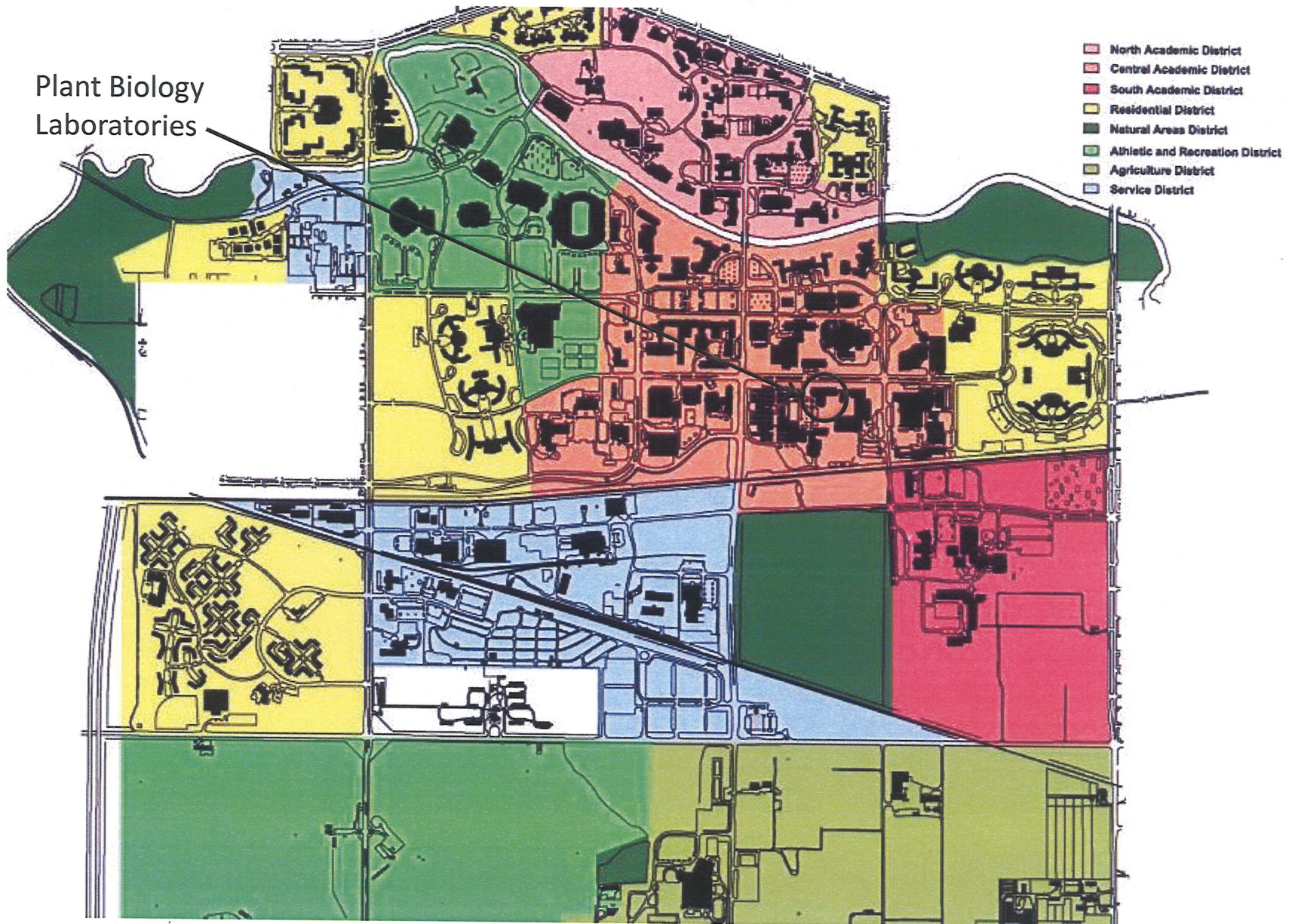

Project Approval – Authorization to Proceed
Plant Biology – North Wing Lab Exhaust System Replacement

North Wing

East Wing

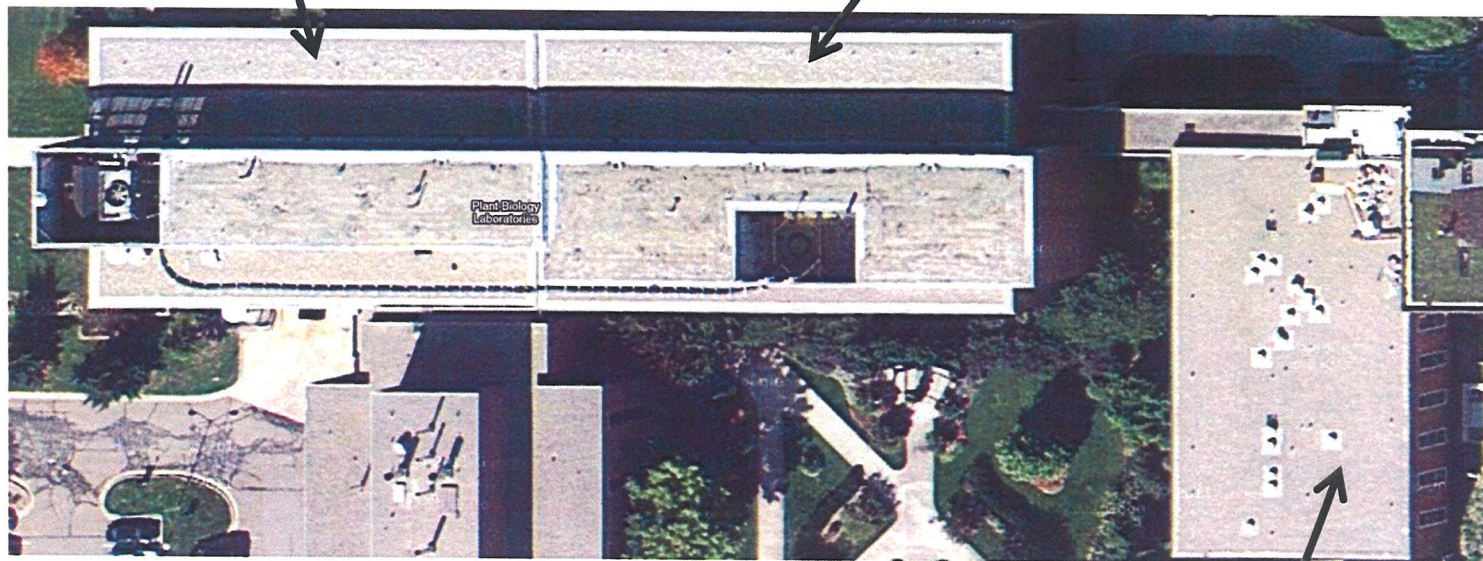

Teaching (Botany) Wing

MICHIGAN STATE
UNIVERSITY

June 8, 2012

MEMORANDUM

To: Trustee Finance Committee

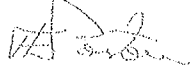
From: Fred L. Poston 

Subject: **Authorization to Plan**
Plant Biology - North Wing Lab Exhaust System Replacement



RECOMMENDATION

BE IT RESOLVED that the Trustee Finance Committee recommends that the Board of Trustees authorize the Administration to plan for the project entitled Plant Biology - North Wing Lab Exhaust System Replacement.

BACKGROUND
Program Need:

The original wing of Plant Biology was constructed in 1966, with subsequent additions in 1968 and 1985. The sections of the building from the 1960's house research that utilizes laboratory fume hoods which require exhaust systems. It has recently been determined that exhaust fumes are not being properly removed from the building and the exhaust systems must therefore be replaced.

General Description of the Project:

The planning of this project is anticipated to include a comprehensive replacement and consolidation of the central exhaust systems serving the north and east teaching wings of the Plant Biology building. The work scope includes demolition of existing fans in the north penthouse, roofing modifications and reinforcements to accommodate new equipment, new high-plume lab exhaust fans, associated aesthetic screen walls to conceal mechanical equipment, ductwork modifications within the penthouse, HVAC controls for new equipment, and electrical support as needed.

The Plant Biology building is located on Wilson Road, west of Bogue Street in the central academic district. This is a Just-In-Time maintenance project and is consistent with the Campus Master Plan and Planning Principles.



OFFICE OF THE
VICE PRESIDENT FOR
FINANCE AND
OPERATIONS

Fred L. Poston
Vice President and
Treasurer

Michigan State University
Hannah Administration Building
426 Auditorium Road, Room 412
East Lansing, Michigan
48824

Phone 517.355.5014
Fax 517.353.6772
www.vpfo.msu.edu

Based on an assessment of the factors stated in the Project Planning and Approval process concerning Project Labor Agreements (PLA), the Vice President for Finance and Operations and Treasurer has determined that a PLA would not be required for this project.

Communication Plan:

During the planning phase, the campus community will be given opportunities to provide feedback on the project as it is being designed. Input from the project planning team will be solicited during the design phase.

Preliminary Project Cost Information:

Based on cost experience for similar projects and current pricing information, the preliminary project cost estimate is \$1,450,000. This estimate may change as planning progresses and the project scope is further defined.

The source of funds for the project is expected to be investment income.

cc: R. Flinn, M. Haas, J. Kacos, G. Klein, B. Kranz, B. Latta, K. Lindahl,
M. McCabe, J. Mumma, R. Nestle, D. Quinney, K. Neils

CP12097