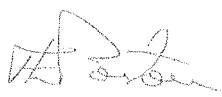

MICHIGAN STATE  
UNIVERSITY

October 17, 2012

**MEMORANDUM**

**To:** Trustee Finance Committee

**From:** Fred L. Poston 

**Subject:** **Project Approval - Authorization to Proceed**  
Reconstruct Bogue Street and Shaw Lane Intersection (including partial closure of Bogue Street) and Steam Distribution - Replace Steam Lines to Owen Graduate Hall

**RECOMMENDATION**

BE IT RESOLVED that the Trustee Finance Committee recommends that the Board of Trustees authorize the Administration to proceed with the project entitled Reconstruct Bogue Street and Shaw Lane Intersection (including partial closure of Bogue Street) and Steam Distribution - Replace Steam Lines to Owen Graduate Hall, and to approve a budget of \$6,800,000.



OFFICE OF THE  
VICE PRESIDENT FOR  
FINANCE AND  
OPERATIONS

Fred L. Poston  
Vice President and  
Treasurer

Michigan State University  
Hannah Administration Building  
426 Auditorium Road, Room 412  
East Lansing, Michigan  
48824

Phone 517.355.5014  
Fax 517.353.6772  
www.vpfo.msu.edu

**BACKGROUND**

**Program Need:**

The existing Bogue Street and Shaw Lane traffic circle does not meet current U.S. Access Board's design guidelines for public rights-of-way to provide equal accessibility for all users. These new standards require design modifications and traffic signals for pedestrian safety, particularly pedestrians with mobility disabilities. Additionally, these new standards do not support continued use of a traffic circle for an intersection with high volumes of pedestrians, bicycles, and vehicles. As part of the redesign of the Bogue Street and Shaw Lane intersection, the closure of a section of Bogue Street will allow for further expansion of the Facility for Rare Isotope Beams (FRIB).

There is also a need to address the steam distribution lines that are located below the Bogue Street and Shaw Lane intersection. The existing direct-buried steam distribution and condensate return lines servicing Owen Graduate Hall were installed in 1957 and have been repaired several times during the last 10 years. They now need to be replaced with a steam tunnel to ensure reliable steam service and provide flood protection measures.

**Description of the Project:**

The steam distribution area to be replaced is located between the east side of the Business Complex and the west wing of Owen Graduate Hall. The intersection of Bogue Street and Shaw Lane borders the central academic and residential districts.

This project involves reconstruction of the Bogue Street and Shaw Lane traffic circle to be compliant with ADA standards. This will require converting the existing roundabout to a more conventional signalized intersection. The project includes the addition of bike lanes consistent with the campus master plan. The project incorporates closure of Bogue Street between Shaw Lane and Wilson Road to accommodate FRIB expansion. Accessibility to Wharton Center loop driveway will remain, allowing for drop-off, accessible parking, and short-term business at the Wharton Box Office, along with periodic service access to FRIB. The project will also replace deteriorating direct-buried steam and condensate lines with a steam tunnel from the east side of the Business Complex to the west side of Owen Graduate Hall.

The Architect/Engineers for this project are Fishbeck, Thompson, Carr, & Huber Inc, and URS.

Based on an assessment of the factors stated in the Project Planning and Approval process concerning Project Labor Agreements (PLA), the Vice President for Finance and Operations and Treasurer has determined that a PLA would not be required for this project.

**Communication Feedback:**

The campus community was given opportunities to provide feedback during the planning phase and any concerns have been addressed in the project design.

The Office of Campus Planning and Administration has reviewed this project and found it to be consistent with the Campus Master Plan and Planning Principles. The Campus Infrastructure Planning Work Group also supports the recommendation to proceed with the project.

As construction proceeds, the schedule will be reviewed with the campus community.

**Project Cost and Timetable:**

The budget for this Design-Bid-Build project is \$6,800,000, which is being funded by a combination of the general fund and tax-exempt financing, with debt repayment from the general fund.

Construction is planned to begin in April 2013, with substantial completion in August 2013, and final completion by June 2014.

cc: R. Flinn, M. Haas, J. Kacos, G. Klein, B. Kranz, B. Latta, K. Lindahl,  
M. McCabe, J. Mumma, R. Nestle, D. Quinney, K. Neils, S. Troost,  
L. Adams

CP11259

Project Approval – Authorization to Proceed

Reconstruct Bogue Street and Shaw Lane Intersection (including partial closer of Bogue Street) and  
Steam Distribution – Replace Steam Lines to Owen Graduate Hall

MICHIGAN STATE  
UNIVERSITY

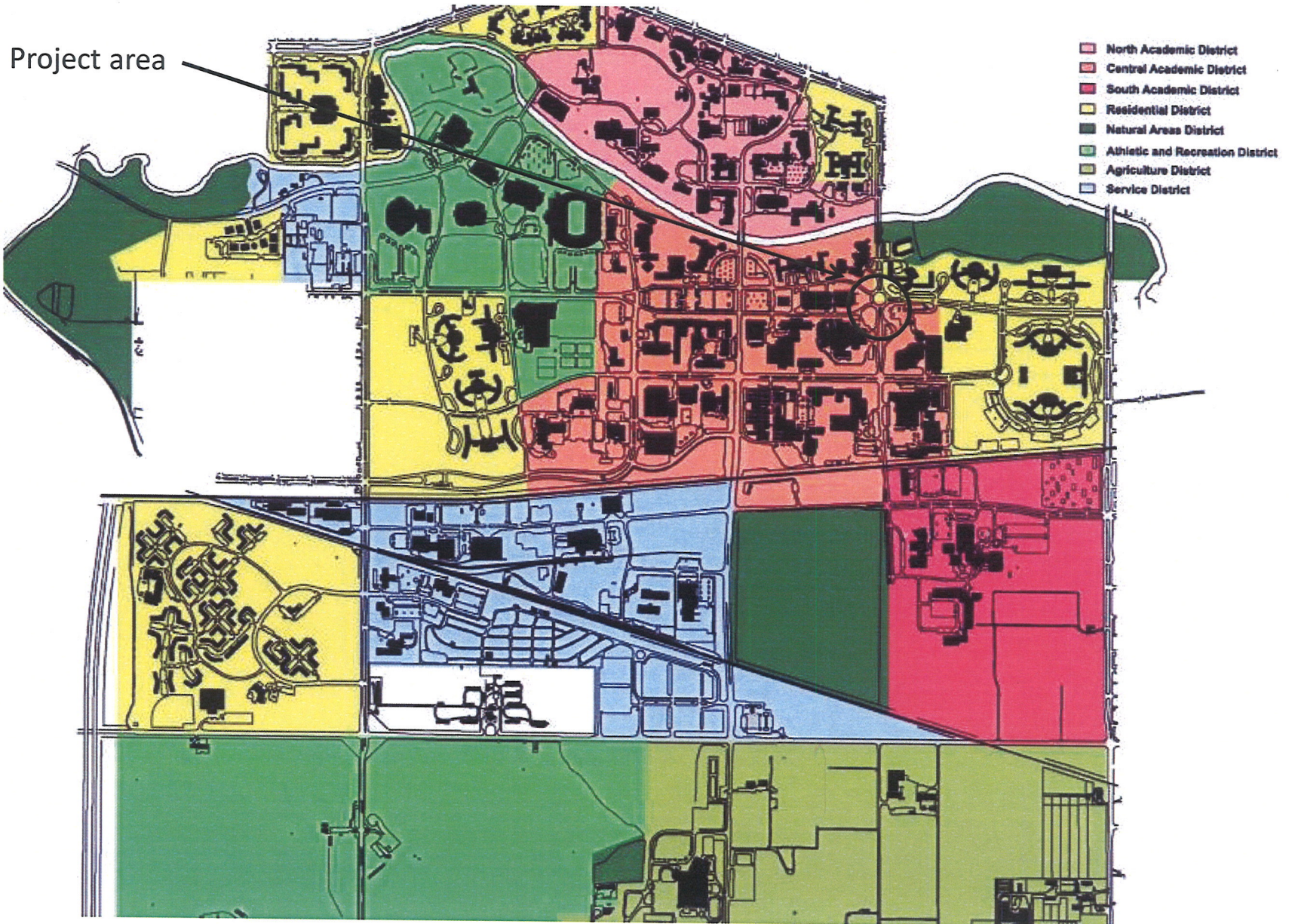

Project Approval – Authorization to Proceed  
Reconstruct Bogue Street and Shaw Lane Intersection (including partial closer of Bogue Street) and  
Steam Distribution – Replace Steam Lines to Owen Graduate Hall

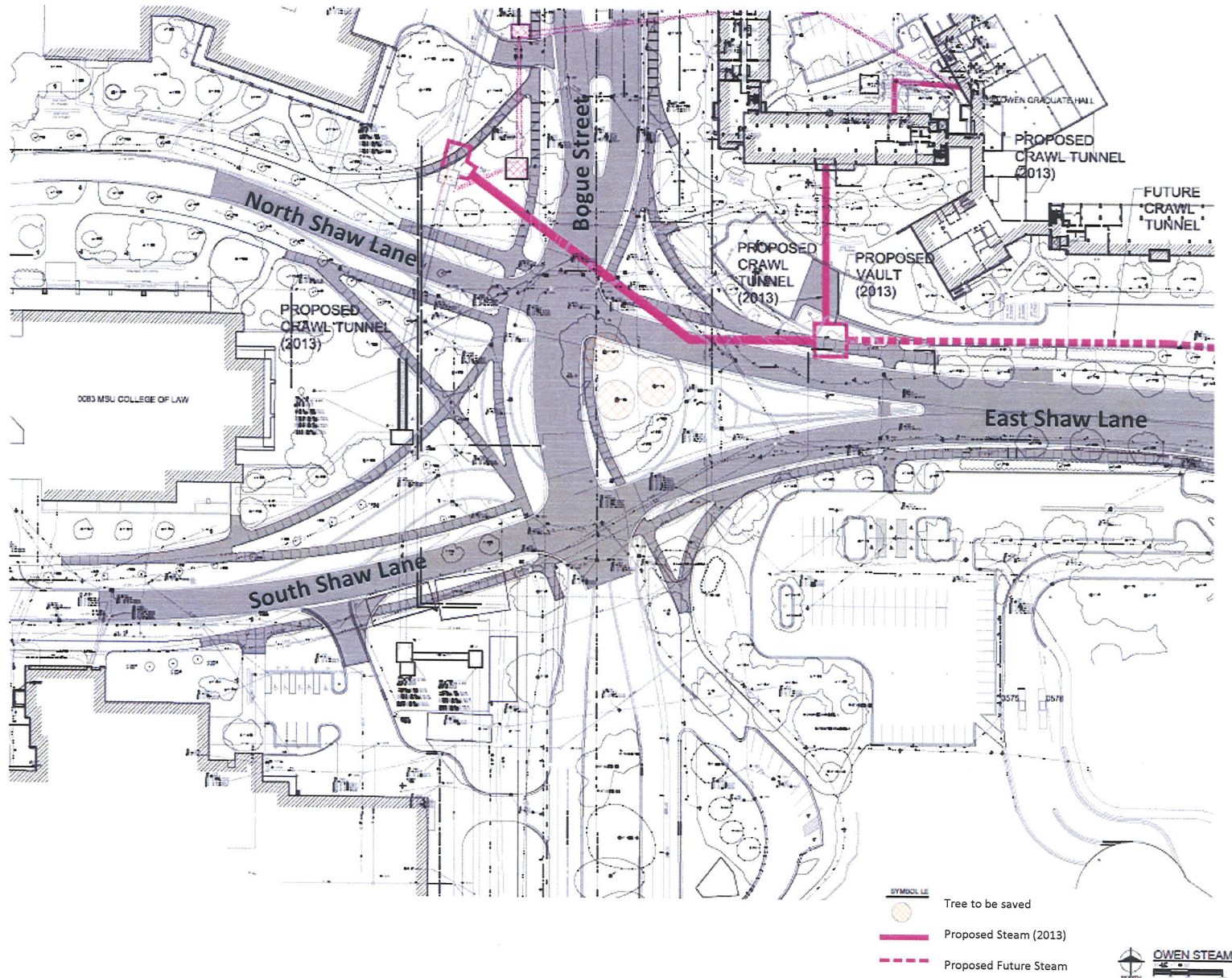

**MICHIGAN STATE  
UNIVERSITY**

November 30, 2011

**MEMORANDUM**

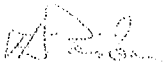

**To:** Trustee Finance Committee  
**From:** Fred L. Poston   
**Subject:** **Authorization to Plan**  
Steam Distribution - Replace Steam Lines to Owen Graduate Hall

**RECOMMENDATION**

BE IT RESOLVED that the Trustee Finance Committee recommends that the Board of Trustees authorize the Administration to plan for the project entitled Steam Distribution - Replace Steam Lines to Owen Graduate Hall.

**BACKGROUND**

**Program Need:**

The existing direct-buried steam distribution and condensate return lines servicing Owen Graduate Hall were installed in 1957 and have been repaired several times during the last 10 years. They now need to be replaced with a steam tunnel to ensure reliable steam service and provide flood protection measures.

**General Description of the Project:**

The planning of this project is anticipated to include replacing deteriorating direct-buried steam and condensate lines with a steam tunnel from the east side of the Business Complex to the west side of Owen Graduate Hall.

The project site is located between the east side of the Business Complex and the west wing of Owen Graduate Hall and from the west wing to the center section of Owen Graduate Hall in the Residential District. This project is consistent with the Campus Master Plan and Planning Principles.

Based on an assessment of the factors stated in the Project Planning and Approval process concerning Project Labor Agreements (PLA), the Vice President for Finance and Operations and Treasurer has determined that a PLA would not be required for this project.



OFFICE OF THE  
VICE PRESIDENT FOR  
FINANCE AND  
OPERATIONS

Fred L. Poston  
Vice President and  
Treasurer

Michigan State University  
412 Administration Building  
East Lansing, Michigan  
48824-1046

Phone 517.355.5014  
Fax 517.353.6772  
www.vpfo.msu.edu

**Communication Plan:**

During the planning phase, the campus community will be given opportunities to provide feedback on the project as it is being designed. Input from the project planning team will be solicited during the design phase.

**Preliminary Project Cost Information:**

Based on cost experience for similar projects and current pricing information, the preliminary project cost estimate is \$2,800,000. This estimate may change as planning progresses and the project scope is further defined.

This is a Just-In-Time project and the source of funds for the project is expected to be tax-exempt financing with debt repayment from the general fund.

cc: R. Flinn, M. Haas, J. Kacos, G. Klein, B. Kranz, B. Latta, K. Lindahl, M. McCabe, J. Mumma, R. Nestle, D. Quinney, L. Adams, K. Neils

CP11259

**MICHIGAN STATE  
UNIVERSITY**

January 18, 2012

**MEMORANDUM**



**To:** Trustee Finance Committee  
**From:** Fred L. Poston *[Signature]*  
**Subject:** **Authorization to Plan**  
Reconstruct Bogue Street and Shaw Lane Intersection  
(including partial closure of Bogue Street)

**RECOMMENDATION**

BE IT RESOLVED that the Trustee Finance Committee recommends that the Board of Trustees authorize the Administration to plan for the project entitled Reconstruct Bogue Street and Shaw Lane Intersection (including partial closure of Bogue Street).

**BACKGROUND**

**Program Need:**

The Bogue Street and Shaw Lane traffic circle do not currently meet pending ADA standards for accessibility. These new standards will require traffic signals for pedestrian safety, particularly pedestrians with mobility disabilities. These new standards do not support continued use of a traffic circle for an intersection with high volumes of pedestrians, bicycles, and vehicles. The closure of a section of Bogue Street also allows for further expansion of FRIB.

**General Description of the Project:**

The planning of this project is anticipated to include reconstruction of the Bogue Street and Shaw Lane traffic circle to be compliant with ADA standards. The planning will also include the closure of Bogue Street between Shaw and Wilson roads. Accessibility to Wharton Center will remain open.

The project is located in the northeast corner of the Central Academic District and borders the Residential District. This is a Just-In-Time maintenance project and is consistent with the Campus Master Plan and Planning Principles.

Based on an assessment of the factors stated in the Project Planning and Approval process concerning Project Labor Agreements (PLA), the Vice President for Finance and Operations and Treasurer has determined that a PLA would not be required for this project.



OFFICE OF THE  
VICE PRESIDENT FOR  
FINANCE AND  
OPERATIONS

Fred L. Poston  
Vice President and  
Treasurer

Michigan State University  
412 Administration Building  
East Lansing, Michigan  
48824-1046

Phone 517.355.5014  
Fax 517.353.6772  
[www.vpfo.msu.edu](http://www.vpfo.msu.edu)

**Communication Plan:**

During the planning phase, the campus community will be given opportunities to provide feedback on the project as it is being designed. Input from the project planning team will be solicited during the design phase.

**Preliminary Project Cost Information:**

Based on cost experience for similar projects and current pricing information, the preliminary project cost estimate is \$4,000,000. This estimate may change as planning progresses and the project scope is further defined.

The source of funds for the project is expected to be the General Fund - Just-In-Time.

cc: R. Flinn, M. Haas, J. Kacos, G. Klein, B. Kranz, B. Latta, K. Lindahl, M. McCabe, J. Mumma, R. Nestle, D. Quinney, M. Rice, S. Troost

CP11331