

A woman with curly hair, wearing a light-colored top and jeans, stands on a stage, speaking into a microphone. She is gesturing with her right hand. The stage is illuminated with blue light, and a large, abstract, geometric pattern is projected onto the floor. In the background, a large audience is seated in tiered rows, facing the stage. A large screen above the speaker shows a close-up of her. The overall atmosphere is professional and modern.

# ROADMAP TO BUILD A HOME FOR YOUR EVENT



# HOUSE OF EVENTS HOME OF YOUR INDUSTRY



RAI Amsterdam is not just any place. It's a home for your event to thrive - the perfect place to connect, innovate, create impact and have a great time.

Our house is your home.  
Welcome home. Explore the house.







## PLAN YOUR ROAD TO SUCCESS

### UNLOCK YOUR EVENT AND ENTER A WORLD OF POSSIBILITIES. RAI HOLDS THE KEY – JUST MAKE YOURSELF AT HOME.

RAI Amsterdam has a rich history. Founded in 1893 as a bicycle industry association, RAI has grown in just over a century to become a leading international trade event and conference organisation. Now, 130 years later, RAI remains a premier networking organisation and platform for key industries. With over 600 events a year, our portfolio still spans the Logistics & Smart Mobility sector and our expertise has broadened to serve and connect the world's leading industries.

Today, our mission is the same: to bring together people, ideas and organisations to share knowledge, stimulate innovation and support economic growth. RAI Amsterdam has also committed itself to the sustainable development of people and communities, the economy, and the environment.



OUR WELL-CONNECTED VENUE OFFERS 116,200 SQM OF HIGHLY FLEXIBLE MEETING, EXHIBITION, BALLROOM AND PLENARY SPACE  
- GIVING YOU A HEAD START ON YOUR EVENT PLANNING.

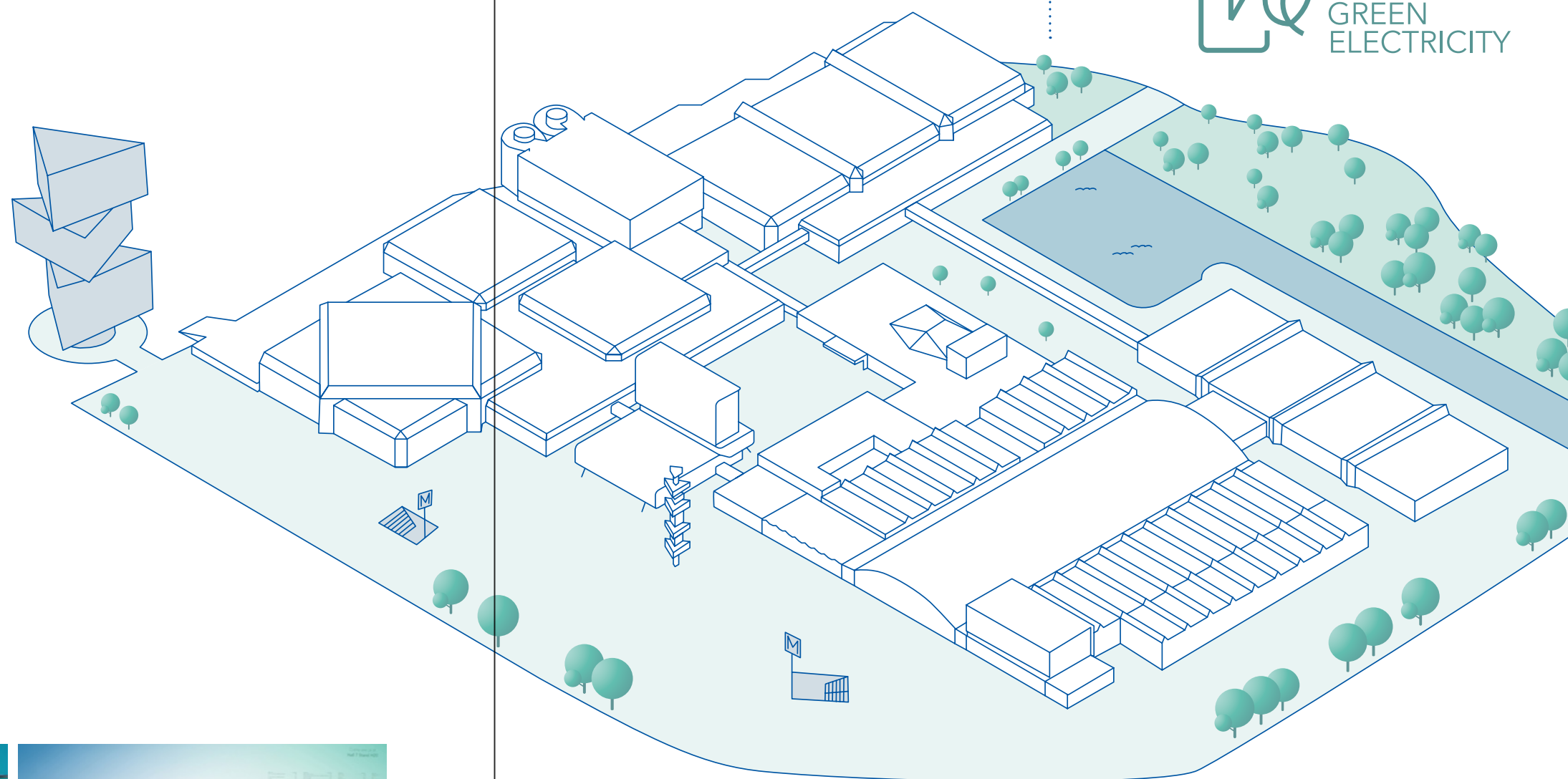

RAI AMSTERDAM IS THE GATEWAY TO THE CITY  
WHERE THE WORLD MEETS AMSTERDAM AND  
AMSTERDAM MEETS THE WORLD





12 MULTI-FUNCTIONAL HALLS

1 BALLROOM

3 INTERLINKED  
CONFERENCE CENTRES

70 CONFERENCE &  
MEETING ROOMS

2 AUDITORIUMS

5 RESTAURANTS

HARBOUR & URBAN BEACH

## THE PERFECT HOME FOR YOUR EVENT

Together, we have the ability to spark your event and take your business to the next level, ensuring that everything is in place to exceed expectations. Our company and preferred partners respect and understand your mission and are therefore committed to providing you with the expert solutions and outstanding service you need.





# OVERVIEW HALLS

	[M²]	[sqm]	☀️	👤	☀️
Hall 1	15,000	161,459	6,900	10,000	•
Hall 1 + Balcony	18,240	196,334			•
Hall 2	4,060	43,701	1,840	4,000	•
Hall 3	3,920	42,195	1,600	4,000	•
Hall 4 > Amtrium	540	5,812	264	500	•
Hall 5	11,395	122,654	8,390	6,740	•
Hall 6	1,025	11,033			•
Hall 7	10,460	112,590	4,040	8,000	•
Hall 8	12,600	135,625	4,680	10,000	•
Hall 9	2,845	30,623	2,148	1,500	•
Hall 10	3,970	42,733	1,800	4,000	•
Hall 11	4,165	44,832	1,890	4,000	•
Hall 12	9,035	97,252	3,900	7,500	•
Hall 13 > Ballroom	1,985	21,366	1,070	2,000	•

Figures are guidelines, no rights can be derived from these figures.  
• = daylight available

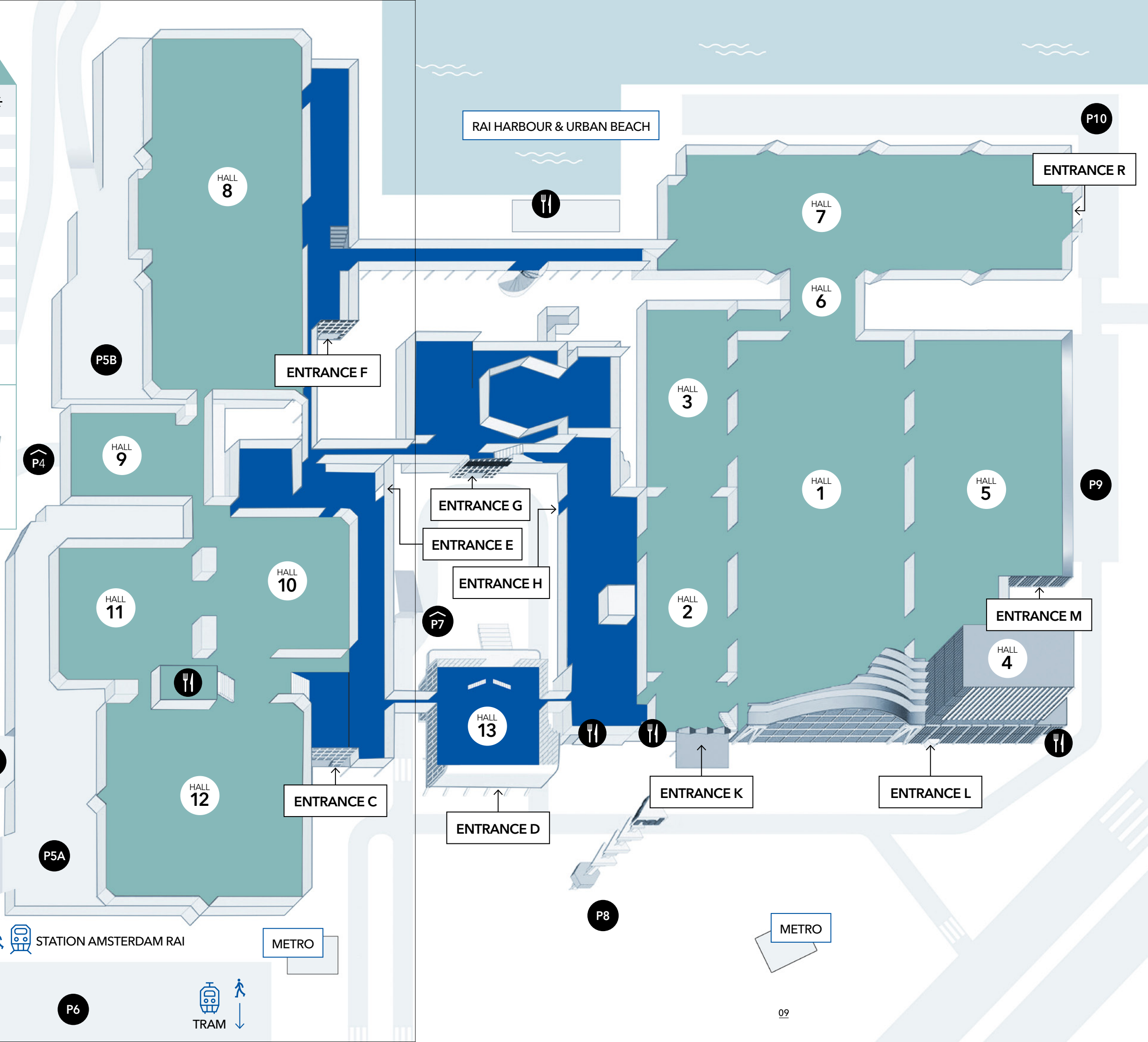
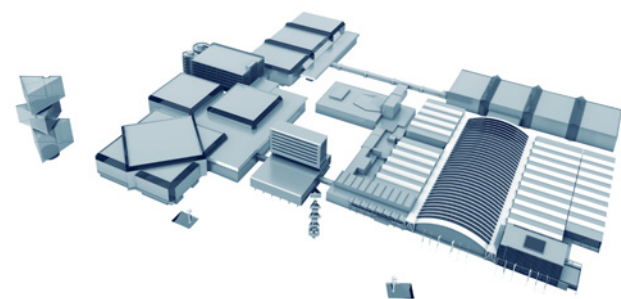

nhov AMSTERDAM RAI HOTEL

STATION AMSTERDAM RAI

METRO

TRAM

METRO



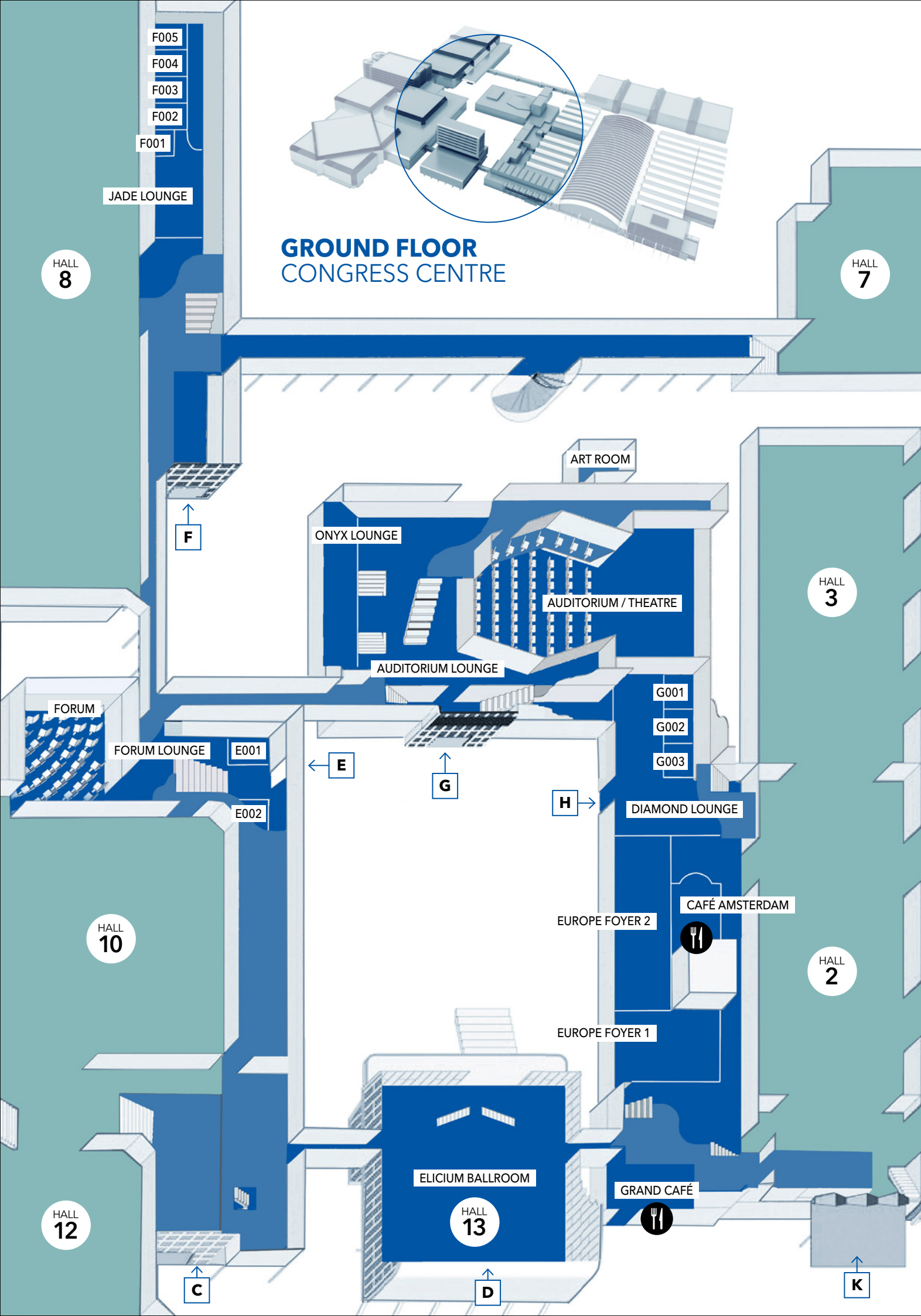

## GROUND FLOOR CONGRESS CENTRE & ELICIUM BALLROOM

ENTRANCE D - ELICIUM	[M <sup>2</sup> ]	[SqR]								
Elicium Ballroom	1,985	21,366	1,974	760	1,104	130		1,070		•
Elicium 1	869	9,353	700	288	462	92				•
Elicium 2	1,116	12,013	1,100	432	654	104				•

ENTRANCE E - FORUM CENTRE	[M <sup>2</sup> ]	[SqR]							
E001*	48	517					10		•
E002*	38	409					8		•
Forum	755	8,127	709						
Forum Lounge	1,120	12,056					390	500	•

ENTRANCE F - PARK CENTRE	[M <sup>2</sup> ]	[SqR]							
F001*	18	194					8		
F002	90	969	97	40	60	26	32	60	
F003	90	970	97	40	60	26	32	60	
F004	90	971	97	40	60	26	32	60	
F005	90	972	97	40	60	26	32	60	
F002-F003/F003-F004/F004-F005	180	1,938	176	84	120	40	52	96	
F002-F004/F003-F005	270	2,906	250	120	180	60	72	136	
F002-F005	360	3,875	318	160	252	80	92	208	
Jade Lounge	336	3,616						120	250

ENTRANCE G - AUDITORIUM CENTRE	[M <sup>2</sup> ]	[SqR]							
Onyx lounge	795	8,557						370	500
Auditorium Ground Floor + Balcony	1,500	16,146	1,732						
Auditorium Ground Floor	1,075	11,571	1,248						
Auditorium Lounge + Upper Lounge	2,660	28,632							•
Auditorium Lounge	1,600	17,222						496	1,250
Upper Lounge	1,060	11,410						470	700
Dressing Room 1-3	18	194							•
Artist Foyer*	88	947							•
G001	51	548	50	10	36	15	20	30	
G002	44	474	30	10	24	12	16	20	•
G001-G002	95	1,022	110	32	72	31	36	56	•
G003*	43	463					12		•
Diamond Lounge	745	8,019						240	500
Europe Foyer	1,833	19,730						1,030	1,250
Europe Foyer 1	1,163	12,518						730	750
Europe Foyer 2	670	7,211						410	500

RESTAURANTS	[M <sup>2</sup> ]	[SqR]		
Grand Café	480	4,359		200
Café Amsterdam	245	2,637		80

Figures are guidelines, no rights can be derived from these figures. \*Fixed set up. \*\*Only in combination with halls. • Available



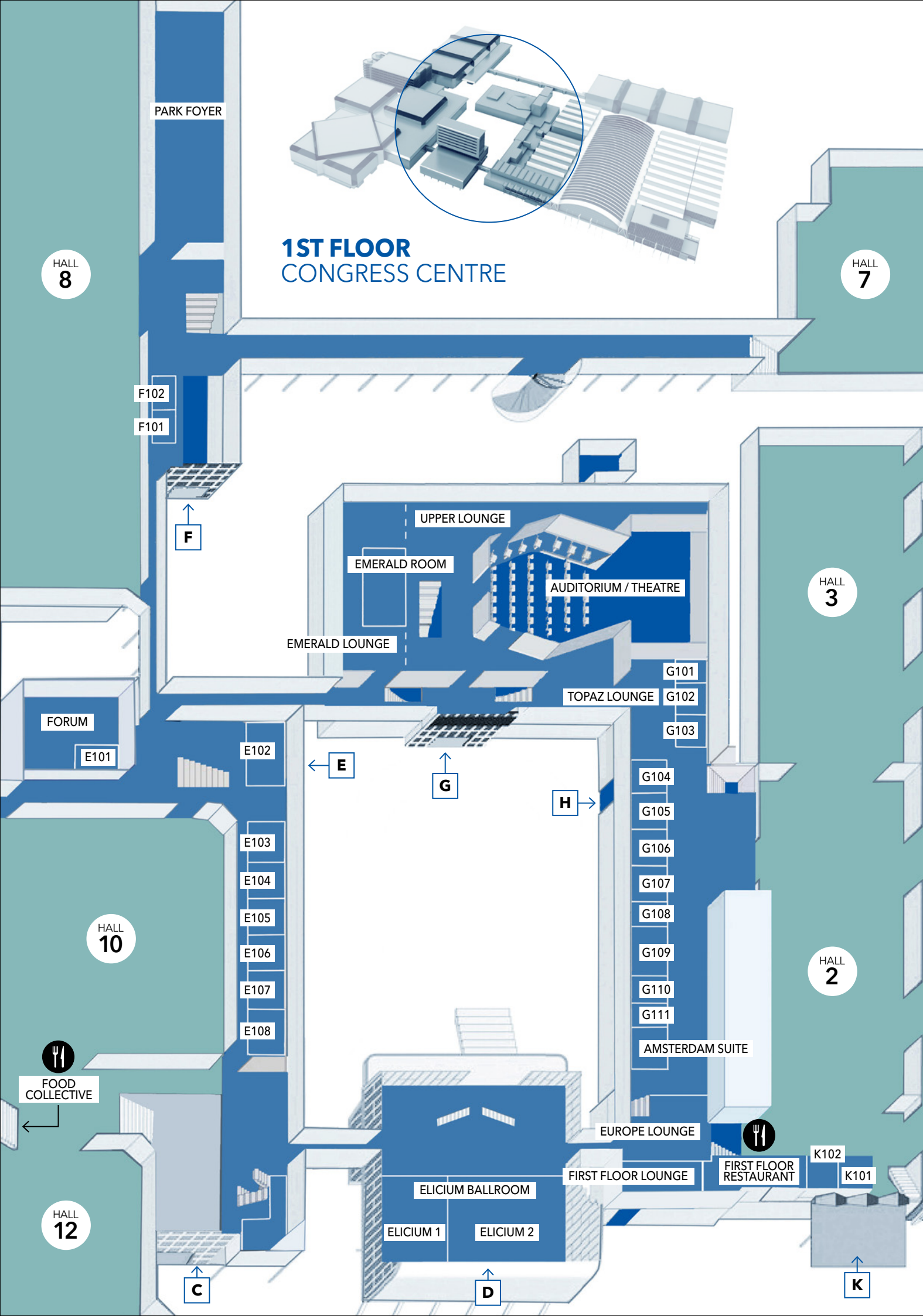

1ST FLOOR CONGRESS CENTRE & ELICIUM BALLROOM

ENTRANCE C			[M²]	[Sqft]																																																																																																																																																																																																																																																																																																																																																																																																																																																																																																																																																																																																																																				
------------	--	--	------	--------	--	--	--	--	--	--	--	--	--	--	--	--	--	--	--	--	--	--	--	--	--	--	--	--	--	--	--	--	--	--	--	--	--	--	--	--	--	--	--	--	--	--	--	--	--	--	--	--	--	--	--	--	--	--	--	--	--	--	--	--	--	--	--	--	--	--	--	--	--	--	--	--	--	--	--	--	--	--	--	--	--	--	--	--	--	--	--	--	--	--	--	--	--	--	--	--	--	--	--	--	--	--	--	--	--	--	--	--	--	--	--	--	--	--	--	--	--	--	--	--	--	--	--	--	--	--	--	--	--	--	--	--	--	--	--	--	--	--	--	--	--	--	--	--	--	--	--	--	--	--	--	--	--	--	--	--	--	--	--	--	--	--	--	--	--	--	--	--	--	--	--	--	--	--	--	--	--	--	--	--	--	--	--	--	--	--	--	--	--	--	--	--	--	--	--	--	--	--	--	--	--	--	--	--	--	--	--	--	--	--	--	--	--	--	--	--	--	--	--	--	--	--	--	--	--	--	--	--	--	--	--	--	--	--	--	--	--	--	--	--	--	--	--	--	--	--	--	--	--	--	--	--	--	--	--	--	--	--	--	--	--	--	--	--	--	--	--	--	--	--	--	--	--	--	--	--	--	--	--	--	--	--	--	--	--	--	--	--	--	--	--	--	--	--	--	--	--	--	--	--	--	--	--	--	--	--	--	--	--	--	--	--	--	--	--	--	--	--	--	--	--	--	--	--	--	--	--	--	--	--	--	--	--	--	--	--	--	--	--	--	--	--	--	--	--	--	--	--	--	--	--	--	--	--	--	--	--	--	--	--	--	--	--	--	--	--	--	--	--	--	--	--	--	--	--	--	--	--	--	--	--	--	--	--	--	--	--	--	--	--	--	--	--	--	--	--	--	--	--	--	--	--	--	--	--	--	--	--	--	--	--	--	--	--	--	--	--	--	--	--	--	--	--	--	--	--	--	--	--	--	--	--	--	--	--	--	--	--	--	--	--	--	--	--	--	--	--	--	--	--	--	--	--	--	--	--	--	--	--	--	--	--	--	--	--	--	--	--	--	--	--	--	--	--	--	--	--	--	--	--	--	--	--	--	--	--	--	--	--	--	--	--	--	--	--	--	--	--	--	--	--	--	--	--	--	--	--	--	--	--	--	--	--	--	--	--	--	--	--	--	--	--	--	--	--	--	--	--	--	--	--	--	--	--	--	--	--	--	--	--	--	--	--	--	--	--	--	--	--	--	--	--	--	--	--	--	--	--	--	--	--	--	--	--	--	--	--	--	--	--	--	--	--	--	--	--	--	--	--	--	--	--	--	--	--	--	--	--	--	--	--	--	--	--	--	--	--	--	--	--	--	--	--	--	--	--	--	--	--	--	--	--





## FOSTERING INNOVATION AND GROWTH THROUGH SUSTAINABILITY

### RAI AMSTERDAM VISION 2030 - WE'RE COMMITTED TO HOSTING CLIMATE POSITIVE EVENTS

We are committed to addressing the most pressing global challenges of our time, calling on collaborative partnerships, creative thinking, and innovation to balance the three dimensions of sustainable development - economic growth, environmental sustainability, and social inclusion.

RAI Amsterdam's ambition is to switch to circular economy processes and reduce the overall footprint of the events we organise and facilitate. We integrate sustainability into our business strategy to drive innovation by applying new considerations and solutions that shape the way key resources are used in products, systems, and all processes. Which are characterised by smarter production technologies, reusability, recyclability, material longevity, biodegradability, and reduced CO2 emissions.

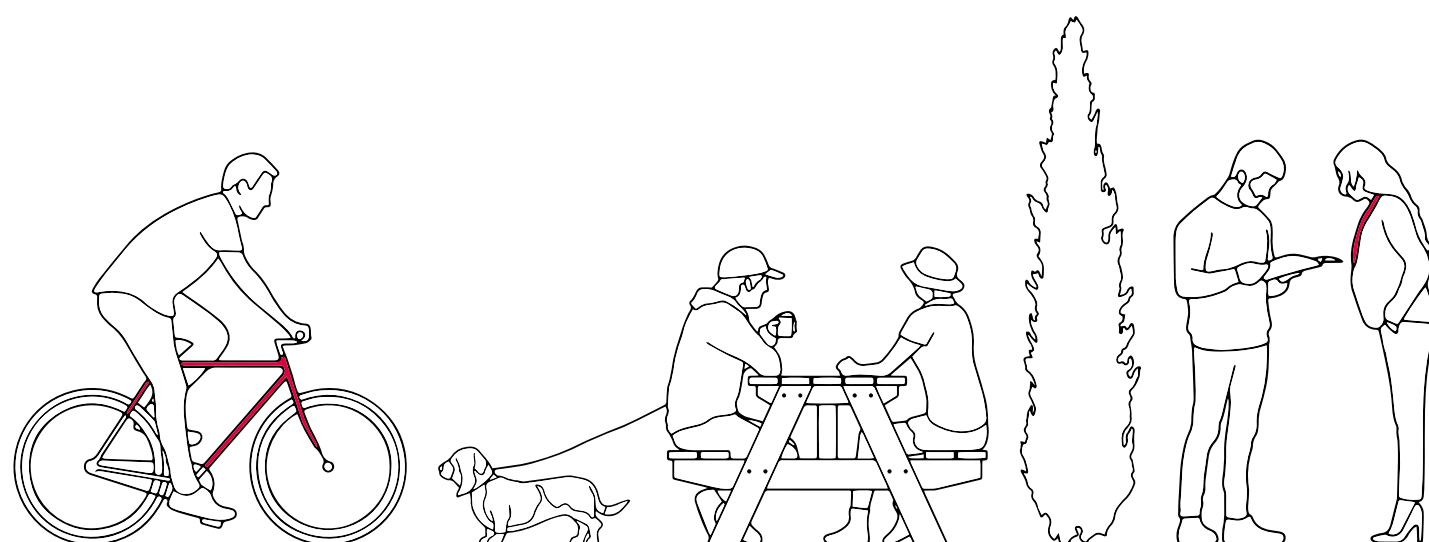

PROMOTING THE CREATION OF EVENTS THAT FOSTER  
SUSTAINABILITY AND POSITIVE ECONOMIC, SOCIAL,  
AND ENVIRONMENTAL DEVELOPMENTS

### RAI VISION 2030

AN ATTRACTIVE INTERNATIONAL MEETING PLACE  
FOR EVERYONE - VISITORS TO TRADE FAIRS/EVENTS  
AND AMSTERDAMMERS

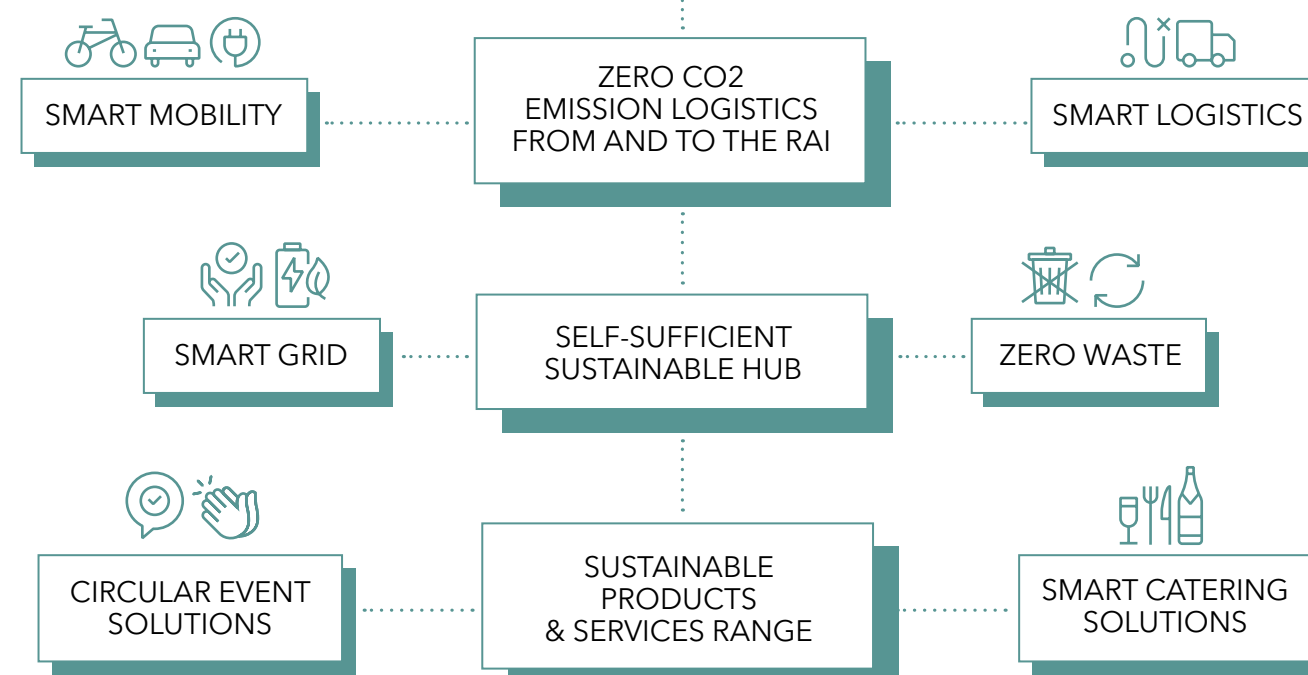

A healthy and  
sustainable event  
environment



The perfect place  
to blend business  
with leisure

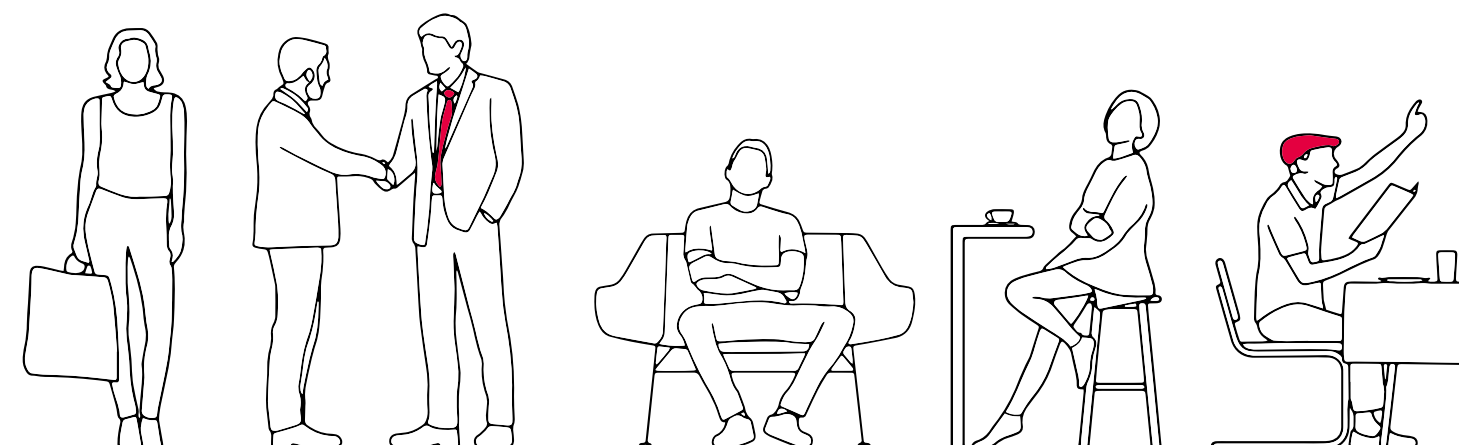





The Elicium - from Elysium, meaning 'a delightful place' - is an iconic part of the RAI. With its characteristic elegant shape Elicium gives the convention centre a bold front design and provides the venue with a striking and flexible location for high profile international events.



 **SMART & HEALTHY**  
CATERING  
CONCEPT





2ND FLOOR  
ENTRANCE C

2ND/3RD/4TH/5TH FLOOR  
ELICIUM

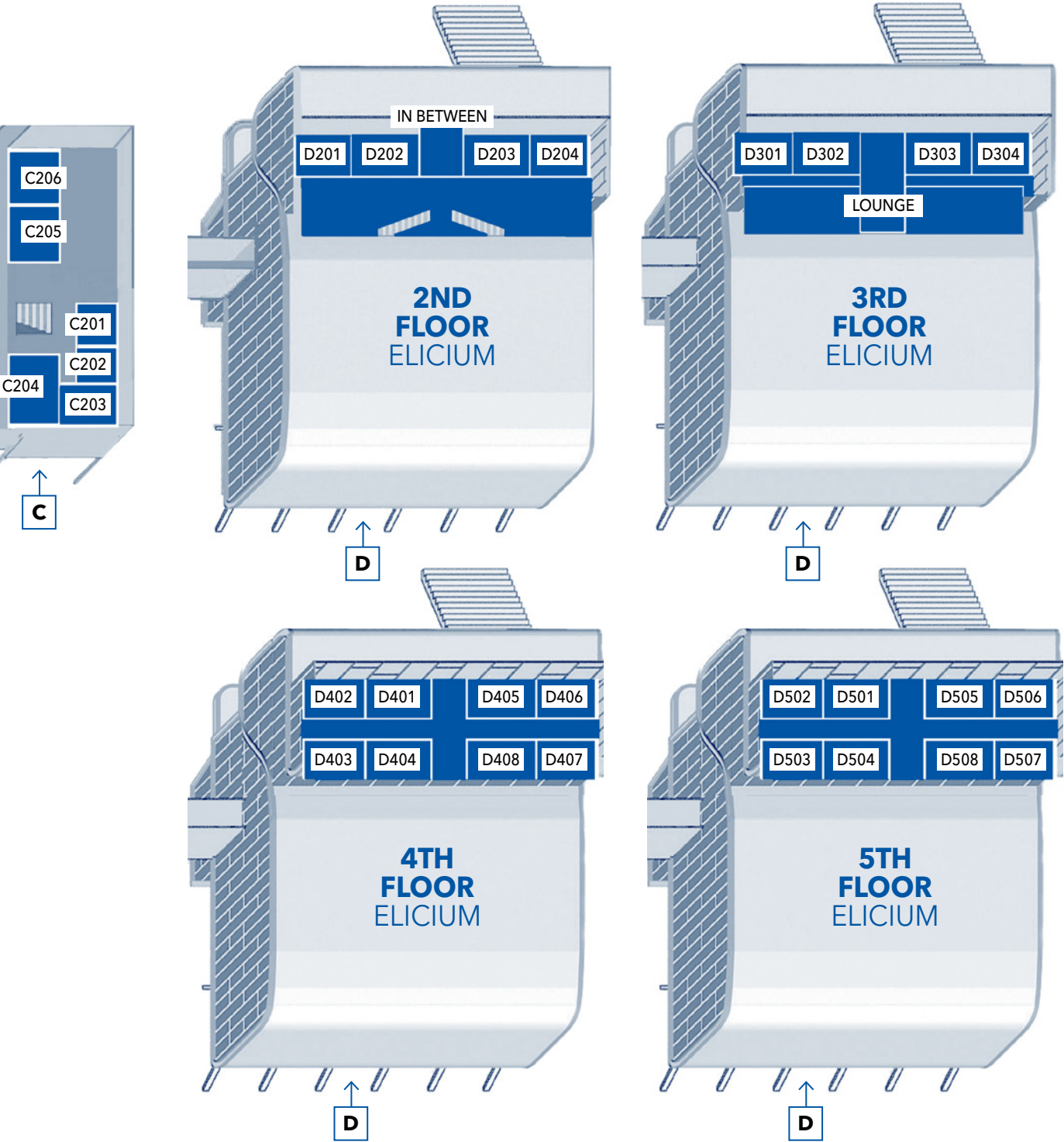

2ND FLOOR ENTRANCE C &  
2ND/3RD/4TH/5TH FLOOR ELICIUM

ENTRANCE C	[M <sup>2</sup> ]	[Sqft]	🏠	🏠	🏠	🏠	🏠	🏠	🏠
C201*	48	517				14			•
C202*	45	484				14			•
C203*	75	807				20			•
C204*	58	624				18			•
C205**	34	366				8			
C206**	40	431				8			

ENTRANCE D - ELICIUM									
D201	105	1,130	94	30	42	22	28		•
D202	105	1,130	98	38	54	22	28		
D201-D202 / D203-D204	210	2,260	198	72	126	54	60	104	•
D203	105	1,130	98	38	54	22	28		
D204	105	1,130	94	30	42	22	28		•
D301	50	538	28	14	24	18	26		•
D302	40	431	20	10	18	10	18		•
D303	40	431	20	10	18	10	18		•
D304	50	538	28	14	24	18	26		•
D401	40	431	20	10	18	10	18		•
D402	50	538	28	14	24	18	26		•
D403	70	753	48	22	39	20	28		•
D404	50	538	35	18	30	16	22		•
D405	40	431	20	10	18	10	18		•
D406	50	538	28	14	24	18	26		•
D407	70	753	48	22	39	20	28		•
D408	50	538	35	18	30	16	22		•
D501*	40	431					11		•
D502	50	538	28	14	24	18	26		•
D503	70	753	48	22	39	20	28		•
D504	50	538	35	18	30	14	22		•
D505*	40	431					11		•
D506	50	538	28	14	24	18	26		•
D507	70	753	48	22	39	20	28		•
D508	50	538	35	18	30	16	22		•
In Between*	30	323					8		

Figures are guidelines, no rights can be derived from these figures. \*Fixed Seating. \*\*Only in combination with halls. • Available







Amtrium includes office spaces, conference rooms and a restaurant with rooftop terrace. A sustainable, multifunctional building, it also includes a greenhouse-like climate zone with plants.

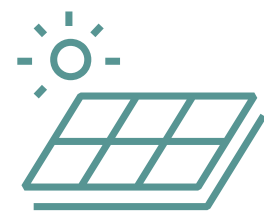

3969  
SOLAR  
PANELS



GROUND & 1ST FLOOR AMTRIUM 1 AND 2

GROUND FLOOR - AMTRIUM	[M²]	[sqft]	🏢	🏢	🏢	🏢	🏢	☀️	☀️
Amtrium 1	275	2,970	305	128	168	48	64		
Amtrium 2	265	2,852	270	128	168	46	60		
Amtrium 1+2	540	5,812	500	194	294	84	108		
Amtrium Lounge	600	6,458							•
Amtrium incl. Lounge	1,140	12,271							•

FIRST FLOOR - AMTRIUM									
L101	32	344	27	8	12	10	16		•
L102	31	333	27	8	12	10	16		•
L103	53	570	56	14	30	14	20		
L104	53	570	61	14	30	14	20		
L103-104	106	1,140	126	36	70	24	36		
Lounge L1	267	2,874							•

RESTAURANT									
Amtrium Restaurant	538	5,791						250	•

Figures are guidelines, no rights can be derived from these figures.

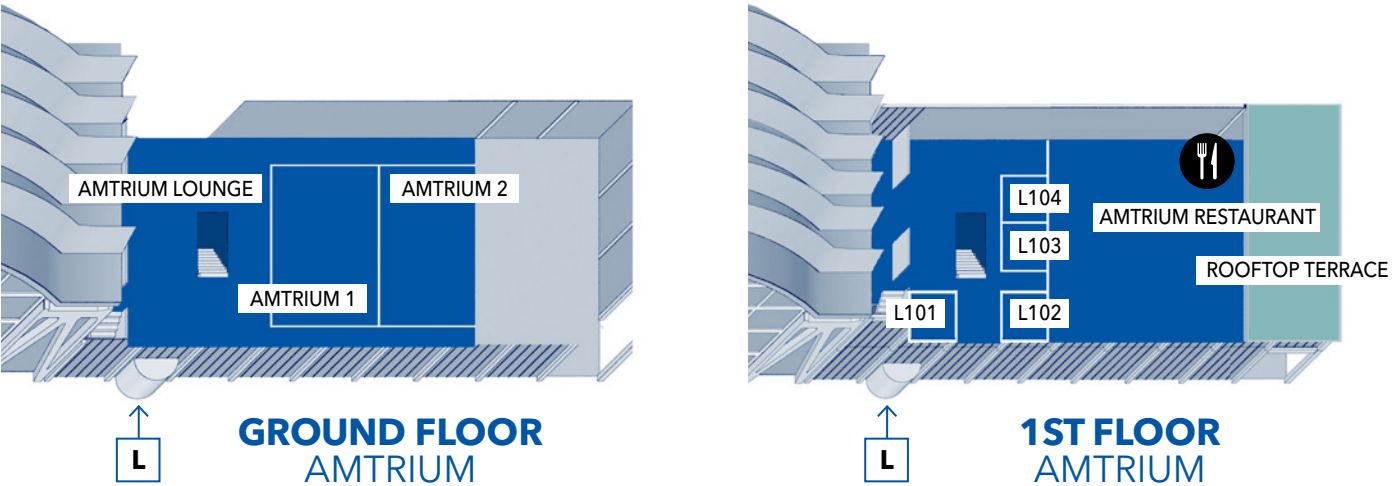





## AN EXCELLENT CHOICE - MAKE YOURSELF AT HOME

Welcome to nhow Amsterdam RAI, a place where contemporary art, design, gastronomy and cultural expression come together. Located next to RAI Amsterdam, the building is a city landmark with its iconic architecture, 91 metres in height and its 650 rooms on 25 floors. All rooms have great views of the surrounding cityscape. The roof terrace on the 17th floor offers breathtaking panoramic views of Amsterdam. For (inter)national organisers, exhibitors and visitors this is the perfect home base.



The hotel boasts a  
**BREEAM Excellent**  
certification





## MIXING BUSINESS WITH LEISURE

Let us take you on a tour of our venue to discover a hidden gem. Tucked away in a quiet spot just behind the RAI, you will find Strandzuid, an urban harbour and a genuine urban beach. The place consists of a restaurant and an amazing floating terrace on the water. The relaxed atmosphere makes it the ideal place to relax and have a drink... with your feet in the sand.



Strandzuid is  
daily open for lunch,  
drinks or dinner







**BEAUTIFULLY  
LOCATED  
IN AMSTERDAM**

## RAI AMSTERDAM IS EASY ACCESSIBLE BY METRO, TRAM, TRAIN AND ROAD.

A direct train line connects Schiphol International Airport to RAI in just 15 minutes. From our doorstep, the metro will take you to the vibrant city centre in only 6 minutes. From Amsterdam Central Station you will enjoy the convenience of direct connections to and from every major European city. RAI Amsterdam is also ideally located for visiting by car, situated just off the A10 south ring road – exit 9 leads directly to our venue and our 4,500 car parking spaces.

Welcome home. Discover our house.

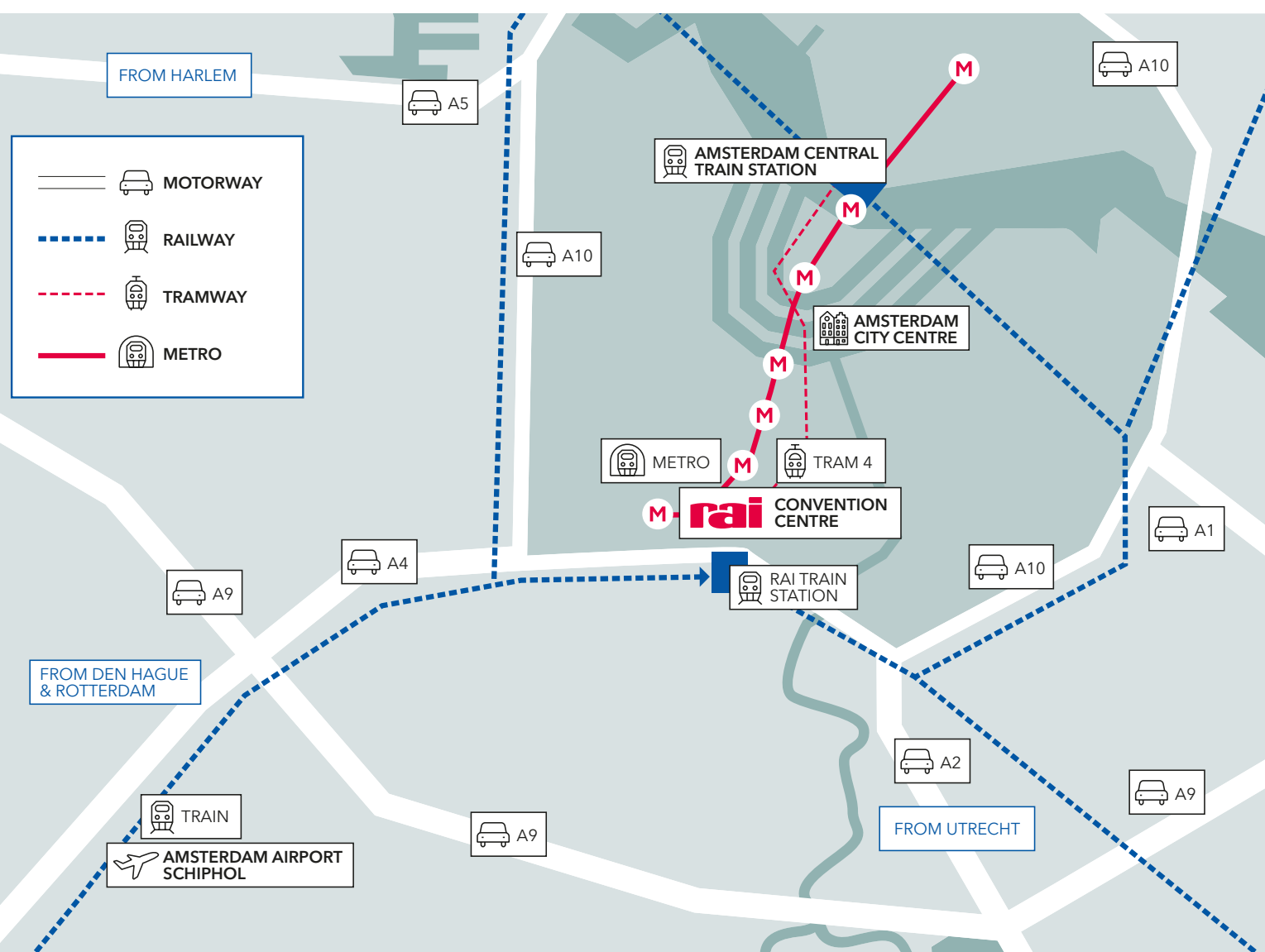

THIS BROCHURE IS PRINTED  
ON RESPONSIBLE FSC PAPER



#04  
/24

# HOUSE OF EVENTS HOME OF YOUR INDUSTRY



**rai**  
AMSTERDAM

**Our house is your home**  
Please feel free to contact us at  
+31 (0)20 549 17 22  
[raimarketing@rai.nl](mailto:raimarketing@rai.nl)  
[www.raai.nl](http://www.raai.nl)